



PROLANCE®

transparency & accuracy



PROLANCE® SAFETY LANCETS

Sterile, single-use medical
devices intended
for capillary blood sampling

Product intended use

Prolance[®] safety lancets are sterile, single-use medical devices intended for capillary blood sampling. Intended users are healthcare professionals.

Product Features

Transparency

Transparent lancet body to see the spring action for ensured puncture

Ergonomic t-shape with extra ribs for a firm grip

Original design thanks to a transparent lancet body

Accuracy

Comfortable finger recess for push-button activation

Handy shape and no slippery lancet surface

Ribbed protective cap guarantees needle sterility and gives a secure grip

Easy twist-off removal



Sharps injuries expose healthcare workers to blood-borne pathogens. The Centers for Disease Control and Prevention (CDC) estimates that about 385,000 sharps-related injuries occur annually among healthcare workers in hospitals.

It has been estimated that about half or more of sharps injuries go unreported. Most reported sharps injuries involve nurses, but laboratory workers, physicians, housekeepers, medical students and other healthcare workers are also exposed to injuries.

Sharp injuries can occur before, during or even after use of a sharp and continue to be a serious health and safety hazard.

Sharps injury - facts

“Over 80% of needlestick injuries can be prevented with the use of safer needle devices, which, in conjunction with worker education and work practice controls, can reduce injuries by over 90%!*”

HTL-STREFA is committed to manufacturing safety products designed to reduce or eliminate the risk of exposure to blood-borne pathogens.

Safety lancets, including **Prolance**[®], are an integral component to the sharps injury prevention programs in hospitals, clinics, laboratories, doctor's offices and wherever both patients and professionals need to feel safe.

By using safety lancets needlestick injuries and infections can be minimized.

**The WHO estimates based on CDC Report*

How to use Prolance[®]:

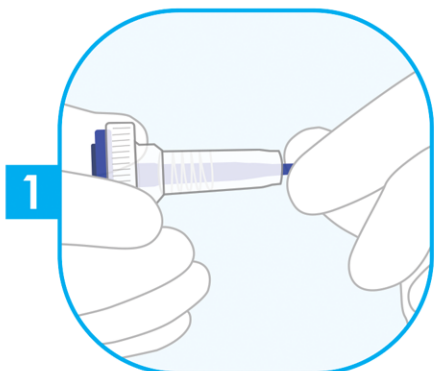

1 Twist off the protective cap and pull it straight out.

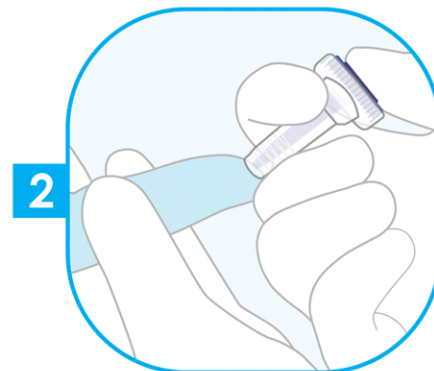

2 Press the **Prolance**[®] body firmly against the puncture site and push the button to activate the device.

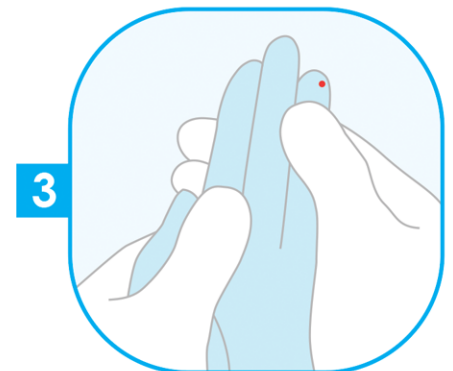

3 Gently apply intermittent pressure near the puncture site to obtain the required blood volume. Discard the used lancet into a sharps container in accordance with facility guidelines and local regulations.

Prolance® is sterile, single-use, push button activated safety lancet intended for capillary blood sampling.

Available in six versions:

	Product version	Needle gauge/blade	Penetration depth
	Prolance® Micro Flow	28G needle	1.6 mm
	Prolance® Low Flow	25G needle	1.4 mm
	Prolance® Normal Flow	21G needle	1.8 mm
	Prolance® High Flow	18G needle	1.8 mm
	Prolance® Max Flow	blade	1.6 mm
	Prolance® Pediatric Flow	blade	1.2 mm

References:

Directions for safety lancets development based on nurses' needs; Poland, June 2016, HTL-STREFA S.A. data on file
<https://www.osha.gov/needlesticks/needlefaq.html>
 Mary Foley, MS, RN, Annemarie T. Leyden, EdD, RN; American Nurses Association – Independent Study
 Module Needlestick Safety and Prevention; http://www.who.int/occupational_health/activities/1anaism.pdf

Poland



HTL-STREFA S.A.
 ul. Adamówek 7
 95-035 Ozorków
 info@htl-strefa.pl
 www.htl-strefa.com



Find us on Facebook
www.facebook.com/HTLSTREFA

USA

HTL-STREFA, Inc.
 3005 Chastain Meadows Pkwy
 Suite 300
 Marietta, GA 30066

+1 770 528 0410
 info@htl-strefa.com
 www.htl-strefa.com



430/ALL/11/2017
 Made in Poland



CE mark refers to the product
 not to the brochure