

## 36" Wall Cabinet

### 8336 Wall Cabinet

- Wall cabinet with 2 doors and 1 adjustable shelf
- Durable, easy-clean, thermofoil surfaces
- No front facing seams
- Unit is pre-assembled to save installation time
- Cabinet easily mounts with hook and rail mounting system
- Fully adjustable, concealed, soft-close hinges
- Smart looking, easy-clean, satin chrome pulls
- Choose from 4 contemporary finishes

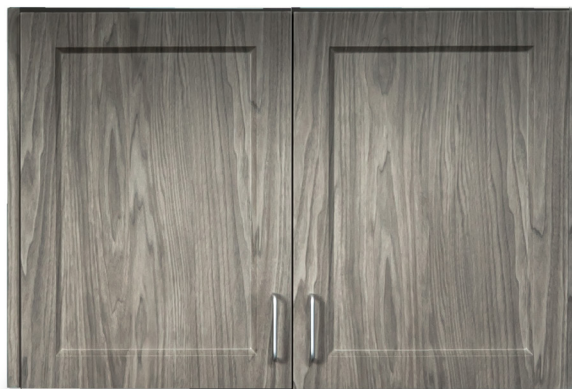

*fashionfinish*  
CASEWORK BY CLINTON



#### 8336 SPECIFICATIONS

36" W x 12" D x 24" H

California residents please be advised of the following, pursuant to Proposition 65:

**!** **WARNING:** This product can expose you to chemicals, including chromium, which is known to the State of California to cause cancer or reproductive toxicity. For more information go to [www.P65Warnings.ca.gov](http://www.P65Warnings.ca.gov).

### Options



066 Door Lock & Latch Combo

### Finishes



Chestnut Hill



Twilight



Arctic White



Metropolis Gray