

Installation and Use Instructions

TL-3004SYSR2 DepartAlert™ Double Door Anti-Wandering System

- Simple Installation
- No Hard Wiring

TL-3004SYSR1 DepartAlert™ Anti-Wandering System

IMPORTANT INFORMATION: DepartAlert™ anti-wandering system relies on wireless technology which is subject to physical and environmental considerations. These products do not have an out of range function and as such should be tested periodically in the setting in which they are to be used to understand their area of effective operation. Please be aware that the transmitter will not be 100% accurate if it is out of range at anytime. It is the end-user's responsibility to make sure that the product is used correctly and within range of each other. Wireless systems and monitors are intended as an adjunct to good caregiving practices and are not a substitute for proper staffing and patient management practices. We recommend that all personnel receive periodic training in the operation of these systems and that the systems are tested before each use. It is important to read and follow the directions.

WARNING: Failure to comply with the warning may result in injury or death. This device is not suitable for all individuals. Other devices may be required. This device is not a substitute for visual monitoring by a caregiver. The manufacturer does not claim that this device will stop elopement and/or stop falls. This device is designed to augment caregivers' comprehensive resident mobility management program. **Test this device before each use. Read the instructions and Legal Disclaimer.**

The Smart Caregiver Corporation TL-3004SYSR2 is designed to be installed by the end user. As such, it is the entire responsibility of the buyer to insure that the system is properly installed and tested. Further, the system is not designed to replace good caregiving practices including, but not limited to:

- A.) Direct patient supervision B.) Adequate training for staff personnel for elopement C.) Testing of the system before each use**

WHERE PERMISSIBLE, IT IS THE SELLER'S INTENT TO LIMIT ANY LIABILITY FOR SPECIAL, CONSEQUENTIAL OR INCIDENTAL ECONOMIC DAMAGES TO REFUND OF THE PURCHASE PRICE OR REPLACEMENT OF THE GOODS. SELLER DISCLAIMS ANY LIABILITY FOR COMPENSATORY OR OTHER DAMAGES ARISING OUT OF THE USE OF THE GOODS.

WARNING: The manufacturer does not claim that this device will stop elopement and/or stop falls. This device is designed to augment caregivers' comprehensive resident mobility management program. This product is to be used by a licensed caregiver only.

Limited Warranty: Seller warrants that the goods sold will be free from defects of workmanship and manufacturing, for a period of one year from the date of sale. Other than this limited warranty, seller makes no express or implied warranties. Except for this limited warranty, NO EXPRESS OR IMPLIED WARRANTIES ARE GIVEN AND NO AFFIRMATION OF SELLER, BY WORDS OR ACTION, WILL CONSTITUTE A WARRANTY. THE GOODS BEING PURCHASED ARE BEING SOLD ON A "WITH ALL FAULTS" BASIS. THE ENTIRE RISK AS TO THE QUALITY AND PERFORMANCE OF THE GOODS IS WITH THE BUYER. SHOULD THE GOODS PROVE DEFECTIVE FOLLOWING THEIR PURCHASE, THE BUYER, AND NOT THE MANUFACTURER, DISTRIBUTOR OR RETAILER, ASSUMES THE ENTIRE COST OF ALL NECESSARY INSTALLATION, SERVICING OR REPAIRS.

TL-3004SYSR2 DepartAlert™ Double Door Anti-Wandering System

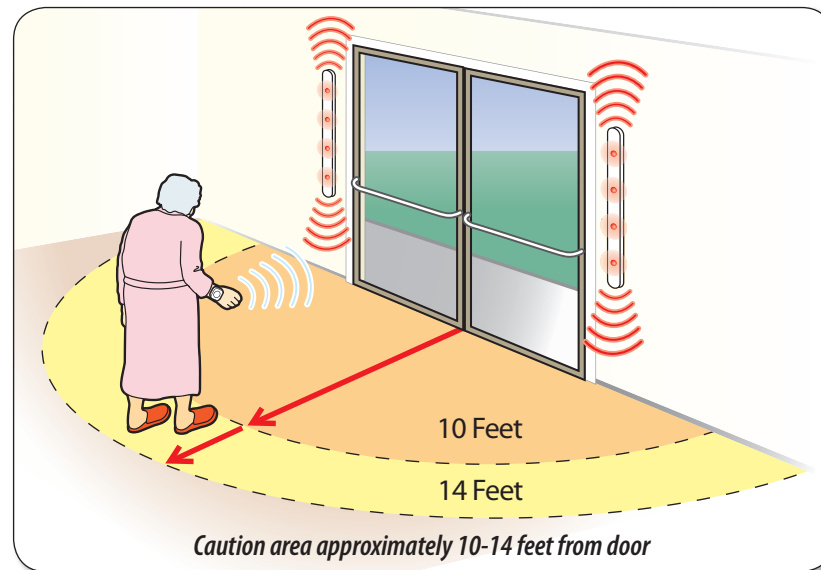

About The DepartAlert™ Anti-Wandering System:

The DepartAlert™ Anti-Wandering System projects a sensor field and alarms visually and audibly when a resident wearing a wristband transmitter passes within the sensor field's range. The door monitor can be configured for use with a Central Monitoring Unit that will identify which specific resident or doorway triggered the alert and works with up to 999 residents.

TL-3004SYSR2 CONTENTS:

- 2 Door Alarm Bars (TL-3004)
- 1 Resident Wristband Transmitter (TL-2012SREV)
- 1 Caregiver Key (CK-01D)
- 1 AC Power Adapter (AC-03)
- 2 Magnetic Contact Switches (TL-2024)
- 2 Double Sided Tape Strips
- Wall Mount Reset Button (TL-2014W)

TL-3004SYSR2 OPTIONAL ACCESSORIES (SOLD SEPARATELY):

- Door Alarm Reset/Tester & Wristband Tester (DT-01)
- Central Monitoring Unit (TL-2015R2)
- Magnetic Door Lock (TL-2025)
- Emergency Call Alarm Light (2007-ECA-R1)

To meet industry standards, door bars and wristbands should be tested at regular intervals to assure proper functionality. A standard procedure should be initiated at the facility for this testing. It is recommended that a tester be purchased for all facilities using SMART Anti-Wandering Door Systems.

Need Set-up Help? (800) 650-3637



SMART CAREGIVER CORPORATION

1229 North McDowell Blvd., Petaluma, CA. 94954 | Tel: 800-650-3637

sales@smartcaregiver.com | www.smartcaregiver.com

Quick Start Instructions

Need Set-up Help? (800) 650-3637

TL-3004SYSR2

1 Mount Door Monitor to Wall

- A** Peel off yellow backing from adhesives (3) on the back of the door monitors. The door bar should be mounted to clean, smooth surfaces.



- B** Adhere the door bars vertically on the outside of either door frame with cords facing up or down (in direction of power source).

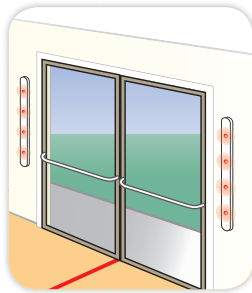

Warning: If mounting door monitor near metal frame, mount at least 8" away from metal frame.

2 Plug in AC Adapter

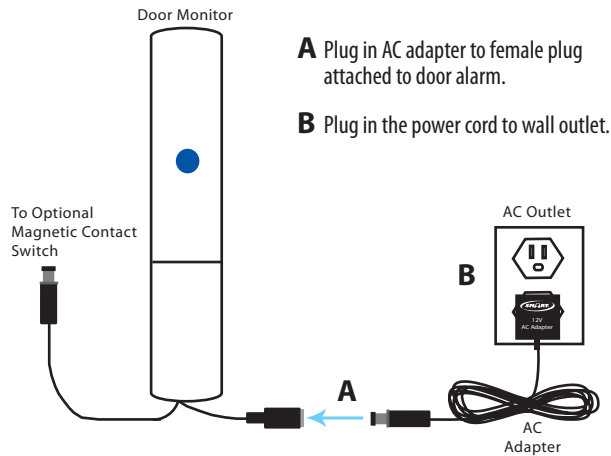

Note: Alarm will illuminate and beep to indicate system is functioning.

3 Activate Resident Wristband Transmitter(s)

- A** Place the orange magnet on the face of the white transmitter in the lower right hand corner and hold down.
- B** The Transmitter will blink 3 times indicating that the transmitter has been activated.

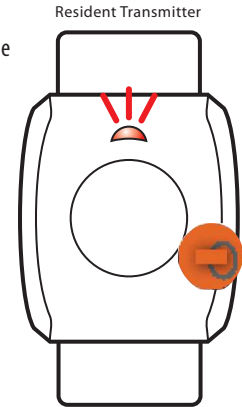

Warning: Transmitter bands are not to be placed on a wheelchair, walker or near jewelry. The correct placement is the resident's wrist. This transmitter is battery operated and the life of the battery is based on usage. (See TL-2012 instructions for further information.)

4 Test the System

- A** Test the active range of the door monitor by approaching the door with resident transmitter activated from all different directions, making sure that the alarm goes off from desired distances.

- B** To silence the alarm, place the orange magnet over the blue sticker on the door monitor.

Orange Magnet



- C** To retest, wait approx. 20 seconds for monitor to blink (single light) before system is ready.

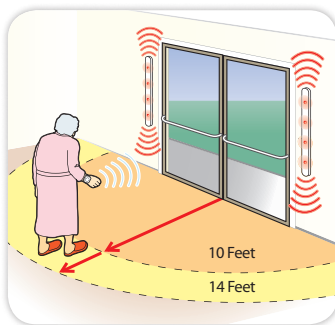

- D** Attach the wristband transmitter to the resident's wrist with the included strap.

Warning: If the door monitor alarms when a transmitter is too close or too far from the door, or if you can pass through the door, call for technical assistance.

5 (Optional) Mount Magnetic Contact Switch

WHEN USING THE MAGNETIC SWITCH, THE ALARM WILL ONLY SOUND WHEN DOOR IS OPENED AND IF A RESIDENT WEARING A WRISTBAND IS WITHIN THE MONITORED FIELD.

- A** Screw magnetic contacts (see below) to underside of door frame above each door with wording facing open door. Lead cord along the outside of the door frame.



- B** Screw door magnets (see below) to door with arrow facing up.



- C** Magnetic contact and magnet must align perfectly to function.

- D** Plug in magnetic contact switch to male plug attached to door alarm.

6 Test the System with Magnetic Contact Switch

- A** Test the door monitor with the magnetic contact switch installed by opening the door with an activated resident transmitter in hand. Door monitor will sound when door is opened.

- B** To silence alarm, place the orange magnet over the blue sticker on the door monitor.

Orange Magnet



- C** To retest, wait approx. 20 seconds for monitor to blink (single light) before system is ready.

- D** Attach the wristband transmitter to resident's wrist with included strap.



Warning: Door monitor will sound if door is opened and a resident wearing a transmitter is within 10-14 feet from door monitor. If door monitor goes off when transmitter is too close or too far from door or if you can pass thru door, call for technical assistance.



SMART CAREGIVER CORPORATION

Tel: 800-650-3637

| www.smartcaregiver.com