

TECHNICAL DATA SHEET Disposable Tongue Depressor

Intended Use

Tongue depressors are used to gently bear down and hold tongue in place for patient oral examination.

Characteristic	Specification			
Material Composition	Tongue Depressor	100% Birch Wood, latex-free.		
		Surface: FDA Grade, Edible Wax providing a smooth finish to the surface		
Dimension	Size	Radius (r)		
	Standard (6")	0.350"		
	Junior (5.5")	0.313"		
	Infant (4.5")	0.187"		
Description	Thin wooden blade smoothed and rounded at both ends			
Color	Tan with natural yellow or reddish, brown tints			
Dimension	Size	Length (L)	Width (W)	Thickness (T)
	Standard (6")	5.9"	0.69"	0.062"
	Junior (5.5")	5.5"	0.63"	
	Infant (4.5")	4.5"	0.38"	0.078"

Measurement Diagram

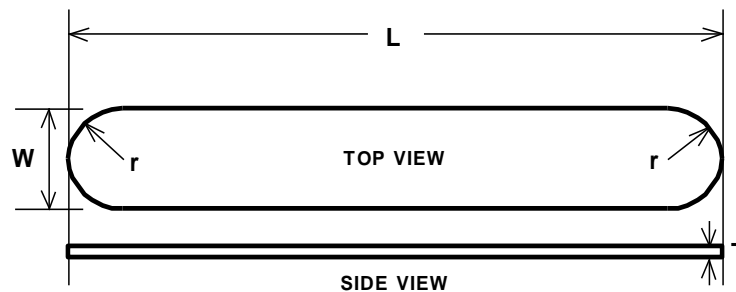

Visual



Additional Information

Regulatory	Storage Condition	Country of Origin
FDA Class 1 Health Canada Class 1	Store in a cool dry place	China

Appendix 1 List of Item Codes and Attributes

Appendix 1 (List of items)

AMD Medicom Inc.

Item Code	Description	Packaging Information	Size	Treatment
50000	AMD Ritmed Solon Tongue Depressors	500 Tongue Depressors/Box, 10 Boxes/Case, 5000 Depressors/Case	Junior (5.5")	Non-Sterile
51100	AMD Ritmed Solon Tongue Depressors	1000 Tongue Depressors/Box, 10 Boxes/Case, 10000 Depressors/Case	Infant (4.5")	Non-Sterile
52000	AMD Ritmed Solon Tongue Depressors	500 Tongue Depressors/Box, 10 Boxes/Case, 5000 Depressors/Case	Standard (6")	Non-Sterile
52100	AMD Ritmed Solon Tongue Depressors	100 Tongue Depressors/Box, 12 Boxes/Case, 1200 Depressors/Case	Standard (6")	Non-Sterile
55600	AMD Ritmed Solon Tongue Depressors	1 Tongue Depressor/ Pouch, 250 Pouches/Box, 10 Boxes/Case, 2500 Depressors/Case	Standard (6")	Non-Sterile
58000	AMD Ritmed Solon Tongue Depressors	1 Tongue Depressor/Pouch, 100 Pouches/Box, 10 Boxes/Case, 1000 Depressors/Case	Infant (4.5")	Sterile