

**PROVIDES SUPPORT &
PREVENTS FALLS.**



**REDUCE CAREGIVER
BACK INJURIES.**

9505 Series
Gait Belt W/Quick-Release Buckle

HOW TO APPLY A GAIT BELT

1

Place the belt around patient's waist with the tag facing outward and the buckle centered.

2

Thread the metal-tipped end through the inner plastic loop and tighten.

3

Thread the metal-tipped end through the outer loop and tighten.

4

Pull tight at each end of the webbing to ensure the belt is secure.

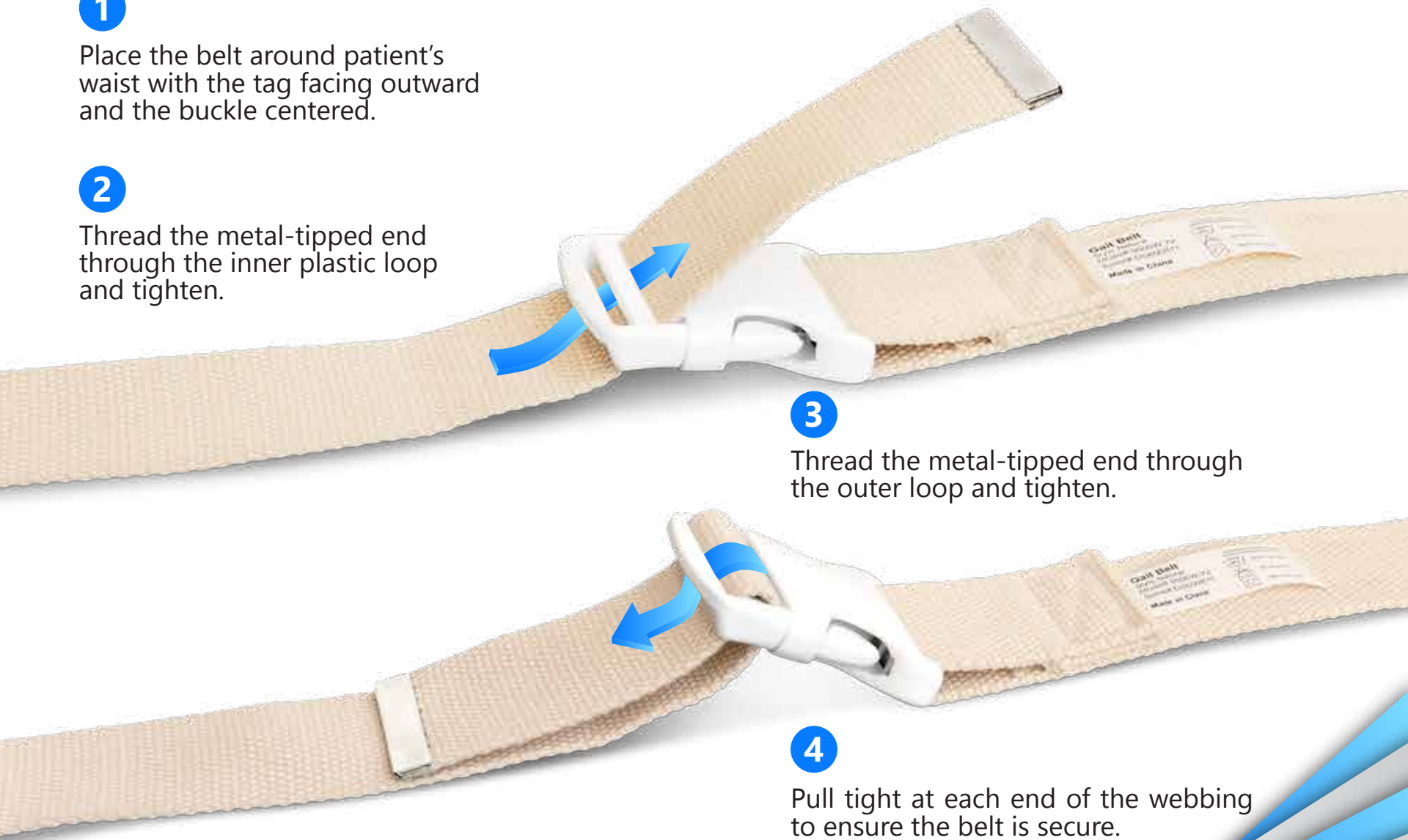

SIZE GUIDE

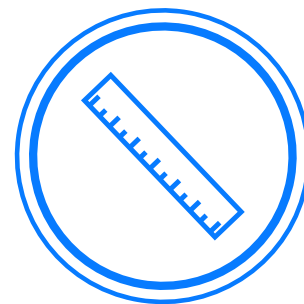

SIZE **FITS UP TO**

S

54"

M

60"

L

72"

HOW TO CHOOSE YOUR SIZE

Using a soft tape, measure the circumference around the widest part of your body where you plan to wear the gait belt.





MACHINE WASHABLE

Wash lukewarm and dry on low to maintain pristine condition.

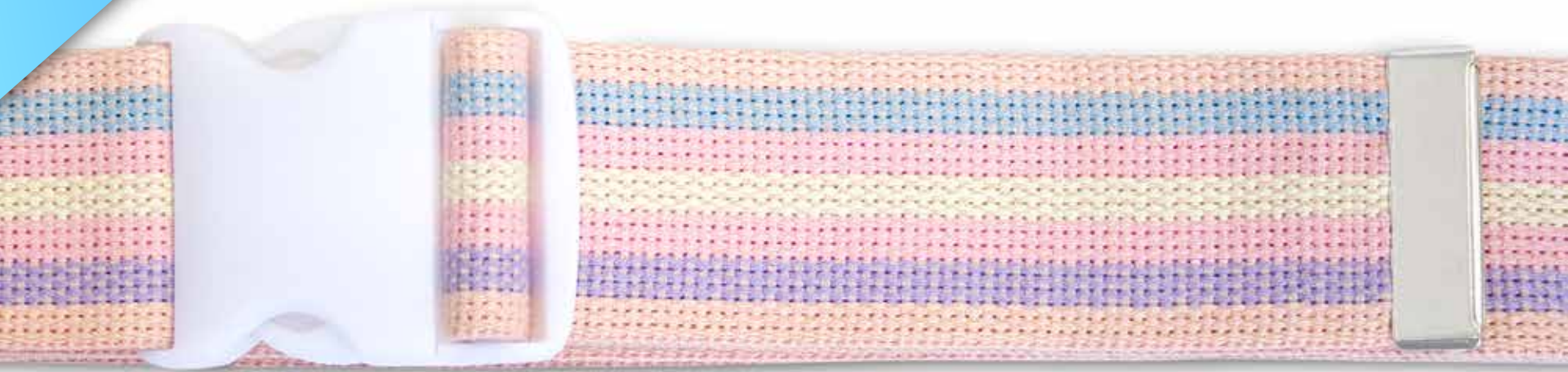



QUICK-RELEASE BUCKLE

Easy-on, easy-off dependable plastic buckle.