

BSN medical Orthopedics Catalog

Fracture Management, Orthopedic Soft Goods & Physiotherapy



Your full solution provider
for all your non-invasive
orthopedic needs across
the continuum of care

BSN medical is the full solution provider for all of your noninvasive orthopedic needs from acute to rehab. We offer market-leading brands, training and service allowing you to provide better patient care across the continuum.



Exceeding Your Expectations For Quality and Durability

Thank you for dispensing the finest in orthopedic soft goods and braces. If any FLA Orthopedics® product fails to exceed your expectations for quality and durability, simply return it to us and we guarantee to do our best to make it right.

www.flaorthopedics.com

The coding, coverage, and payment information contained herein is gathered from various resources and is subject to change without notice. BSN Medical, Inc. cannot guarantee success in obtaining third-party insurance payments. Third-party payment for medical products and services is affected by numerous factors. It is always the provider's responsibility to determine and submit appropriate codes, charges, and modifiers for services that are rendered. Providers should contact their third-party payers for specific information on their coding, coverage, and payment policies.

This document includes codes that might be used to bill for BSN Medical products and related services. Each provider will have to verify the appropriate codes for each patient. It is the provider's sole responsibility to determine and submit appropriate codes, charges, and modifiers for services rendered. Providers should contact insurers to verify correct coding procedures prior to submitting claims related to any product or service. BSN Medical, Inc. cannot guarantee coverage or reimbursement with the codes listed in this billing guide. In all cases, providers will need to follow local payer policies for billing and reimbursement.

Table of Contents

PRODUCT	PAGE		
Synthetic Splinting			
ORTHO-GLASS® Comfort	7	Terry-Net™ C Cotton Terry Cloth Stockinette	38
ORTHO-GLASS® Splinting System	8	Terry-Net™ S Synthetic Terry Cloth Stockinette	38
SafetySplint™ Unpadded Roll	9	Terry-Net™ Thumb Spica Precut Synthetic Terry Cloth Stockinette	39
SafetySplint™ Precuts	9	Delta Terry-Net™ Adhesive Fleece Edger	39
ORTHO-GLASS® Unpadded Precut Splinting System	10	Delta Terry-Net™ Adhesive Hook & Stretch Loop Closures	40
ORTHO-GLASS® Solo	10	Cast Removal & Accessories	
ORTHO-GLASS® Strap Kits	11	FCT Starter Kit Featuring Delta-Cast® Conformable	41
ORTHO-GLASS® Ankle Treatment System	11	FCT Accessories Kit	42
Delta-Splint®	12	Delta-Cast® Saw	42
Dynacast® S	12	Delta-Cast® Vacuum	42
Delta-Xpress™ Prefabricated Splint	13	American Orthopedic™ Cast Cutter Cast Saws	43
Plaster of Paris		American Orthopedic™ Cast Dust Vacuum & Portable Vacuum	43
OCL® Splint Roll - 2 Plaster Splinting System	14	Cast Saw Blades	44
Specialist® J-Splint® Plaster Roll Immobilizer	14	BSN Buckets	45
Plaster Roll Immobilizer Dispenser	13	Knee Rest	45
Gypsona® Endless Slab Dispenser Pack	15	Zip Stick Cast Removal Aid	45
Specialist® Plaster of Paris Bandages & Splints	16	Casting Instruments	46
Orthoflex® Elastic Plaster of Paris Bandages	16	Neck and Cervical	
Gypsona® S Plaster of Paris Bandages & Splints	17	Miami J® Cervical Collar	48
Gypsona® HP Plaster of Paris Bandages & Splints	17	Miami JTO® Thoracic Extension	48
OCL® Plaster of Paris Bandages & Splints	18	Actimove® Vertebrace® Extrication Collar	49
Synthetic Cast Tape		Philadelphia® Collar	49
Delta-Lite® Conformable Fiberglass Cast Tape	20	FLA Universal Cervical Collar	50
Delta-Lite® Plus Fiberglass Cast Tape	21	FLA Sized Cervical Collar	50
Delta-Cast® Conformable Polyester Cast Tape	22	Arm, Shoulder and Clavicle	
Functional Cast Therapy	23	FLA Sling & Swathe Shoulder Immobilizer	51
Delta Cast® Elite Rigid Polyester Cast Tape	24	Actimove® Eco Shoulder Immobilizer	51
Delta-Cast® Prints Printed Polyester Cast Tape	25	Actimove® Sling on a Roll	52
Delta-Cast® Soft Semi-Rigid Cast Tape	26	FLA Deluxe Clavicle Support	52
Orthopedic Padding		FLA Posture Control Shoulder Brace	53
Delta-Dry® Water Resistant Cast Padding	28	FLA Safe-T-Sport® Neoprene Shoulder Support	53
Delta-Dry® Stockinette	28	Actimove® Comfort Arm Sling	54
Delta-Dry® Softliner	28	Actimove® Eco Arm Sling	54
Delta-Rol® Synthetic Cast Padding	29	FLA Universal Cradle Arm Sling	55
Specialist® Cotton Blend Cast Padding	29	FLA Cradle Arm Sling	55
Specialist® 100 Cotton Cast Padding	30	FLA ProLite® Universal Arm Sling	56
Sof-Rol® Absorbent Cast Padding	30	Wrist	
Sterile Paddings		FLA Perforated Suede Finish Wrist & Forearm Splint	57
- Specialist®	31	FLA Airflow 8" Wrist Brace	57
- Specialist® 100	31	FLA ProLite® 6" Low Profile Wrist Splint	58
- Sof-Rol®	32	FLA Soft Fit® Suede Finish Cock Up Wrist Brace	58
- Delta-Rol®	32	FLA ProLite® 8" Wrist Splint	59
Protouch® Natural Cast Padding	33	FLA Uni-Fit® Universal Wrist Splint	59
Protouch® Synthetic Cast Padding	33	FLA HealWell® Grip Splint WHFO Wrist / Hand / Finger Orthosis	60
Delta Terry-Net™ Adhesive Terry Cloth / Foam Padding	34	FLA CarpalMate® Wrist Support	60
Delta Terry-Net™ Adhesive Felt Padding	34	FLA SoftForm® Elegant Wrist Support	61
Sifoam™ Adhesive Backed Interface Padding	34	FLA Elastic 6" Wrist Brace	61
Orthopedic Stockinette		FLA Neoprene Wrist Wrap	62
Delta-Net® Orthopedic Synthetic Stockinette	36	FLA Elastic Pullover Wristlet	62
Specialist® Orthopedic Cotton Stockinette	36		
Protouch® Cotton Stockinette	37		
Protouch® Synthetic Stockinette	37		

Table of Contents

PRODUCT	PAGE		
Thumb & Finger		Calf / Thigh	
FLA Airflow 8" Wrist Brace with Abducted Thumb	63	FLA 3D Thigh Support	91
FLA C3™ Deluxe Thumb Splint	63	FLA 3D Calf Support	91
FLA Soft Fit Thumb Spica	64	FLA EZ-ON® Thigh Wrap Support	91
FLA ProLite® Wrist Splint with Abducted Thumb	64	Ankle	
FLA Tether® Thumb Stabilizer	65	FLA Ankle Walker	92
FLA ProLite® Neoprene Pull-On Thumb Support	65	FLA Adjustable Air Ankle Walker	92
Elbow		FLA Easy Air™ Pneumatic Stirrup Ankle Brace	93
FLA GelBand® Arm Band	66	FLA Easy Air™ Pneumatic Stirrup Ankle Brace with Gel	93
FLA Epi-Sport® Epicondylitis Clasp	66	FLA Ankle Stirrup Brace with Air Liners	94
FLA Canvas Tennis Elbow Strap	67	FLA FlexLite® Sport Articulating Hinged Ankle Brace	94
FLA ProLite® Elbow Support Knitted Pullover	67	Swede-O® InnerLOK 8™ Ankle Brace	95
FLA ProLite® Compressive Elbow Support with Viscoelastic Insert	68	McDavid® Ankle Guard with Optional Plastic Inserts	95
FLA Elastic Pullover Elbow Support	68	FLA Canvas Lace-Up Ankle Brace	96
FLA Neoprene Elbow Sleeve with Loop Lock	69	FLA 3D Ankle Support	96
Rib and Abdomen		FLA EZ-ON® Wrap-Around Ankle Support	97
FLA Premium Two-Panel Surgical Rib Belts	70	FLA Safe-T-Sport® Neoprene Ankle Support	98
FLA Premium Three & Four-Panel Abdominal Binders	70	FLA Pullover Elastic Ankle	98
Lumbar		FLA ProLite® Ankle Support Knitted Pullover	99
FLA LO•Plus™ Lumbar Support with Stabilizing Posterior Panel	71	FLA 3D Achilles Tendon Support	99
FLA Deluxe Lumbar Support 11" Height	71	Foot / Ankle	
FLA 9" Neoprene Lumbar Sacral Support	72	FLA HealWell® Cub™ Plantar Fasciitis Night Splint	100
FLA 7" Cool-Lightweight Lumbar Sacral Support	72	FLA HealWell® Plantar Fasciitis Night Splint	101
FLA Lumbar Sacral Support with Overlapping Abdominal Belt, 10" Height	73	FLA HealWell® Multi-AFO/Contracture Splint	102
FLA Sacral Iliac Support with Compression Pad 6" Height	73	FLA HealWell® Soft Ease™ Multi-AFO / Heel Suspender	103
FLA Thermal Lumbar Support	74	FLA Ankle Foot Orthosis/Foot Drop Splint	104
Knee		FLA HealWell® AFO Night Wrap	105
FLA Breathable Universal Tri-Panel Knee Immobilizer	75	Pediatric	
FLA Breathable Universal Cutaway Knee Immobilizer	75	FLA Pediatrics Introduction	106
FLA Specter® ROM Standard	76	FLA Elastic Shoulder Immobilizer	107
FLA Specter® ROM Cool/Lightweight	76	FLA Wrist Splint	107
FLA Specter® ROM Short	76	FLA Knee Immobilizer	108
FLA Adjustable ROM Knee Brace	77	FLA Cervical Collar	108
FLA Airflow Wrap-Around Hinged Knee Brace	78	FLA Clavicle Support	109
FLA Safe-T-Sport® Wrap-Around Hinged Knee Brace	78	FLA Universal Arm Sling	109
FLA Neoprene Patella Stabilizer with Removable Horseshoe	79	FLA Neoprene Patella Stabilizer	110
FLA Lateral Knee Stabilizer with "J" Shaped Buttress	80	FLA Neoprene Elbow Sleeve	110
FLA SoftForm® Wrap-Around Stabilizing Knee Support	81	FLA Neoprene Knee Sleeve	111
FLA OA / Arthritis Knee Brace	82	FLA Neoprene Ankle Support	111
FLA Safe-T-Sport® Neoprene Hinged Knee Stabilizing Brace	83	FLA Canvas Rocker Bottom Cast Shoe	112
FLA Safe-T-Sport® Neoprene Hinged Knee Stabilizing Brace with Composite Hinges	84	Post-Op & Cast Shoes	
FLA FlexLite® Cool Walking Knee Hinged Knee Support	85	FLA Canvas Rocker Bottom Cast Shoe	113
FLA PowerCentric® Composite, Polycentric Hinged Knee Brace	86	Walking Heel	113
FLA 3D Knee Support	87	Specialist® Post-Op Shoe	114
FLA Safe-T-Sport® Neoprene Knee Sleeve	88	FLA C3™ Post Op Shoe	114
FLA GelBand® Patella Strap	89	Canvas Molded Sole Rocker	115
FLA Safe-T-Sport® Sports Neoprene Patella Support	89	Open-Toe Cast Shoe	115
FLA ProLite® Compressive Knee Support with Viscoelastic Insert	90		
FLA EZ-ON® Neoprene Knee Wrap	90		

Table of Contents

PRODUCT	PAGE
Bandaging	
Co-Plus® LF Latex-Free Cohesive Bandage	117
ORTHO-GLASS® Wraps	117
BSN Elastic Bandage Latex-Free Elastic Bandage	118
Isoband® Elastic Light Support Bandage	118
Tensogrip® Tubular Support Bandage	119
Tensoshape® Elastic Tubular Bandage	120
Leukotape® P Rigid Strapping Tape	120
Leukotape® K Tape	121
Lightplast® Pro Elastic Adhesive Bandage	122
Optiplaste® Elastic Adhesive Bandage	122
Tensoplast® Elastic Adhesive Bandage	123
Tensoplast® LF Latex-Free Elastic Adhesive Bandage	124
Thermoplastic Splints	
Specialist® Fracture Bracing	125
Finger Splints	
STAX® Finger Splints	126
Baseball Finger Splint	127
Curved/Gutter Finger Splint	127
Four Prong / Protector Finger Splint	127
Toad Finger Splint	128
Fold-Over / Cot Finger Splints	128
Total Contact Casting	
Cutimed Off-Loader & Cutimed Off-Loader Select	129
Fabric Adhesive Dressings	
Coverlet® Finger Adhesive Dressing	130
Coverlet® Eye Occlusors	130
Irrigation Products	
SplashCap® Wound Irrigation Shield	131
EyeCap™ Eye Irrigation Shield	131
AbscessCap™ Abscess & Deep Wound Irrigation Shield	132
EarCap™ Ear Irrigation Shield	132
Training & Education	
Training & Education	133
Earn & Learns	133

Synthetic Splinting

Polyester

Fiberglass

**ORTHO-
GLASS®
Comfort**

**ORTHO-
GLASS®**

Dynacast® S

Delta-Splint®

Safetysplint®



ORTHO-GLASS® Comfort

**LATEX
FREE**
FORMULA

The Progressive Splinting Solution

ORTHO-GLASS® Comfort offers two advances in synthetic splinting.

The 3D knit padding construction offers:

- Reduced risk of skin maceration
- Increased air circulation resulting in better breathability
- Increased patient comfort
- Advanced Water Resistant Padding

The Interlocking Performance Technology offers:

- Improved radiolucency compared to fiberglass splinting products
- Reduces the sharp edges
- Disposable by incineration
- Better conformability
- No risk of delamination
- Polyester high tensile strength construction



ORTHO-GLASS® Comfort Splinting System - Roll Form

Ref. No.	Size	Unit of Measure
7344101	1 in x 15 ft	2 rolls / case
7344102	2 in x 15 ft	2 rolls / case
7344103	3 in x 15 ft	2 rolls / case
7344104	4 in x 15 ft	2 rolls / case
7344105	5 in x 15 ft	2 rolls / case
7344106	6 in x 15 ft	2 rolls / case
7344110	1 in x 15 ft	1 roll / case
7344111	2 in x 15 ft	1 roll / case
7344112	3 in x 15 ft	1 roll / case
7344113	4 in x 15 ft	1 roll / case
7344114	5 in x 15 ft	1 roll / case
7344115	6 in x 15 ft	1 roll / case

ORTHO-GLASS® Color Wraps

Ref. No.	Size	Unit of Measure
CEB-2	2 in x 5 yds	18 rolls / pack
CEB-3	3 in x 5 yds	18 rolls / pack
CEB-4	4 in x 5 yds	18 rolls / pack

ORTHO-GLASS® Comfort Pre-Cut Splints

Ref. No.	Size	Unit of Measure
7344202	2 in x 12 in	10 units / case
7344203	3 in x 12 in	10 units / case
7344204	3 in x 35 in	10 units / case
7344205	4 in x 15 in	10 units / case
7344206	4 in x 30 in	10 units / case
7344207	5 in x 30 in	10 units / case
7344208	6 in x 12 in	10 units / case



ORTHO-GLASS®

LATEX
FREE
FORMULA

Fiberglass Padded Splinting System

ORTHO-GLASS® is the most cost-effective splinting system of choice for every phase of immobilization. Features Interlocking Performance Technology (ILP). ILP eliminates the risk of delamination, ensuring a strong, durable splint.

Features & Benefits

- Wrinkle-free application
- Better conformability
- Eliminates risk of delamination
- No wrong side application
- Easy stretch padding covers all edges
- Roll form eliminates waste
- Full educational support system – workshops, in-services, manuals, wall-charts, videos.



ORTHO-GLASS® Splinting System

Ref. No.	Size	Unit of Measure
OG-1L2	1 in x 15 ft	2 rolls / case
OG-2L2	2 in x 15 ft	2 rolls / case
OG-3L2	3 in x 15 ft	2 rolls / case
OG-4L2	4 in x 15 ft	2 rolls / case
OG-5L2	5 in x 15 ft	2 rolls / case
OG-6L2	6 in x 15 ft	2 rolls / case
66000687	8 in x 7.5 ft	1 roll

Accessories

Ref. No.	Description	Unit of Measure
OG-SC	Scissors	1 each
6700043	Water Bottle Applicator	1 each
SN4094	Splint & Cast Cart	1 each
OG-2CDA	ORTHO-GLASS® 2 Unit Dispenser	1 each
OG-3CDA	ORTHO-GLASS® 3 Unit Dispenser	1 each
OG-4CDA	ORTHO-GLASS® 4 Unit Dispenser	1 each
OG-5CDA	ORTHO-GLASS® 5 Unit Dispenser	1 each
OG-6CDA	ORTHO-GLASS® 6 Unit Dispenser	1 each

SN4094 Splint & Cast Cart Specifications

- 40⁵/₈"L x 20"W x 37¹/₂"H
- Lockable doors
- Sliding top draw
- Easy "pound-together" assembly
- Large non-marking casters

ORTHO-GLASS® Pre-Cut Splints

Ref. No.	Size	Unit of Measure
OG-2PC	2 in x 12 in	10 splints / box
OG-3PC	3 in x 12 in	10 splints / box
OG-335PC	3 in x 35 in	5 splints / box
OG-4PC	4 in x 15 in	10 splints / box
OG-430PC	4 in x 30 in	5 splints / box
OG-5PC	5 in x 30 in	5 splints / box
OG-545PC	5 in x 45 in	5 splints / box
OG-610PC	6 in x 10 in	10 splints / box
OG-6PC	6 in x 30 in	5 splints / box
OG-645PC	6 in x 45 in	5 splints / box



SafetySplint™

Fiberglass Unpadded Roll

SafetySplint™ is a unique, strong and durable unpadded splint which allows you to control the amount of cushion between the patient and the splint. The unique liner does not require gloves and allows for easy removal for dressing changes.

Features & Benefits

- Thin profile - excellent feel-through for fracture alignment
- Unique liner allows for no gloves and easy removal for dressing changes
- Roll form - No waste
- Strong and durable
- Radiolucent
- Totally clean application
- Excellent for post-op immobilization



SAFETYSPLINT™ Unpadded Roll

Ref. No.	Size	Unit of Measure
67007969	3 in x 15 ft	1 roll / case
67007970	4 in x 15 ft	1 roll / case
67007971	5 in x 15 ft	1 roll / case
67007968	6 in x 15 ft	1 roll / case

SafetySplint™

Fiberglass Padded Precut System

Features & Benefits

- Saves time, no plaster clean-up
- Fast set-up, quick patient turn around
- Molds easily for custom fit
- Lightweight and durable
- Patient friendly, fits easily under clothing
- Comfortable to wear, washable
- Compact packaging

SAFETYSPLINT™ Padded Precut System

Ref. No.	Size	Unit of Measure
SS-2PC	2 in x 12 in	15 splints / box
SS-3PC	3 in x 12 in	15 splints / box
SS-335PC	3 in x 35 in	15 splints / box
SS-4PC	4 in x 15 in	15 splints / box
SS-430PC	4 in x 30 in	15 splints / box
SS-5PC	5 in x 30 in	10 splints / box
SS-6PC	6 in x 30 in	10 splints / box



ORTHO-GLASS®

LATEX
FREE
FORMULA

Fiberglass Unpadded Precut Splinting System

The ORTHO-GLASS® Unpadded Precut System is a fiberglass splinting system that provides strength and durability in a padded splint. Available in various widths and lengths.

Features & Benefits

- Excellent for post-op application
- Unit dose application
- Strong and durable
- 6 sizes available



ORTHO-GLASS® Unpadded Precut Splinting System

Ref. No.	Size	Unit of Measure
OG-312NP	3 in x 12 in	Box / 10
OG-338NP	3 in x 38 in	Box / 10
OG-415NP	4 in x 15 in	Box / 10
OG-424NP	4 in x 24 in	Box / 10
OG-430NP	4 in x 30 in	Box / 10
OG-438NP	4 in x 38 in	Box / 10

ORTHO-GLASS® Solo

Fiberglass Unpadded Precut Splinting System

The ORTHO-GLASS® Solo Unpadded Precut System is a fiberglass splinting system using the latest innovation in interlock knit technology. This product consists of a single interlock knit layer of polyurethane resin-impregnated fiberglass. Available in various widths and lengths.

Features & Benefits

- Excellent for post-op application
- Thin profile - excellent feel-through for fracture alignment
- Unit dose application
- Strong and durable
- Unique liner allows for no gloves and easy removal for dressing changes
- New interlock knit technology
- Strong and durable
- Radiolucent
- Totally clean application
- 7 sizes available



ORTHO-GLASS® Solo Unpadded Precut Splinting System

Ref. No.	Size	Unit of Measure
7296400	2 in x 10 in	Box / 10
7296401	3 in x 12 in	Box / 10
7296402	3 in x 35 in	Box / 10
7296403	4 in x 15 in	Box / 10
7296404	4 in x 30 in	Box / 10
7296405	5 in x 30 in	Box / 10
7296406	6 in x 12 in	Box / 10

ORTHO-GLASS®

**LATEX
FREE**
FORMULA

Strap Kits

The ORTHO-GLASS® Strap Kit is for use in the rehabilitation stage. This patient-friendly product enables long-term use without the need for a full bandage, enabling easy splint removal. Strap Kits are provided with three latex-free hook and loop, stretchable straps.



ORTHO-GLASS® Strap Kits

Ref. No.	Description	Unit of Measure
7141518	Upper Extremity Kit	10 kits / box
7141519	Lower Extremity Kit	10 kits / box

Upper Extremity Kit

3 Red Straps, 1 - 5/8" x 17" and 2 - 2" x 19 1/2"

Lower Extremity Kit

3 Blue Straps, 2" x 22 1/2"

ORTHO-GLASS®

**LATEX
FREE**
FORMULA

Ankle Treatment System

The ORTHO-GLASS® Ankle Treatment System is a complete, custom-moldable single-patient care kit that is a cost-effective treatment from acute to rehab. It is strong, lightweight yet durable and fits easily in a shoe or boot. Available as single or 10 pack.



Features & Benefits

- Fast and convenient
- 100% Latex-free
- Sizes: Pediatric, small-medium and large
- Cost effective treatment from acute to rehab

ORTHO-GLASS® AS Latex-Free 10 Pack

Ref. No.	Size	Unit of Measure
58000013	Small - Medium (<5'7")	10 pack / box
58000014	Large (>5'7")	10 pack / box

ORTHO-GLASS® AS Treatment Kit

Ref. No.	Size	Unit of Measure
58000002	Pediatric	1 kit
58000003	Small - Medium (<5'7")	1 kit
58000004	Large (>5'7")	1 kit



Acute



Rehab

Delta-Splint®

Fiberglass Roll Form Splint System

Delta-Splint® offers

- Low profile, padded one side
- Easy stretch padding

Cost effective

- Eliminates expensive pre-formed splints

Simple in design and use

- Saves time; no plaster clean-up
- Fast set-up; quick patient turn around
- Molds easily for custom fit
- Lightweight and durable
- Patient friendly; fits easily under clothing
- Comfortable to wear; washable
- Compact packaging



Delta-Splint® Padded Roll Form Splint System

Ref. No.	Size	Unit of Measure
7342700	2 in x 15 ft	2 rolls / case
7342701	3 in x 15 ft	2 rolls / case
7342702	4 in x 15 ft	2 rolls / case
7342703	5 in x 15 ft	2 rolls / case
7342704	6 in x 15 ft	2 rolls / case

Dynacast® S

Fiberglass Padded Roll Form Splint System

Dynacast® S offers

- No wrong side application
- Easy stretch padding covers all edges
- 7 layer fiberglass

Cost effective

- Eliminates expensive pre-formed splints
- Roll form allows for no waste

Simple in design and use

- Saves time; no plaster clean-up
- Fast set-up; quick patient turn around
- Molds easily for custom fit
- Lightweight and durable
- Patient friendly; fits easily under clothing
- Comfortable to wear; washable
- Compact packaging



Dynacast® S Padded Roll Form Splint System

Ref. No.	Size	Unit of Measure
7449801	1 in x 15 ft	1 roll / box
7449802	2 in x 15 ft	1 roll / box
7449803	3 in x 15 ft	1 roll / box
7449804	4 in x 15 ft	1 roll / box
7449805	5 in x 15 ft	1 roll / box
7449806	6 in x 15 ft	1 roll / box

Delta-Xpress™

High Speed Immobilization

Delta-Xpress™ is a splinting system that allows you to immobilize limbs within a fraction of time needed. The prefabricated design is intuitive to use and cuts out many time-consuming steps while still providing a secure and strong immobilization.

Features & Benefits

- Fast, easy and secure application
- Functional position
- Helps to reduce pain
- Latex-free formula
- Breathable
- Extremely high radiolucency
- Ultra light-weight design
- Minimal storage space



Delta-Xpress™ Wrist Splint

Ref. No.	Color	Size	Unit of Measure
7271200	Purple	Small	10 rolls / box
7271201	Blue	Medium	10 rolls / box
7271202	Black	Large	10 rolls / box



Delta-Xpress™ Wrist Splint

Delta-Xpress™ Hand & Wrist Splint

Ref. No.	Color	Size	Unit of Measure
7271300	Purple	Small	10 rolls / box
7271301	Blue	Medium	10 rolls / box
7271302	Black	Large	10 rolls / box



Delta-Xpress™ Hand & Wrist Splint

Delta-Xpress™ Elbow Splint

Ref. No.	Color	Size	Unit of Measure
7271000	Purple	Small	10 rolls / box
7271001	Blue	Medium	10 rolls / box
7271002	Black	Large	10 rolls / box



Delta-Xpress™ Elbow Splint

Delta-Xpress™ Lower Leg Splint

Ref. No.	Color	Size	Unit of Measure
7271100	Purple	Small	10 rolls / box
7271101	Blue	Medium	10 rolls / box
7271102	Black	Large	10 rolls / box



Delta-Xpress™ Lower Leg Splint

Delta-Xpress™ Knee Splint

Ref. No.	Size	Unit of Measure
7271401	Medium	6 rolls / box



Delta-Xpress™ Knee Splint

OCL® Splint Roll - 2



Plaster Splinting System

OCL® is the first name in Plaster Splint Roll. OCL Splint Roll is constructed with 15 or 11 layers of plaster encased in open cell foam and flannel. The open cell foam provides padding and prevents migration while the flannel reduces moisture retention.

Features & Benefits

- DuoSet™ plaster allows a quick set time with minimal heat
- Open cell foam and flannel
- Reinforced layer
- Available in 2", 3", 4", 5" and 6"
- 11 and 15 layers



OCL® Splint Roll - 15 Layer

Ref. No.	Size	Unit of Measure
SR215	2 in x 20 ft	1 roll
SR315	3 in x 20 ft	1 roll
SR415	4 in x 20 ft	1 roll
SR515	5 in x 20 ft	1 roll
SR615	6 in x 20 ft	1 roll

OCL® Splint Roll - 11 Layer

Ref. No.	Size	Unit of Measure
SR211	2 in x 20 ft	1 roll
SR311	3 in x 20 ft	1 roll
SR411	4 in x 20 ft	1 roll
SR511	5 in x 20 ft	1 roll
SR611	6 in x 20 ft	1 roll

Specialist® J-Splint®



Plaster Roll Immobilizer

With a foam and stockinette configuration, the Specialist® J-Splint® Plaster Roll Immobilizer allows for quick, low-cost application. It is packaged in a roll format, allowing custom-cut lengths, thereby eliminating waste.

Features & Benefits

- Utilizes Specialist® Plaster of Paris
- Economical

Specialist® J-Splint® Plaster Roll Immobilizer

Ref. No.	Size	Unit of Measure
7332	2 in x 20 ft	1 roll / box
7333	3 in x 20 ft	1 roll / box
7334	4 in x 20 ft	1 roll / box
7335	5 in x 20 ft	1 roll / box
7336	6 in x 20 ft	1 roll / box



Plaster Roll

Immobilizer Dispenser

The Plaster Roll Immobilizer Dispenser is a handy option for the storage of the plaster splint roll products. Available in 3- and 5-slot designs, this dispenser has a hinged door for easy access and replenishing inventory while a cutting guide allows for quick and easy applications.



Plaster Roll Immobilizer Dispenser

Ref. No.	Description
GPS-5CD	5 Station Dispenser (2", 3", 4", 5" & 6" Slots)
GPS-3CD	3 Station Dispenser (3", 4" & 6" Slots)

Cutting Template Set

Ref. No.	Description	Unit of Measure
CTS100U	Cutting Template Set	each

BSN medical Elastic Bandages

Ref. No.	Size	Size	Unit of Measure
1037023	Beige	2 in x 5 yds	10 / box*; 5 bx / case
1037033	Beige	3 in x 5 yds	10 / box*; 5 bx / case
1037043	Beige	4 in x 5 yds	10 / box*; 5 bx / case
1037053	Beige	6 in x 5 yds	10 / box*; 5 bx / case

* Sold by case of 5 boxes

Gypsona®

Endless Slab Dispenser Pack

A unique 5-ply dispenser containing creamy, extra-fast plaster which enables improved detailed impressions and a faster set-up time. The technique used allows for faster application and a shorter casting time. This product is ideal for body jackets.

Features & Benefits

- Convenient 5-ply system
- Extra-fast set time

Gypsona® Endless Slab Dispenser Pack

Ref. No.	Size	Unit of Measure
87004913	4 in x 65 ft	1 / box
87004915	6 in x 65 ft	1 / box
87004916	8 in x 65 ft	1 / box



Plaster of Paris Bandages & Splints

Specialist® Plaster of Paris uses a time-tested formula and manufacturing process that produces a consistent plaster that is uniformly coated and adhered to the gauze. This unique formula offers minimal plaster loss to ensure maximum strength and a smooth cast finish.

Features & Benefits

- Consistency
- High dry/wet plaster retention
- Low exotherm
- Moisture-resistant packaging
- Excellent strength
- Early green strength
- Smooth finish



Specialist® Plaster Bandages - Extra Fast Setting / 2-4 minutes

Ref. No.	Size	Unit of Measure
7362	2 in x 3 yds	6 doz / case
7363	3 in x 3 yds	6 doz / case
7367	4 in x 5 yds	6 doz / case
7369	5 in x 5 yds	4 doz / case
7368	6 in x 5 yds	4 doz / case
7370	8 in x 5 yds	2 doz / case

Specialist® Plaster Bandages - Fast Setting / 5-8 minutes

Ref. No.	Size	Unit of Measure
7372	2 in x 3 yds	6 doz / case
7373	3 in x 3 yds	6 doz / case
7374	4 in x 5 yds	6 doz / case
7375	5 in x 5 yds	4 doz / case
7376	6 in x 5 yds	4 doz / case
7378	8 in x 5 yds	4 doz / case

Specialist® Plaster Splints - Extra Fast Setting / 2-4 minutes

Ref. No.	Size	Unit of Measure
7390	3 in x 15 in	12 boxes / case
7391	4 in x 15 in	12 boxes / case
7392	5 in x 30 in	6 boxes / case

Specialist® Plaster Splints - Fast Setting / 5-8 minutes

Ref. No.	Size	Unit of Measure
7393	3 in x 15 in	12 boxes / case
7394	4 in x 15 in	12 boxes / case
7395	5 in x 30 in	6 boxes / case
7396	5 in x 45 in	4 boxes / case

Orthoflex®

Elastic Plaster of Paris Bandages

Orthoflex® elastic plaster bandages are ideal for difficult casting procedures such as post-amputation, as they conform well to body contours and bony prominences. Orthoflex® elastic bandages are manufactured with Specialist® plaster and an elastic gauze.

Orthoflex® Elastic Plaster Bandages - Fast Setting / 5-8 minutes

Ref. No.	Size	Unit of Measure
7324*	4 in x 4 yds	6 doz / case
7325*	5 in x 4 yds	4 doz / case



* CAUTION: This product contains latex rubber which may cause an allergic reaction

Gypsona® S

Plaster of Paris Bandages and Splints

Gypsona® S plaster products feature a creamy plaster that results in a smoother, stronger cast. The central plastic core prevents telescoping and improves the handling of the bandage. Available in bandages, splints and elastic plaster bandages.

Features & Benefits

- Fast immobilization of fractures
- High mass weight resulting in low plaster loss
- Strong and durable casts
- Central plastic core

Gypsona® S Plaster Splints - Extra Fast Setting / 2-4 minutes

Ref. No.	Size	Unit of Measure
30-7390	3 in x 15 in	50 rolls / box
30-7391	4 in x 15 in	50 rolls / box
30-7392	5 in x 30 in	50 rolls / box

Gypsona® S Plaster Splints - Fast Setting / 5-8 minutes

Ref. No.	Size	Unit of Measure
30-7393	3 in x 15 in	50 rolls / box
30-7394	4 in x 15 in	50 rolls / box
30-7395	5 in x 30 in	50 rolls / box
30-7396	5 in x 45 in	50 rolls / box

Gypsona® HP

Plaster of Paris Bandages and Splints

The traditional rich and creamy texture of Gypsona® HP allows intimate molding and creates a smooth, appealing finished cast. Unique interlocking leno weave greatly enhances stability, allowing more plaster to stay on the gauze. The result is a premium plaster of Paris.

Features & Benefits

- Leno gauze for extra stability
- Extra-fast setting
- Creamy texture



Gypsona® S Plaster Bandages - Extra Fast Setting / 2-4 minutes

Ref. No.	Size	Unit of Measure
30-7362	2 in x 3 yds	12 rolls / box
30-7363	3 in x 3 yds	12 rolls / box
30-7367	4 in x 5 yds	12 rolls / box
30-7369	5 in x 5 yds	12 rolls / box
30-7368	6 in x 5 yds	12 rolls / box
30-7370	8 in x 5 yds	12 rolls / box

Gypsona® S Plaster Bandages - Fast Setting / 5-8 minutes

Ref. No.	Size	Unit of Measure
30-7372	2 in x 3 yds	12 rolls / box
30-7373	3 in x 3 yds	12 rolls / box
30-7374	4 in x 5 yds	12 rolls / box
30-7375	5 in x 5 yds	12 rolls / box
30-7376	6 in x 5 yds	12 rolls / box
30-7378	8 in x 5 yds	12 rolls / box

Gypsona® S Plaster Elastic Bandages - Fast Setting / 5-8 minutes

Ref. No.	Size	Unit of Measure
30-7324*	4 in x 4 yds	12 rolls / box
30-7325*	5 in x 4 yds	12 rolls / box

* Caution: This product contains latex rubber which may cause an allergic reaction



Gypsona® HP Plaster Bandages - Extra Fast Setting / 2-4 minutes

Ref. No.	Size	Unit of Measure
30-3041	2 in x 3 yds	12 rolls / box
30-3042	3 in x 3 yds	12 rolls / box
30-3045	4 in x 5 yds	12 rolls / box
30-3046	6 in x 5 yds	12 rolls / box
30-3040	8 in x 5 yds	12 rolls / box

Gypsona® HP Plaster Splints - Extra Fast Setting / 2-4 minutes

Ref. No.	Size	Unit of Measure
30-3047	3 in x 15 in	50 rolls / box
30-3048	4 in x 15 in	50 rolls / box
30-3049	5 in x 30 in	50 rolls / box

OCL[®] Plaster of Paris

**LATEX
FREE**
FORMULA

Bandages & Splints

OCL plaster products feature a highly creamy texture for ease of molding. The quick wet out and consistent set time are great for making custom splints in the Emergency Department or negative molds in the O & P office.

Features & Benefits

- Creamy texture
- Fast and Extra Fast set time
- Quick Wet out
- Smooth finish



OCL Plaster Bandage -

Extra Fast - Set Time 2-4 mins. (Green Label)

Ref. No.	Size	Unit of Measure
41923X	2 in x 3 yds	6 doz / case
41933X	3 in x 3 yds	6 doz / case
41935X	3 in x 5 yds	6 doz / case
41943X	4 in x 3 yds	6 doz / case
41945X	4 in x 5 yds	6 doz / case
41955X	5 in x 5 yds	4 doz / case
41963X	6 in x 3 yds	4 doz / case
41965X	6 in x 5 yds	4 doz / case
41985X	8 in x 5 yds	3 doz / case
419125X	12 in x 5 yds	1 doz / case
419185X	18 in x 5 yds	1 doz / case
419325X	32 in x 5 yds	1 doz / case

OCL Plaster Splints -

Extra Fast - Set Time 2-4 mins. (Green Label)

Ref. No.	Size	Unit of Measure
43315X	3 in x 15 in	50 units / box; 12 boxes / case
43415X	4 in x 15 in	50 units / box; 12 boxes / case
43530X	5 in x 30 in	50 units / box; 12 boxes / case
43545X	5 in x 45 in	50 units / box; 12 boxes / case

OCL Plaster Splints -

Fast - Set Time 5-8 mins. (Blue Label)

Ref. No.	Size	Unit of Measure
42315F	3 in x 15 in	50 units / box; 12 boxes / case
42415F	4 in x 15 in	50 units / box; 12 boxes / case
42530F	5 in x 30 in	50 units / box; 12 boxes / case
42545F	5 in x 45 in	50 units / box; 12 boxes / case

OCL Plaster Bandage -

Fast - Set Time 5-8 mins. (Blue Label)

Ref. No.	Size	Unit of Measure
41823F	2 in x 3 yds	6 doz / case
41833F	3 in x 3 yds	6 doz / case
41835F	3 in x 5 yds	6 doz / case
41845F	4 in x 5 yds	6 doz / case
41855F	5 in x 5 yds	4 doz / case
41865F	6 in x 5 yds	4 doz / case
41885F	8 in x 5 yds	3 doz / case
418125F	12 in x 5 yds	1 doz / case

OCL Elastic Plaster Bandage* -

Set Time 4-6 mins. (Red Label)

Ref. No.	Size	Unit of Measure
41344E	4 in x 4 yds	6 doz / case
41354E	5 in x 4 yds	4 doz / case
41364E	6 in x 4 yds	4 doz / case

* CAUTION: This product contains latex rubber which may cause an allergic reaction



Synthetic Cast Tape

Fiberglass

Polyester

**Delta-Lite®
Conformable**

**Delta-Lite®
Plus**

**Delta-Cast®
Conformable**

**Delta-Cast®
Elite**

**Delta-Cast®
Prints**

**Delta-Cast®
Soft**

**The Advanced
Durable Solution**

**The Trusted
Rigid Solution**

**The Best in
Class Solution**

**The Progressive
Solution**

**The Playful
Solution**

**The Flexible
Solution**

**We have the cast tape to fit
your needs.**



Delta-Lite® Conformable



The Advanced Durable Solution Fiberglass Cast Tape

Superior handling is an outstanding feature of Delta-Lite® Conformable. Its high conformability and the benefits of a new resin formulation guarantee problem-free application and superb anatomically molded casts.



Features & Benefits

- Now low tack - use the gloves of your choice
- Primary and secondary casting
- Rigid support
- Superior conformability
- Exceptional strength
- Excellent lamination
- Three-dimensional stretch
- Weight bearing in approximately 20 minutes
- 3 - 5 minute set time



Delta-Lite® Conformable Fiberglass Cast Tape

Ref. No.	Color	Size	Unit of Measure
6822A	White	2 in x 4 yds	10 rolls / case
6823A	White	3 in x 4 yds	10 rolls / case
6824A	White	4 in x 4 yds	10 rolls / case
6825A	White	5 in x 4 yds	10 rolls / case
5942	Dk Blue	2 in x 4 yds	10 rolls / case
5943	Dk Blue	3 in x 4 yds	10 rolls / case
5944	Dk Blue	4 in x 4 yds	10 rolls / case
5902	Lt Blue	2 in x 4 yds	10 rolls / case
5903	Lt Blue	3 in x 4 yds	10 rolls / case
5904	Lt Blue	4 in x 4 yds	10 rolls / case
5972	Purple	2 in x 4 yds	10 rolls / case
5973	Purple	3 in x 4 yds	10 rolls / case
5974	Purple	4 in x 4 yds	10 rolls / case
5932	Red	2 in x 4 yds	10 rolls / case
5933	Red	3 in x 4 yds	10 rolls / case
5934	Red	4 in x 4 yds	10 rolls / case
5952	Green	2 in x 4 yds	10 rolls / case
5953	Green	3 in x 4 yds	10 rolls / case
5954	Green	4 in x 4 yds	10 rolls / case
6062	Black	2 in x 4 yds	10 rolls / case
6063	Black	3 in x 4 yds	10 rolls / case
6064	Black	4 in x 4 yds	10 rolls / case
6052	Pink	2 in x 4 yds	10 rolls / case
6053	Pink	3 in x 4 yds	10 rolls / case
6054	Pink	4 in x 4 yds	10 rolls / case
6032	Yellow	2 in x 4 yds	10 rolls / case
6033	Yellow	3 in x 4 yds	10 rolls / case
6034	Yellow	4 in x 4 yds	10 rolls / case
6022	Orange	2 in x 4 yds	10 rolls / case
6023	Orange	3 in x 4 yds	10 rolls / case
6024	Orange	4 in x 4 yds	10 rolls / case
6055	Mixed Pack*	2 in x 4 yds	10 rolls / case
6056	Mixed Pack*	3 in x 4 yds	10 rolls / case
6057	Mixed Pack*	4 in x 4 yds	10 rolls / case

Colors and availability subject to change. Contains 4 pairs of large casting gloves.

* Mixed Pack: Contains 2 dark blue, 2 light blue, 2 red, 2 purple and 2 black

Delta-Lite® Plus



The Trusted Rigid Solution Fiberglass Cast Tape

Delta-Lite® Plus is designed to ensure excellent rigid support. Thanks to its light but strong fiberglass substrate and resin formula it has become the trusted solution for all fractures requiring strong and lasting support.

Features & Benefits

- Low tack resin
- Primary and secondary casting
- Rigid support
- Good conformability
- High lamination
- Excellent end lay down
- Smooth surface
- 3 - 5 minutes set time
- Weight bearing in 20 minutes



Delta-Lite® Plus Fiberglass Reinforcing Strips

Ref. No.	Size	Unit of Measure
7227200	3 in x 15 in	10, 5-ply / box
7227201	4 in x 35 in	10, 5-ply / box
7348503	4 in x 15 in	10, 5-ply / box
7348504	5 in x 35 in	10, 5-ply / box

Delta-Lite® Plus Fiberglass Cast Tape

Ref. No.	Color	Size	Unit of Measure
7345800	White	1 in x 2 yds	10 rolls / box
7345801	White	2 in x 4 yds	10 rolls / box
7345802	White	3 in x 4 yds	10 rolls / box
7345803	White	4 in x 4 yds	10 rolls / box
7345804	White	5 in x 4 yds	10 rolls / box
7345820	Deep Blue	2 in x 4 yds	10 rolls / box
7345821	Deep Blue	3 in x 4 yds	10 rolls / box
7345822	Deep Blue	4 in x 4 yds	10 rolls / box
7345823	Deep Blue	5 in x 4 yds	10 rolls / box
7345825	Green	2 in x 4 yds	10 rolls / box
7345826	Green	3 in x 4 yds	10 rolls / box
7345827	Green	4 in x 4 yds	10 rolls / box
7345828	Green	5 in x 4 yds	10 rolls / box
7345830	Deep Red	2 in x 4 yds	10 rolls / box
7345831	Deep Red	3 in x 4 yds	10 rolls / box
7345832	Deep Red	4 in x 4 yds	10 rolls / box
7345835	Light Blue	2 in x 4 yds	10 rolls / box
7345836	Light Blue	3 in x 4 yds	10 rolls / box
7345837	Light Blue	4 in x 4 yds	10 rolls / box
7345838	Light Blue	5 in x 4 yds	10 rolls / box

Delta-Lite® Plus Fiberglass Cast Tape

Ref. No.	Color	Size	Unit of Measure
7345845	Black	2 in x 4 yds	10 rolls / box
7345846	Black	3 in x 4 yds	10 rolls / box
7345847	Black	4 in x 4 yds	10 rolls / box
7345855	Pink	2 in x 4 yds	10 rolls / box
7345856	Pink	3 in x 4 yds	10 rolls / box
7345857	Pink	4 in x 4 yds	10 rolls / box
7345860	Purple	2 in x 4 yds	10 rolls / box
7345861	Purple	3 in x 4 yds	10 rolls / box
7345862	Purple	4 in x 4 yds	10 rolls / box
7345865	Yellow	2 in x 4 yds	10 rolls / box
7345866	Yellow	3 in x 4 yds	10 rolls / box
7345867	Yellow	4 in x 4 yds	10 rolls / box
7345875	Orange	2 in x 4 yds	10 rolls / box
7345876	Orange	3 in x 4 yds	10 rolls / box
7345877	Orange	4 in x 4 yds	10 rolls / box
7345885	Maroon	2 in x 4 yds	10 rolls / box
7345886	Maroon	3 in x 4 yds	10 rolls / box
7345887	Maroon	4 in x 4 yds	10 rolls / box
7345850	Mixed Pack**	2 in x 4 yds	10 rolls / box
7345851	Mixed Pack**	3 in x 4 yds	10 rolls / box
7345852	Mixed Pack**	4 in x 4 yds	10 rolls / box

Colors and availability subject to change. Please refer to the product label or package insert for full instructions on the safe use of these products.

** Mixed pack: Contains 2 rolls of each: deep blue, red, light blue, purple, pink.

Delta-Cast® Conformable

**LATEX
FREE**
FORMULA

The Best in Class Solution Polyester Cast Tape

Sets a benchmark in non-fiberglass cast tapes. Delta-Cast® Conformable responds to all challenges of daily fracture management. The secret behind Delta-Cast® Conformable and its outstanding benefits lies in its unique components, making it the premium choice in cast rooms around the world. Provides rigid and semi-rigid casting options for primary and secondary casting applications where patient fit, comfort and compliance are critical.



Features & Benefits

- Primary and secondary casting
- Rigid and semi-rigid support
- Excellent conformability
- Weight bearing in 20 - 30 minutes
- 3 - 5 minute set time
- Fiberglass-free
- Clear radiograph viewing
- Now low tack; use the gloves of your choice
- Strong and lightweight
- Soft edges
- Excellent lamination
- Smooth finish



3-way stretch



Wrinkle-free handling

Delta-Cast® Conformable Polyester Cast Tape

Ref. No.	Color	Size	Unit of Measure
6601	White	1 in x 2 yds	10 rolls / box
6602	White	2 in x 4 yds	10 rolls / box
6603	White	3 in x 4 yds	10 rolls / box
6604	White	4 in x 4 yds	10 rolls / box
6605	White	5 in x 4 yds	10 rolls / box
6612	Pink	2 in x 4 yds	10 rolls / box
6613	Pink	3 in x 4 yds	10 rolls / box
6614	Pink	4 in x 4 yds	10 rolls / box
6622	Dark Blue	2 in x 4 yds	10 rolls / box
6623	Dark Blue	3 in x 4 yds	10 rolls / box
6624	Dark Blue	4 in x 4 yds	10 rolls / box
6632	Neon Yellow	2 in x 4 yds	10 rolls / box
6633	Neon Yellow	3 in x 4 yds	10 rolls / box
6634	Neon Yellow	4 in x 4 yds	10 rolls / box
6642	Neon Orange	2 in x 4 yds	10 rolls / box
6643	Neon Orange	3 in x 4 yds	10 rolls / box
6644	Neon Orange	4 in x 4 yds	10 rolls / box
6662	Red	2 in x 4 yds	10 rolls / box
6663	Red	3 in x 4 yds	10 rolls / box
6664	Red	4 in x 4 yds	10 rolls / box
7002	Purple	2 in x 4 yds	10 rolls / box
7003	Purple	3 in x 4 yds	10 rolls / box
7004	Purple	4 in x 4 yds	10 rolls / box
7112	Green	2 in x 4 yds	10 rolls / box
7113	Green	3 in x 4 yds	10 rolls / box
7114	Green	4 in x 4 yds	10 rolls / box
7212	Black	2 in x 4 yds	10 rolls / box
7213	Black	3 in x 4 yds	10 rolls / box
7214	Black	4 in x 4 yds	10 rolls / box
6645	Mixed*	2 in x 4 yds	10 rolls / box
6646	Mixed*	3 in x 4 yds	10 rolls / box
6647	Mixed*	4 in x 4 yds	10 rolls / box

Colors and availability subject to change. Please refer to the product label and/or package insert for full instructions on the safe use of these products.

* Mixed pack: Contains 2 rolls of each: deep blue, red, light blue, purple, pink.

Synthetic Cast Tape

Functional Cast Therapy

Featuring Delta-Cast® Conformable

A New Philosophy

Conventional casting and splinting materials like plaster and fiberglass produce casts and splints that are rigid over the entire surface. For the patient, this means that areas not affected may also be immobilized, leading to atrophy, stiffness and general discomfort.

By using Delta-Cast® Conformable casting tape and FCT techniques, patient comfort is improved by creating casts and splints that are rigid where immobilization is required and flexible in areas not requiring rigid immobilization. Joints and fractures are stabilized without negatively affecting adjoining soft tissue or joints. This concept stabilizes the injury site, yet maximizes muscle function.

Delta-Cast® Conformable is used with FCT techniques to help promote optimal healing and early return to normal function and activity, which can minimize muscle atrophy and the need for extended physiotherapy.

To schedule a hands-on workshop, contact your local BSN medical Representative.

Features & Benefits

- Easy application
- Enhanced patient comfort
- Customized fit
- Quiet & easy cast removal
- Strong
- Flexible
- Lightweight

Functional Cast Therapy

Ref. No.	Description
8000	FCT System Starter Kit
51200	FCT System Dispenser
72983-00015-00	FCT Accessory Kit

Starter Kit and Accessory Kit details (content) are on page 39.



The most remarkable feature of Delta-Cast® Conformable is the wide spectrum of options it offers. The characteristics of the substrate allows the clinician to cut and trim the cast to almost every individual shape with regular cast scissors. This enables the clinician to generate circular, rigid and semi-rigid casts in addition to splints.

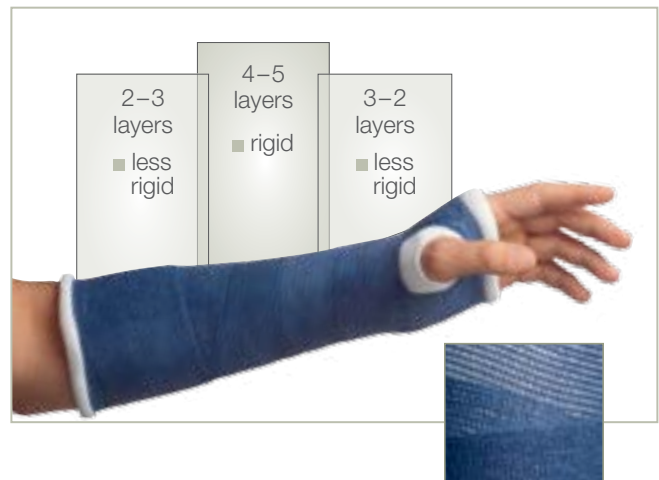

Delta-Cast® Elite

**LATEX
FREE**
FORMULA

The Progressive Solution Polyester Cast Tape

Ease of application is one of the most desired product features in the application of cast tapes. Delta-Cast® Elite is a light-weight, non-fiberglass but rigid cast which was designed to offer ease of application combined with a high level of patient comfort.



Features & Benefits

- Excellent conformability
- Strong lamination
- Excellent molding “touch”
- Reliable working time window
- Fiberglass-free
- Smooth finish & soft edges
- Free choice of glove
- Latex-free formula
- Cost-effective solution
- Highly radiolucent



Delta-Cast® Elite Polyester Cast Tape

Ref. No.	Color	Size	Unit of Measure
7227904	White	1 in x 2 yds	10 rolls / box
6712	White	2 in x 2 yds	10 rolls / box
6713	White	3 in x 4 yds	10 rolls / box
6714	White	4 in x 4 yds	10 rolls / box
6715	White	5 in x 4 yds	10 rolls / box
4812	Dark Blue	2 in x 4 yds	10 rolls / box
4813	Dark Blue	3 in x 4 yds	10 rolls / box
4814	Dark Blue	4 in x 4 yds	10 rolls / box
4862	Purple	2 in x 4 yds	10 rolls / box
4863	Purple	3 in x 4 yds	10 rolls / box
4864	Purple	4 in x 4 yds	10 rolls / box
4802	Red	2 in x 4 yds	10 rolls / box
4803	Red	3 in x 4 yds	10 rolls / box
4804	Red	4 in x 4 yds	10 rolls / box
4872	Black	2 in x 4 yds	10 rolls / box
4873	Black	3 in x 4 yds	10 rolls / box
4874	Black	4 in x 4 yds	10 rolls / box
7345500	Pink	2 in x 4 yds	10 rolls / box
7345501	Pink	3 in x 4 yds	10 rolls / box
7345502	Pink	4 in x 4 yds	10 rolls / box
7345600	Orange	2 in x 4 yds	10 rolls / box
7345601	Orange	3 in x 4 yds	10 rolls / box
7345602	Orange	4 in x 4 yds	10 rolls / box
7345400	Green	2 in x 4 yds	10 rolls / box
7345401	Green	3 in x 4 yds	10 rolls / box
7345402	Green	4 in x 4 yds	10 rolls / box
7345300	Lt Blue	2 in x 4 yds	10 rolls / box
7345301	Lt Blue	3 in x 4 yds	10 rolls / box
7345302	Lt Blue	4 in x 4 yds	10 rolls / box
7345700	Mixed*	2 in x 4 yds	10 rolls / box
7345701	Mixed*	3 in x 4 yds	10 rolls / box
7345702	Mixed*	4 in x 4 yds	10 rolls / box

* Mixed pack: Contains 2 rolls of each: dark blue, red, light blue, purple, pink.

Delta-Cast® Prints

**LATEX
FREE**
FORMULA

The Playful Solution Polyester Cast Tape

Add personality and color to casts with our eight playful patterns. In addition to helping relieve patient anxiety and making casts more enjoyable to wear, the finished cast is strong, lightweight and durable. Patterns are colorfast and will not interfere with radiographic viewing.

Features & Benefits

- Long lasting, vibrant prints
- Radiolucent
- Smooth cast finish
- Superior lamination
- Use the glove of your choice
- Weight bearing in 20 - 30 minutes
- Consistent 3 - 5 minute set-time
- Available in many popular patterns



Delta-Cast® Prints Printed Fiberglass-Free Cast Tape

Ref. No.	Pattern	Size	Unit of Measure
4002	Camouflage	2 in x 4 yds	10 rolls / box
4003	Camouflage	3 in x 4 yds	10 rolls / box
7227317	Pastel	2 in x 4 yds	10 rolls / box
4073	Pastel	3 in x 4 yds	10 rolls / box
4112	Soccer Balls	2 in x 4 yds	10 rolls / box
4113	Soccer Balls	3 in x 4 yds	10 rolls / box
7227320	Paw Prints	2 in x 4 yds	10 rolls / box
7227321	Paw Prints	3 in x 4 yds	10 rolls / box
4502	Dinosaurs	2 in x 4 yds	10 rolls / box
4082	Teddy Bears	2 in x 4 yds	10 rolls / box
4142	Stars & Stripes	2 in x 4 yds	10 rolls / box
4143	Stars & Stripes	3 in x 4 yds	10 rolls / box
8202	Holiday*	2 in x 4 yds	10 rolls / box
8203	Holiday*	3 in x 4 yds	10 rolls / box
7227330	Football Helmets	2 in x 4 yds	10 rolls / box
7227331	Football Helmets	3 in x 4 yds	10 rolls / box
7227340	Pink Camouflage	2 in x 4 yds	10 rolls / box
7227341	Pink Camouflage	3 in x 4 yds	10 rolls / box



U.S. Patent No. 5,894,032

* Only available from September to December.

Patterns and availability are subject to change. Please refer to the product label and/or package insert for full instructions on the safe use of these products.

The patterns



Camouflage

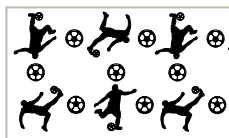

Soccer Balls



Dinosaurs



Star & Stripes

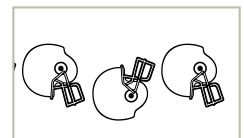

Football Helmets



Pastel



Paw Prints

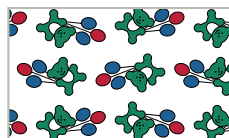

Teddy Bears



Holiday*



Pink Camouflage

25

Synthetic Cast Tape

Delta-Cast® Soft

**LATEX
FREE**
FORMULA

The Flexible Solution Polyester Cast Tape

The new fiberglass-free Delta-Cast® Soft was designed to provide functional support to fractures and soft tissue injuries. Its semi-rigidity allows for more flexibility and mobility, thus helping to reduce immobilization-related problems such as atrophy or joint stiffness. As a result, the overall healing process can be reduced.

Features & Benefits

- Earlier patient mobility
- Positive effect on overall rehab time
- Versatile applications
- High conformability
- Controllable set time
- Superior durability
- High patient comfort
- Nonfiberglass-environmentally preferred



Delta-Cast® Soft Polyester Cast Tape

Ref. No.	Color	Size	Unit of Measure
7270802	White	1 in x 2 yds	10 rolls / case
7270812	White	2 in x 4 yds	10 rolls / case
7270822	White	3 in x 4 yds	10 rolls / case
7270832	White	4 in x 4 yds	10 rolls / case
7270842	White	5 in x 4 yds	10 rolls / case
7270805	Blue	2 in x 4 yds	10 rolls / case
7270815	Blue	3 in x 4 yds	10 rolls / case
7270825	Blue	4 in x 4 yds	10 rolls / case
7270808	Red	2 in x 4 yds	10 rolls / case
7270818	Red	3 in x 4 yds	10 rolls / case
7270828	Red	4 in x 4 yds	10 rolls / case
7270801	Black	2 in x 4 yds	10 rolls / case
7270811	Black	3 in x 4 yds	10 rolls / case
7270821	Black	4 in x 4 yds	10 rolls / case
7270850	Pink	2 in x 4 yds	10 rolls / case
7270851	Pink	3 in x 4 yds	10 rolls / case
7270852	Pink	4 in x 4 yds	10 rolls / case
7270809	Paw Print***	2 in x 4 yds	10 rolls / case
7270819	Paw Print***	3 in x 4 yds	10 rolls / case
7270860	Heart Pattern	2 in x 4 yds	10 rolls / case
7270861	Heart Pattern	3 in x 4 yds	10 rolls / case



Please refer to the product label and/or package insert for full instructions on the safe use of these products.

* U.S. Patent No. 5,894,032
 ** U.S. Patent No. 5,480,708
 *** Paw Pattern



Orthopedic Padding

Cotton/Blend

Rayon

Synthetic

**Water
Resistant**

***Specialist®**

***Specialist®
100**

***Sof-Rol®**

**Protouch®
Natural**

***Delta-Rol®**

**Protouch®
Synthetic**

**Delta-Dry®
Padding**

* Available in Sterile

**We have the right padding
to fit your needs, including
sterile!**



27

Water Resistant Cast Padding

The patented Delta-Dry® material offers water-resistance. The open knit structure of the fibers accelerate drainage after submerging in water. The patient's body temperature will then evaporate residual moisture quickly through the airy mesh (high MVTR*). In this way, cast and skin dry quickly and skin feels dry in about 90 minutes after daily hygiene.

Features & Benefits

- Allows patients to shower, swim and bathe like normal
- No special tools are needed for application or removal
- Conformable, enabling patient to having increased comfort and protection
- Easy to apply
- Better long term water resistance
- Offers more under cast protection



Delta-Dry® Stockinette



Delta-Dry® Softliner

Delta-Dry® Water Resistant Cast Padding

Ref. No.	Size	Unit of Measure
7344300	2 in x 2.6 yds	12 rolls / case
7344301	3 in x 2.6 yds	12 rolls / case
7344302	4 in x 2.6 yds	12 rolls / case

Delta-Dry® Water Resistant Stockinette

NEW!

Ref. No.	Size	Unit of Measure
7456400	1 in x 11 yds	2 rolls / case
7456401	2 in x 11 yds	2 rolls / case
7456402	3 in x 11 yds	2 rolls / case
7456403	4 in x 11 yds	2 rolls / case
7456404	5 in x 11 yds	2 rolls / case

Delta-Dry® Water Resistant Softliner

NEW!

Ref. No.	Size	Unit of Measure
7277901	1 in x 11 yds	1 roll
7277902	2 in x 11 yds	1 roll
7277903	3 in x 11 yds	1 roll
7277904	4 in x 11 yds	1 roll
7277905	5 in x 11 yds	1 roll



Reimbursement Information*

- Q4050 Casting supplies, for unlisted types and materials of Cast. Use in addition to the proper fiberglass Q code for Cast Application. (Q codes recognized by Medicare/Medicaid and some commercial insurers.)
 - A4590 (Special casting material) used to bill for Delta-Dry® and cast tape with most commercial carriers.
 - 99070 Supplies over and above standard materials still used by some carriers.
- * This reimbursement information is provided for general information purposes only and should not be relied on for submission purposes.

*Moisture Vapor Transmission Rate (MVTR)

Weight of water that is able to pass through 1, 2 or 3 layers of padding

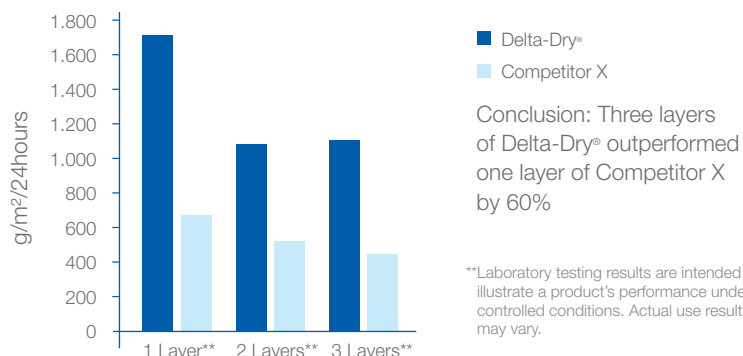

Delta-Rol®

LATEX
FREE
FORMULA

Synthetic Cast Padding

Delta-Rol® Synthetic Cast Padding is a non-absorbent synthetic material that does not hold moisture against the skin. Its conformable stretch allows narrow widths around small anatomies without cutting and tearing.

Features & Benefits

- Conformable stretch eliminates need for scissors
- Comfortable
- Non-absorbent synthetic fiber



Delta-Rol® Synthetic Cast Padding

Ref. No.	Size	Unit of Measure
6882	2 in x 4 yds	24 rolls / bag; 3 bags / case
6883	3 in x 4 yds	12 rolls / bag; 3 bags / case
6884	4 in x 4 yds	12 rolls / bag; 3 bags / case
6886	6 in x 4 yds	6 rolls / bag; 3 bags / case

Specialist®

LATEX
FREE
FORMULA

Cotton Blend Cast Padding

Specialist® Cotton Blend Cast Padding has a unique micropleated design for excellent conformability, protection and ease of application without tucking or tearing.

Features & Benefits

- Micropleated construction provides excellent conformability
- Highly absorbent
- Cotton rayon blend
- Easy application



Specialist® Cotton Blend Cast Padding

Ref. No.	Size	Unit of Measure
9062	2 in x 4 yds	24 rolls / bag; 6 bags / case
9043	3 in x 4 yds	12 rolls / bag; 6 bags / case
9044	4 in x 4 yds	12 rolls / bag; 6 bags / case
9046	6 in x 4 yds	6 rolls / bag; 6 bags / case

Specialist® 100

Cotton Cast Padding

LATEX
FREE
FORMULA

Specialist® 100 has the product features cotton users desire. The soft, 100% cotton material feathers and self-bonds to create a smooth undercast surface. Specialist® 100 is hand-tearable and applies easily. Excellent cohesion allows for custom padding around bony prominences.

Features & Benefits

- 100% cotton
- Excellent cohesion
- Hand tearable



Specialist® 100 Cotton Cast Padding

Ref. No.	Size	Unit of Measure
9082	2 in x 4 yds	24 rolls / bag; 6 bags / case
9083	3 in x 4 yds	12 rolls / bag; 6 bags / case
9084	4 in x 4 yds	12 rolls / bag; 6 bags / case
9086	6 in x 4 yds	6 rolls / bag; 6 bags / case

Sof-Rol®

Absorbent Cast Padding

Sof-Rol® is a highly absorbent material suitable for use around wounds. This soft natural material creates a comfortable undercast surface for either synthetic or natural casting materials.

Features & Benefits

- Highly absorbent
- Easy application



Soft-Rol® Absorbent Cast Padding

Ref. No.	Size	Unit of Measure
9052	2 in x 4 yds	24 rolls / bag; 6 bags / case
9033	3 in x 4 yds	12 rolls / bag; 6 bags / case
9034	4 in x 4 yds	12 rolls / bag; 6 bags / case
9036	6 in x 4 yds	6 rolls / bag; 6 bags / case

Specialist® Sterile

LATEX
FREE
FORMULA

Blend Cast Padding

Specialist® Sterile uses a unique micro-pleated design that offers exceptional stretch and conformability. Its Micro-pleats fit complex contours without slipping. Specialist® Sterile's blended fiber construction allows moisture from the casting material to relax the pleats, resulting in a uniform, smooth surface that helps reduce the risk of ridges and pressure points on the skin. Its cotton/rayon blended construction complements both plaster and synthetic casts and is highly absorbent. Its Micro-pleated construction reduces the need for tucking or tearing. Specialist® Sterile is also easy to handle with gloves.

Features & Benefits

- Excellent Conformability
- Dual Use
- Easy application
- Highly absorbent



Specialist® Sterile

Ref. No.	Size	Unit of Measure
9062S	2 in x 4 yds	50 / case
9043S	3 in x 4 yds	50 / case
9044S	4 in x 4 yds	25 / case
9046S	6 in x 4 yds	25 / case

Specialist® 100 Sterile

Cotton Undercast Padding

Specialist® 100 Sterile is highly cohesive, which allows for stack layers of custom padding and prevents bunching or slipping under the cast. Its low profile featuring fewer layers allows for an intimate mold. More layers provide additional cushioning. It easily tears down by hand without neck-down, and works around small appendages without scissors. Specialist® 100 Sterile is ideal when absorbency is preferred and is suitable for both synthetic and plaster casting materials.

Features & Benefits

- Highly Cohesive
- Low Profile
- Easy Tear
- Smooth Feathering
- Easy Application
- Absorbent
- 100% Cotton
- Dual Use



Delta-Rol® Sterile

Ref. No.	Size	Unit of Measure
9082S	2 in x 4 yds	50 / case
9083S	3 in x 4 yds	50 / case
9084S	4 in x 4 yds	25 / case
9086S	6 in x 4 yds	25 / case

Sof-Rol® Sterile

LATEX
FREE
FORMULA

Sterile Absorbent Cast Padding

Sof-Rol® Sterile is more absorbent than cotton and is suitable for use around wounds. Conformable stretch can form narrow widths suitable for wrapping digits or small anatomies. Its 100% surgical grade needle-loomed rayon complements both plaster and synthetic cast.

Features & Benefits

- Highly absorbent
- Easy application
- Dual use

Sof-Rol® Sterile

Ref. No.	Size	Unit of Measure
9052S	2 in x 4 yds	20 / case
9033S	3 in x 4 yds	20 / case
9034S	4 in x 4 yds	20 / case
9036S	6 in x 4 yds	20 / case



Delta-Rol® Sterile

Sterile Synthetic Cast Padding

Delta-Rol® Sterile has non-absorbent synthetic fibers allowing moisture to evaporate through the knitted cast substrate and drain from the cast, reducing the risk of skin maceration. It retains bulk and cushioning when wet. It has excellent conformability, allowing an intimate cast mold. Delta-Rol® Sterile's high loft provides excellent cushioning.

Features & Benefits

- Reduce risk of maceration
- Maintain protection
- Easy application
- Comfortable

Delta-Rol® Sterile

Ref. No.	Size	Unit of Measure
6882S	2 in x 4 yds	20 / case
6883S	3 in x 4 yds	20 / case
6884S	4 in x 4 yds	20 / case
6886S	6 in x 4 yds	20 / case



Protouch®

Natural Cast Padding

Protouch® Natural Cast Padding is a soft and comfortable viscose rayon that is more absorbent than cotton. Excellent conformability and easy application provide a quality undercast surface.

Features & Benefits

- Natural fibers
- Good loft

Protouch® Natural Cast Padding

Ref. No.	Size	Unit of Measure
30-3061	2 in x 4 yds	12 rolls / bag
30-3062	3 in x 4 yds	12 rolls / bag
30-3063	4 in x 4 yds	12 rolls / bag
30-3064	6 in x 4 yds	12 rolls / bag



Protouch®

Synthetic Cast Padding

Protouch® Natural is an absorbent synthetic material that does not hold moisture against the skin. It is autoclavable in its paper wrapper for sterile procedures. High loft and fleece density provide extra cushioning and patient protection.

Features & Benefits

- Excellent cushioning
- Soft conformability
- Excellent feathering

Protouch® Synthetic Cast Padding

Ref. No.	Size	Unit of Measure
30-3051	2 in x 4 yds	12 rolls / bag
30-3052	3 in x 4 yds	12 rolls / bag
30-3053	4 in x 4 yds	12 rolls / bag
30-3054	6 in x 4 yds	12 rolls / bag



Delta Terry-Net™

LATEX
FREE
FORMULA

Adhesive Terry Cloth/Foam Padding

Delta Terry-Net™ Adhesive Cloth/Foam Padding provides added protection and cushioning by combining a layer of soft terry cloth bonded to 1/8" foam. The adhesive backing makes attaching the padding simple and easy.

Features & Benefits

- Open cell foam
- Adhesive back
- Comfortable terry cloth cushion

Delta Terry-Net™ Thumb Spica Adhesive Terry Cloth/Foam Padding

Ref. No.	Size	Unit of Measure
55012	23 in x 39 in	1 roll / case



Delta Terry-Net™

LATEX
FREE
FORMULA

Adhesive Felt Padding

Delta Terry-Net™ Adhesive Felt Padding is an adhesive orthopedic felt, used for added patient comfort. Its adhesive backing makes attaching the padding simple and easy. It may also be used as a cast edge padding or to provide protection for bony prominences.

Features & Benefits

- Soft orthopedic felt
- Adhesive back

Delta Terry-Net™ Adhesive Felt Padding

Ref. No.	Size	Unit of Measure
54012	23 in x 39 in	1 roll / case



Sifoam™

Interface Padding

Features & Benefits

- Dissipates pressure around wounds
- Does not allow shear
- Is Compressable
- Unloads weight
- Can prevent skin ulcers for “non-compliant” or “at risk patients”

Sifoam™ Adhesive Backed Interface Padding

Ref. No.	Size	Unit of Measure
7279900	8 in x 9 in	10 units / box

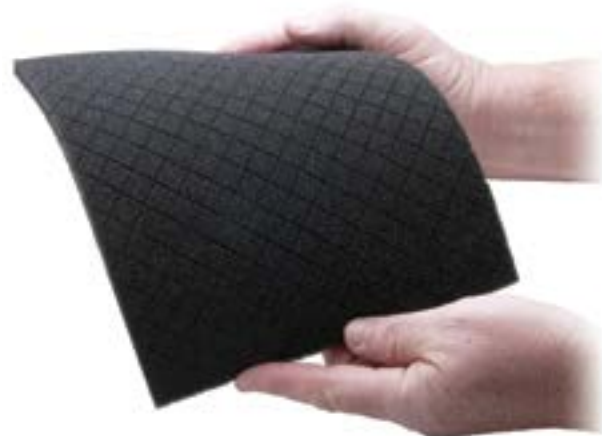

Orthopedic Stockinette

Cotton

Synthetic

**Water
Resistant**

Specialist®

Protouch®

**Delta-Terry
Net™**

**Delta-Net®
Delta-Net
Black®**

Protouch®

**Delta-Terry
Net™**

**Delta-Dry®
Stockinette**

**Delta-Dry®
Softliner**

**We have the right stockinette
to fit your needs.**



Delta-Net®

Orthopedic Synthetic Stockinette

Delta-Net® Orthopedic Synthetic Stockinette stretches to more than twice its width to conform comfortably to complex anatomies. It is suitable for use with synthetic or plaster casting materials and is contained in an easy-to-use dispensing box for easy storage and handling.

Features & Benefits

- Synthetic fibers
- Soft conformability



LATEX
FREE
FORMULA

Delta-Net® Orthopedic Synthetic Stockinette - WHITE

Ref. No.	Size	Unit of Measure
6861	1 in x 25 yds	2 rolls / case
6862	2 in x 25 yds	2 rolls / case
6863	3 in x 25 yds	2 rolls / case
6864	4 in x 25 yds	2 rolls / case
6866	6 in x 25 yds	1 roll / case
6868	8 in x 25 yds	1 roll / case
6810	10 in x 25 yds	1 roll / case



Delta-Net® Orthopedic Synthetic Stockinette - BLACK

Ref. No.	Size	Unit of Measure
7272300	1 in x 25 yds	2 rolls / case
7272301	2 in x 25 yds	2 rolls / case
7272302	3 in x 25 yds	2 rolls / case
7272303	4 in x 25 yds	2 rolls / case
7272304	6 in x 25 yds	1 roll / case

Specialist®

Orthopedic Cotton Stockinette

Specialist® Orthopedic Cotton Stockinette consists of a high-grade absorbent cotton that is an ideal undercast layer. It stretches to three times its width to conform to complex anatomies. It is contained in an easy-to-use dispensing box for easy storage and handling.

Features & Benefits

- 100% high-grade cotton
- Convenient dispensing box

Specialist® Orthopedic Cotton Stockinette

Ref. No.	Size	Unit of Measure
9071	1 in x 25 yds	1 roll / case
9072	2 in x 25 yds	9 rolls / case
9073	3 in x 25 yds	8 rolls / case
9074	4 in x 25 yds	8 rolls / case
9076	6 in x 25 yds	6 rolls / case



LATEX
FREE
FORMULA

Cotton Stockinette

Protouch® Cotton Stockinette is designed for patient protection under plaster of Paris and synthetic casting materials and is available in a wide range of sizes. It is contained in an easy-to-use dispensing box for easy storage and handling.

Features & Benefits

- 100% cotton
- Dispensing box

Protouch® Cotton Stockinette

Ref. No.	Size	Unit of Measure
30-7001	1 in x 25 yds	1 roll / box
30-7002	2 in x 25 yds	1 roll / box
30-7003	3 in x 25 yds	1 roll / box
30-7004	4 in x 25 yds	1 roll / box
30-7006	6 in x 25 yds	1 roll / box
30-7008	8 in x 25 yds	1 roll / box



Protouch®

Synthetic Stockinette

Protouch® Synthetic Stockinette is designed for patient protection under Plaster of Paris and synthetic casting materials, and is available in a wide range of sizes. It is contained in an easy-to-use dispensing box for easy storage and handling.

Features & Benefits

- Good conformability
- Dispensing box

Protouch® Synthetic Stockinette

Ref. No.	Size	Unit of Measure
30-1001	1 in x 25 yds	1 roll / box
30-1002	2 in x 25 yds	1 roll / box
30-1003	3 in x 25 yds	1 roll / box
30-1004	4 in x 25 yds	1 roll / box
30-1006	6 in x 25 yds	1 roll / box
30-1008	8 in x 25 yds	1 roll / box



Terry-Net™ C

Cotton Terry Cloth Stockinette



Terry-Net™ C Cotton Terry Cloth Stockinette is constructed of high-grade absorbent cotton. The terry-net design provides additional padding and stretches to five times its normal width to conform to complex anatomies.

Features & Benefits

- Cotton Terry-Net cushion
- Stretches five times normal width
- Convenient dispensing box



Delta Terry-Net™ C Cotton Terry Cloth Stockinette

Ref. No.	Size	Unit of Measure
52012	2 in x 15 yds	2 rolls / case
52013	3 in x 15 yds	2 rolls / case
52014	4 in x 15 yds	2 rolls / case
52015	5 in x 15 yds	1 roll / case
52016	6 in x 15 yds	1 roll / case

Terry-Net™ S

Synthetic Terry Cloth Stockinette



Terry-Net™ S Synthetic Terry Cloth Stockinette is constructed of non-absorbent synthetic fibers that do not hold moisture against the skin. The Terry-Net design provides additional padding and stretches to five times its normal width to conform to complex anatomies.

Features & Benefits

- Soft synthetic yarns
- Terry cloth design
- Stretches five times normal width
- Dispensing box



Delta Terry-Net™ S Synthetic Terry Cloth Stockinette

Ref. No.	Size	Unit of Measure
53012	2 in x 15 yds	2 rolls / case
53013	3 in x 15 yds	2 rolls / case
53014	4 in x 15 yds	2 rolls / case
53015	5 in x 15 yds	1 roll / case
53016	6 in x 15 yds	1 roll / case

Terry-Net™ Thumb Spica

Precut Synthetic Terry Cloth Stockinette

Terry-Net™ Thumb Spica is comprised of soft, non-absorbent fibers that do not hold moisture against the skin. A built-in thumb liner saves time, enhances fit and is available in a variety of sizes to accommodate most patients.

Features & Benefits

- Built-in thumb liner
- Soft synthetic fibers
- Terry cloth design

Terry-Net™ Thumb Spica Precut Synthetic Terry Cloth Stockinette

Ref. No.	Size	Unit of Measure
53120	2 in x 16 in - Short Arm	10 / case
53121	2 in x 19 in - Long Arm	10 / case
53101	3 in x 16 in - Short Arm	10 / case
53102	3 in x 19 in - Long Arm	10 / case



Delta Terry-Net™

Adhesive Fleece Edger

Delta Terry-Net™ Adhesive Fleece Edger features a high quality adhesive for secure placement. Its unique stretch allows the user to pad easily around corners and contours, ensuring smooth cast edges.

Features & Benefits

- Highly conformable
- Unique stretch
- Secure adhesive
- Works great with thermoplastics

Delta Terry-Net™ Adhesive Fleece Edger

Ref. No.	Color	Size	Unit of Measure
56012	White	1 1/4 in x 15 yds	1 roll / case
58012	Blue	1 1/4 in x 15 yds	1 roll / case



Delta Terry-Net™

LATEX
FREE
FORMULA

Adhesive Hook & Stretch Loop Closures

This easy-to-use product simplifies the FCT technique. It provides closure without creating the discomfort caused by traditional loops' rough edges. Its high quality adhesive ensures secure placement and the simple dispensing box provides convenient storage.

Features & Benefits

- Soft stretch loop
- High quality adhesive
- Dispensing box



Delta Terry-Net™ Adhesive Hook

Ref. No.	Size	Unit of Measure
52100	1 in x 10 yds	1 roll / case
52200	2 in x 10 yds	1 roll / case

Delta Terry-Net™ Stretch Loop

Ref. No.	Size	Unit of Measure
52101	1 in x 15 yds	1 roll / case
52201	2 in x 15 yds	1 roll / case



FCT Starter Kit



Featuring Delta-Cast® Conformable

The FCT Starter Kit enables innovative, functional treatment options by providing ample storage for all your FCT accessories and materials. Customized casts and splints optimize stability using revolutionary techniques to enhance patient comfort, maximize muscle function and reduce rehabilitation time.

Features & Benefits

- Easy FCT implementation for your practice
- Functional and convenient

FCT Starter Kit

Ref. No.	Description	Color	Size	Unit of Measure
8000	FCT Starter Kit	N/A	N/A	1 kit



Contents of FCT Starter Kit

Ref. No.	Description	Color	Size	Unit of Measure
6602	Delta-Cast® Conformable	White	2 in x 4 yds	1 box / 10 rolls
6603	Delta-Cast® Conformable	White	3 in x 4 yds	1 box / 10 rolls
51200	FCT Dispenser	White	19 in x 27 in x 17 in	1 dispenser
7298315	FCT Accessories Kit	N/A	N/A	1 kit

FCT Accessories Kit



The FCT Accessories Kit contains all the FCT accessories you require in one convenient package. Order it alone or as part of the FCT Starter Kit. Whichever option you choose, the FCT Accessories Kit is your convenient doorway to FCT.

Features & Benefits

- Essential tools
- Convenient ordering

FCT Accessory Kit

Ref. No.	Description
7298315	FCT Accessory Kit



Contents of FCT Accessory Kit

Ref. No.	Description	Color	Size	Unit of Measure
7204629	BSN Cast Removal Stick	White/Blue	19 in	3 sticks
7210020	Co-Plus® LF Cohesive Bandage	Varied	3 in x 5 yds	2 rolls
53012	Terry-Net™ S	White	2 in x 15 yds	1 case /2 rolls
53013	Terry-Net™ S	White	3 in x 17 yds	1 case /2 rolls
53102	Terry-Net™ Thumb Spica	White	3 in Long Arm	1 box /10
56012	Delta Terry-Net™ Edger	White	1.25 in x 15 yds	1 roll
55012	Delta Terry-Net™ Foam/Terry Liner	White	23 in x 39 in	1 roll
54012	Delta Terry-Net™ Felt Liner	White	23 in x 39 in	1 roll
52100	Delta Terry-Net™ Hook	White	1 in x 10 in	1 roll
52101	Delta Terry-Net™ Loop	White	1 in x 15 in	1 roll

Delta-Cast® Saw

The Ultimate Cast Removal Solution

BSN medical offers reliable cast removal options that are cost effective and available through your distributor of choice along with the after-sale support and service, including the only manufacturer that can offer a 48 hour repair guarantee that is unmatched in the industry.



Features & Benefits

- Low noise and vibration level
- Durable
- Small, ergonomic, lightweight
- High cutting performance
- Long-lasting blade

Delta-Cast® Saw

Ref. No.	Description	Unit of Measure
7348120	Delta-Cast® Saw (non-vacuum chamber)*	1
7348124	Delta-Cast® Saw (vacuum chamber)*	1

* comes with power supply, cords, Power Blade™

Delta-Cast Saw Specifications

Blade Diameter	2.5 in., (6.4 cm)
Blade Arbor	5/8 in., (1.6 cm)
Power Supply Input	110V - 240V, AC only, 50 - 60 Hz, 120 Watts
Saw Input	1.5 lbs., (0.68 kg)
No Load Speed (Low / High)	11,500 / 15,500 OPM*
Saw Weight	1.5 lbs., (0.68 kg)
Power Supply Weight	1.6 lbs., (0.73 kg)

* Product has been evaluated with RESPECT TO ELECTRICAL SHOCK, FIRE, AND MECHANICAL HAZARDS ONLY IN ACCORDANCE WITH IEC 60601-1, 3rd Ed.

Delta-Cast® Vacuum

Features & Benefits

- Durable
- Lightweight
- Efficient dust collection
- Hepa® filter
- Adjustable shelf

Delta-Cast® Vacuum

Ref. No.	Description	Unit of Measure
7335420	Delta-Cast® Vacuum	1
7335404	Delta-Cast® Vacuum Filter	1
7335407	Delta-Cast® Vacuum Replacement Fuses	1
7335410	Vacuum Main Cord	1

Delta-Cast Vacuum Specifications

Ref. No.	73481-06; 120VAC, 60 Hz 12.3 Amps
Dimensions (Lowered Position)	28.5 in. tall x 21 in. long x 12.5 in. wide
Power Supply Input	110V - 240V, AC Only, 50 - 60 Hz, 120 Watts
Saw Input	9V / 12V DC, 10 Amps
No Load Speed (Low / High)	10,500 / 15,000 OPM*
Duty Cycle	3 / 57 I / O
IP Rating	IPX0

* Product has been evaluated with RESPECT TO ELECTRICAL SHOCK, FIRE, AND MECHANICAL HAZARDS ONLY IN ACCORDANCE WITH IEC 60601-1, 3rd Ed.



Delta-Cast® Saw & Vacuum Combo

Ref. No.	Description	Unit of Measure
7335400	Delta-Cast® Saw & Vacuum Combo	1

American Orthopaedic™

Cast Cutter Cast Saws

The American Orthopaedic™ Cast Cutter provides precisely what is needed when needed: power, speed, quiet operation, durability, ease of operation and a balance of weight and power. Includes one 2.5" diameter multi-purpose blade and wrench.



Features & Benefits

- Balance of weight and power helps reduce user fatigue.
- Internally lubricated for longer service.
- Designed for rugged use.
- Switch is designed and placed so that it will not break if dropped.
- Hex drive provides six (6) blade rotations extending blade life by 50%

American Orthopaedic™ Cast Cutter Specifications

Ref. No.	0295-200	0295-202
Drive	Hex Drive	Pin Drive
Voltage	115 VAC, 1.5 amps Hex Drive	115 VAC, 1.5 amps Pin Drive
Supply Frequency	50-60 Hz	50-60 Hz
Cord Length	10' with hospital grade plug	10' with hospital grade plug

American Orthopaedic™

Cast Dust Vacuum & Portable Vacuum

The American Orthopaedic™ Cast Dust Vacuum provides an elegant solution to the problem of airborne dust created during cast removal. It's based on in-depth input from orthopedic technologists tired of the problems associated with modified commercial vacuums attached to cast cutters.



American Orthopaedic™ Cast Dust Vacuum

Ref. No.	0295-400*
Voltage	115 VAC, 8.5 amps
Supply Frequency	50-60 Hz
Hose Length	10' x 1.25" I.D.
Length	23"
Width	15"
Height	23.5"
Weight	25 lbs.

American Orthopaedic™ Portable Vacuum

Ref. No.	0295-300*
Voltage	115 VAC, 6.75 amps
Supply Frequency	50-60 Hz
Cord Length	10'
Airflow	66 CFM
Waterlift	63"
Width	7.5"
Height	9.75"
Length	19.5"

The American Orthopaedic Cast Dust Vacuum is supplied with a pre-installed disposable filter cartridge, 10' x 1.25" I.D. hose, 6 hose/cord straps, vacuum nozzle adapter, owner's manual and registration card.

* NOTE: This vacuum may also be adapted to the following cast cutters: Stryker #840, Stryker #940 and Zimmer #8909-01. Accessories required.

Power Blade™

Cutting Edge Cast Saw Blades

The new Power Blades™ have a higher tooth count to ensure premium performance and easy cast removal.



Power Blade™ Cast Saw Blades

Ref. No.	Coating	Hub Design	Size	Unit of Measure	Recommended Users
7348130	Polished Steel	Universal	2.5 in.	1	Plaster, Composites, Plastic
7348131	PTFE Coated	Universal	2.5 in.	1	Plaster and Synthetic Cast Materials
7348132	Titanium Nitride	Universal	2.5 in.	1	Plaster, Synthetic, Composites or Plastic
7348133	Dicronite	Universal	2.5 in.	1	Plaster, Synthetic, Composites or Plastic

Cast Saw Blades



1. Blades with no coating are manufactured from stainless steel and hardened to increase blade life. Sectioned Blades are ideal for removing small segments or “cutting windows”. The blade is manufactured from stainless steel and hardened to increase blade life. Available only with pin drive hub.

2. “Plus” blades are manufactured with a special hardening process that provides a sharp, long lasting cutting edge with hardened steel durability.

3. PTFE coated blades are manufactured with stainless steel and coated to reduce friction.

4. Titanium Nitride “Gold” coated blades resist wear, making this blade BSN’s longest lasting blade.

5. Dicronite® coated blades are manufactured with stainless steel and coated to improve the cutting process and extend the life of the blade.

Power Blade™ Cast Saw Blades

Number	Ref. No.	Coating	Hub Design	Size	Unit of Measure	Recommended Users
1	4183-110	None	Universal	2 in.	6 / pkg.	Plaster, Wood, Bone
1	4183-112	None	Universal	2.5 in.	6 / pkg.	Plaster, Wood, Bone
1	4183-145	None	Pin	Sectioned	each	Plaster, Wood, Bone
2	0295-225	Plus	Universal	2 in.	each	Plaster, Composites, Plastics
2	0295-220	Plus	Universal	2.5 in.	each	Plaster, Composites, Plastics
2	674000065	Plus	5 Sided	2.5 in.	each	Plaster, Composites, Plastics
3	4183-114	PTFE Coated	Universal	2 in.	each	Plaster, Synthetic Cast Material
3	31-0265	PTFE Coated	Universal	2.5 in.	each	Plaster, Synthetic Cast Material
3	67000430	PTFE Coated	5 Sided	2.5 in.	each	Plaster, Synthetic Cast Material
4	31-0168	Titanium Nitride “Gold”	Universal	2.5 in.	each	Plaster, Synthetic, Composites, Plastics
4	67000433	PTFE Coated	5 Sided	2.5 in.	each	Plaster, Synthetic, Composites, Plastics
5	0295-226	Dicronite	Universal	2.5 in.	each	Plaster, Synthetic, Composites, Plastics

BSN Buckets

The sturdy BSN pail provides water supply for cast activation.

Cast Application Accessories

Ref. No.	Description	Unit of Measure
7204626	BSN Plastic Pail	1 each
4183-155	BSN Wax Bucket	12 / case



Knee Rest

This sturdy foam knee rest is covered in washable vinyl for easy clean-up. The knee rest is used to aid in positioning a patient's limb for casting and to provide additional patient comfort during the casting process.

Knee Rest

Ref. No.	Color	Unit of Measure
67400002	White	1 each



Zip Stick

Cast Removal Aid

This convenient cast aid provides additional patient protection during cast removal. The stick slides under the cast and provides a smooth path for scissors or cast saw. Standard and metric rule adds functionality.

Zip Stick

Ref. No.	Color	Unit of Measure
7204629	White	1 / each



Casting Instruments

For the Orthopedic Specialist

Casting instruments from BSN medical are safe for the patient and effective for cutting casting material. They are handcrafted with high quality stainless steel to provide precision performance.



A. Improved Cast Spreader
B. Replacement Spring



C. Henning Stainless Plaster Spreader



D. Small Utility Scissors



E. Large Utility Scissors



F. Bohler Serrated Edge Scissors



G. Instrument Case



H. FCT 6" Scissors



I. FCT 8" Scissors



J. Ortho-Glass® Scissors



K. Esmarch Scissors



L. Adjustable Cast Stand

Casting Instruments

Ref. No.	Description	Unit of Measure
21-0136	A. Improved Cast Spreader 9"	1 unit
21-0137	B. Replacement Spring, Spreader	1 unit
283400	C. Henning Stainless Plaster Spreader	1 unit
27-2200	D. Small Utility Scissors All Purpose 5.5"	1 unit
7204612	E. Large Utility Scissors All Purpose 7.5"	1 unit
7293500	F. Bohler Serrated Edge Scissors 9.5"	1 unit
7293100	G. Instrument Case	1 unit
28235	H. FCT 6" Scissors	1 unit
28230	I. FCT 8" Scissors	1 unit
OG-SC	J. ORTHO-GLASS® Scissors	1 unit
21-0083	K. Esmarch Scissors 8"	1 unit
58050000	L. Adjustable Cast Stand Adjusts from 10.5" to 19"	1 unit

Orthopedic Soft Goods & Braces



Function Levels

Immobilize

For moderate to severe conditions requiring little to no movement of the affected area. For use during initial recovery.

Stabilize

For mild to moderate conditions that require some stabilization of the affected area. For use during recovery.

Support

For weak or aching muscles or joints. For use after recovery or as prevention.

**Better patient care
across the continuum.**



Miami J[®] Cervical Collar

Immobilize

LATEX
FREE
FORMULA

The Miami J[®] Cervical Collar is specially designed to meet the needs of ambulatory patients over and extended time. Technologically advanced Sorbatex padding adds long term comfort by quickly absorbing moisture away from the skin.

Color: White/Navy

Features & Benefits

- Polyurethane shell provides rigid support and immobilization
- Two piece design allows symmetrical application
- Angulation of chin and occipital portion of collar is adjustable
- Sorbatex™ padding provides comfort through moisture control



Miami J[®] Cervical Collar with Pads

Ref. No.	Size	Description	Replacement Pads
MJ 300	Small	Collar w / pads	MJP 100
MJ 400	Medium	Collar w / pads	MJP 100
MJ 500	Large	Collar w / pads	MJP 100
MJ 200S	X Short	Collar w / pads	MJP 100
MJ 200L	Stout	Collar w / pads	N/A

Miami J[®] Cervical Collar with Extra Pads

Ref. No.	Size	Description	Replacement Pads
MJR P3	6 -12 years	Collar w / extra pads	N/A
MJR 250	X Small	Collar w / extra pads	MJP 100
MJR 300	Small	Collar w / extra pads	MJP 100
MJR 400	Medium	Collar w / extra pads	MJP 100
MJR 500	Large	Collar w / extra pads	MJP 100
MJR 200S	X Short	Collar w / extra pads	MJP 100
MJR 200L	Stout	Collar w / extra pads	N/A

Suggested HCPCS Code L0174

Miami JTO[®] Thoracic Extension

Immobilize

The Miami JTO[®] Thoracic Extension extends the control of any adult Miami J[®] collar. The modular chin strut enhances flexion control by bridging the chin and sternum while the floating back improves fit and allows patients to sleep comfortably without bars.

Color: White/Navy

Miami JTO[®] Thoracic Extension

Ref. No.	Description
MTR-900	Thoracic Extension w / replacement pads



Actimove® Vertebrace® Extrication Collar

Immobilize

The Actimove® Vertebrace® Extrication Collar is a one-piece construction with a large trach opening. It contains a reinforced back which provides firm, cervical support and is X-ray translucent. Stack flat for easy storage. Color: White



Features & Benefits

- Quick and easy to apply
- Enables transportation of the patient
- Does not obstruct other emergency treatment
- Easy to store and carry
- Apply without moving the patient

ACTIMOVE® VERTEBRACE® Extrication Collar

Ref. No.	Size	Width	Length
7930000	Ped-Short	2½"	17"
7930500	Pediatric	3½"	17¾"
7930100	X-Short	2½"	22½"
7930200	Short	3½"	22½"
7930300	Regular	4½"	22½"
7930400	Tall	5½"	22½"

Philadelphia® Collar

Stabilize

Lightweight molded foam with rigid plastic occipital and mandible posts for greater stabilization. Two piece construction for easy application with hook and loop closure. All models are fully radiolucent. Tracheostomy opening in front. Color: Beige



Philadelphia® Collar

2.25" Tall	3.25" Tall	4.25" Tall	Size	Inches
10-622435	10-632432	10-642439	Small	10 - 12"
10-622532	10-622539	10-622536	Medium	13 - 15"
10-622639	10-622636	10-622633	Large	16 - 19"

Suggested HCPCS Code L0172

FLA Universal Cervical Collar

Stabilize

LATEX
FREE
FORMULA

Unique collar design with an extended hook and loop closure adjusts to ensure a proper fit for neck sizes 13" to 19". Polyurethane foam is covered with a soft beige stockinette. Available in two widths. Traditional low contour design maintains the head in a neutral position. Color: Beige

FLA Universal Cervical Collar

Low Contour Reg. Density	Width	Length
10-121033	Narrow 2 1/2"	21"
10-131UNBEG	Regular 3 1/4"	21"

Suggested HCPCS Code L0120



FLA Sized Cervical Collar

Stabilize

LATEX
FREE
FORMULA

Polyurethane foam collars are die cut to specific sizes for improved fit. Foam is covered with a soft beige stockinette. Available in two widths. Traditional low contour design maintains the head in a neutral position. Color: Beige

Sized Cervical Collar - Narrow Width

Narrow Width 2 1/2" Low Contour	Reg. Density	Size	Length
	10-121431	Small	15"
	10-121538	Medium	17"
	10-121635	Large	19"
	10-121732	X-Large	21"

Sized Cervical Collar - Regular Width

Regular Width 3 1/4" Low Contour	Reg. Density	Size	Length
	10-131SMBEG	Small	15"
	10-131MDBEG	Medium	17"
	10-131LGBEG	Large	19"
	10-131ILBEG	X-Large	21"

Suggested HCPCS Code L0120



FLA Sling & Swathe Shoulder Immobilizer

Immobilize

LATEX
FREE
FORMULA

The FLA Sling and Swathe provides comfortable arm immobilization. Blue hook receivable material allows for custom fitting. It is used following surgery, fracture and for surrounding soft tissue injury.

Color: Navy

Features & Benefits

- Securely immobilizes the shoulder
- Soft foam material with terry cloth lining for comfortable wear
- Wide circumferential chest wrap for effective shoulder fixation

FLA Sling & Swathe Shoulder Immobilizer

Ref. No.	Size	Circumference	
7556506	Small	< 43"	
7556507	Medium	43" - 55"	
7556508	Large	55" - 71"	

Measure circumference around upper chest and affected upper arm
Suggested HCPCS Code L3660



Actimove® Eco Shoulder Immobilizer

Immobilize

The Actimove® Eco Shoulder Immobilizer limits abduction, extension and internal and external rotation of the humerus following surgery or fractures. A soft foam neck strap provides patient comfort and a hook and loop closure ensures easy application and removal. Color: Navy

Features & Benefits

- Large envelope
- Soft foam neck strap
- Non-stretch foam neck strap
- Hook fastener on strap
- Thumb loop
- Waist strap



Actimove® Eco Shoulder Immobilizer

Ref. No.	Size	Length	
7281965	Small	13.5" - 15"	
7281966	Medium	14.5" - 17"	
7281967	Large	16.5" - 19"	
7281968	X-Large	> 19"	

Actimove® Sling on a Roll

Immobilize

Stabilize

The Actimove® Sling on a Roll is a convenient immobilization system for the upper extremity. The combination of a strap with the Y-tab hook closures offers users and patients an easy-to-adjust arm support. Custom fit for pediatric or adult with a single product. Color: Navy

Features & Benefits

- 26 yards of strapping
- Stretch resistant foam keeps arm in desired position
- Y-tab hook fasteners allow easy positioning adjustments of the arm
- Strap width remains constant during use which guarantees less compression in the neck

Actimove® Sling on a Roll

Ref. No.	Contents	Quantity
7285918	Set: 13 yds x 2 1/4" roll of strapping; 14 Y-tab hook fasteners	2 sets
7346600	Y-tabs	1 set



FLA Deluxe Clavicle Support

Stabilize

The FLA Deluxe Clavicle Support is indicated for the conservative treatment of clavicle (collarbone) fractures, distortions (sprains), minor instability of the shoulder and postoperative use. It is also recommended for fibromyalgia (painful muscle-tendon disease). Color: Navy

Features & Benefits

- Strong, durable straps ensure stability
- Flat ring construction reduces pressure on the spine
- Extra soft padding is breathable and wicks moisture away for increased comfort
- Quick, easy application with ample closures
- Backpack construction pulls shoulders back to align a clavicle fracture or to provide postural support

FLA Deluxe Clavicle Support

Ref. No.	Size
7623300	X-Small (19 3/4" x 25 7/8")
7623301	Small (25 1/2" x 31 1/2")
7623302	Medium (31 1/2" x 37 1/2")
7623303	Large (37 1/2" x 43 1/2")
7623304	X-Large (43 1/2" x 49")



52 Suggested HCPCS Code L3650

FLA Posture Control Shoulder Brace

Stabilize

LATEX
FREE
FORMULA

Brace is designed to gently keep the shoulders back for proper posture control. High quality canvas back with a soft cotton lining. Four plastic stays on the back panel for extra support. Foam padded shoulder straps for greater comfort. Color: White

FLA Posture Control Shoulder Brace

Ref. No.	Size	Fits
16-42011SSTD	X-Small	20" - 24"
16-420SMSTD	Small	24" - 30"
16-420MDSTD	Medium	30" - 36"
16-420LGSTD	Large	36" - 42"
16-4201LSTD	X-Large	42" - 48"

Measure around chest at the base of the sternum
Suggested HCPCS Code L3650



FLA Safe-T-Sport® Neoprene Shoulder Support

Stabilize

LATEX
FREE
FORMULA

Stabilizes and protects the shoulder to prevent reinjury, while still allowing for flexibility. The sports neoprene material gives comfortable compression and four-way stretch for a proper fit and comfort. Neoprene retains the body's natural heat for therapeutic and soothing warmth to the shoulder joints and surrounding muscles. Adjustable chest and arm closures allow for a custom fit. Built-in pocket holds a reusable hot/cold gel pack (sold separately) in place over the tender joint. Easy to wear under clothing. For correct sizing, measure around the chest. Color: Black.

Features & Benefits

- Protects and supports the shoulder while allowing for flexibility
- Sports neoprene with a soft lining surrounds the shoulder for therapeutic warmth and comfortable compression
- Built-in pocket holds a reusable hot/cold gel pack in place over the tender joint (gel packs sold separately)
- Use an optional thermal gel pack to provide hot or cold therapy
- Adjustable chest and arm closures
- Inconspicuous wear - easy to wear under clothing



FLA Safe-T-Sport® Neoprene Shoulder Support

Ref. No.	Size	Fits
16-500SMBLK	Small	up to 40"
16-500MDBLK	Medium	41" - 50"
16-500LGBLK	Large	51" - 60"

Measure around chest. Fits left or right.
Suggested HCPCS Code A4466

Actimove® Comfort Arm Sling

Stabilize

The Actimove® Comfort Arm sling provides effective vertical, lightweight support to the arm. Its additional neck pad provides extra patient comfort and a hook and loop closure system allows easy application and removal. Color: Navy

Features & Benefits

- Neck pad cushion
- Y-tab hook closure system
- Soft thumb loop
- Large envelope

Actimove® Comfort Arm Sling

Ref. No.	Size	Length 
7281961	Small	13.5" - 15"
7281962	Medium	14.5" - 17"
7281963	Large	16.5" - 19"
7281964	X-Large	> 19"

Suggested HCPCS Code A4565



Actimove® Eco Arm Sling

Stabilize

The Actimove® Eco Arm sling provides effective vertical, lightweight support to the arm. Its soft neck strap provides patient comfort and a hook and loop closure system allows easy application and removal. Color: Navy

Features & Benefits

- Large envelope
- Soft foam neck strap
- Non-stretch foam neck strap
- Hook fastener on strap
- Thumb loop

Actimove® Eco Arm Sling

Ref. No.	Size	Length 
7281957	Small	13.5" - 15"
7281958	Medium	14.5" - 17"
7281959	Large	16.5" - 19"
7281960	X-Large	> 19"

Suggested HCPCS Code A4565



FLA Universal Cradle Arm Sling

Stabilize

LATEX
FREE
FORMULA

Traditional cradle arm sling in an adjustable universal design to fit most patients. Easy, fast and simple application with double D-rings and loop lock closure. Color: Navy.

FLA Universal Cradle Arm Sling

Ref. No.	Size	Fits
28-502UNNVY	Universal	11" - 16"

Measure forearm from elbow to base of little finger.

Suggested HCPCS Code A4565



FLA Cradle Arm Sling

Stabilize

LATEX
FREE
FORMULA

Traditional envelope arm sling comfortably distributes the weight of the arm following surgical or non-surgical treatment of the arm, hand or shoulder. Made in a strong, seamless quality design. Easy, fast and simple application with slide buckle adjustment. Comfort padding on shoulder strap. Available in denim or navy poly/cotton material. Measure forearm from elbow to base of little finger. Color: Denim

FLA Cradle Arm Sling

Ref. No.	Size	Fits	Color
28-3011SDEN	X-Small	9"-11"	Denim
28-301SMDEN	Small	11"-13"	Denim
28-301MDDEN	Medium	13"-14½"	Denim
28-301LGDEN	Large	14½"-15½"	Denim
28-3011LDEN	X-Large	15½" and up	Denim

Measure forearm from elbow to base of little finger

Suggested HCPCS Code A4565



FLA ProLite® Universal Arm Sling

Stabilize

LATEX
FREE
FORMULA

Soft, durable sling material comfortably supports the weight of the arm following injury or surgical treatment of the arm, hand or shoulder. It can be worn with or without a cast. Features a padded, adjustable shoulder strap and thumb loop that limits wrist drop and prevents migration. Universal design fits a range of sizes and right or left arm. Color: Black.

ProLite® Universal Arm Sling

Ref. No.	Size
28-402UNBLK	Universal

Suggested HCPCS Code A4565



FLA Perforated Suede Finish Wrist & Forearm Splint

Immobilize

LATEX
FREE
FORMULA

Recommended when greater immobilization is needed. Stabilizes the wrist following minor fractures, sprains or after cast removal. Made of a durable perforated suede finish material with a cool cotton lining. One wide contoured palmar stay and two dorsal stays. Loop lock closures. Specify right or left. Color: Beige.



FLA Perforated Suede Finish Wrist & Forearm Splint

10" Left Ref. No.	10" Right Ref. No.	Size	Fits
22-441428	22-441419	Small	4½" - 5½"
22-441525	22-441516	Medium	5½" - 6½"
22-441622	22-441613	Large	6½" - 7½"
22-441729	22-441710	X-Large	7½" & up

Measure around the center of the wrist. Specify left or right.

Suggested HCPCS Code L3908

FLA Airflow 8" Wrist Brace

Immobilize

LATEX
FREE
FORMULA

This specially designed wrist brace provides strong support for acute wrist injuries (e.g. acute carpal tunnel syndrome) and chronic wrist instabilities. Made from top quality latex-free materials, this product is highly breathable and comfortable to wear. Color: Black

Features & Benefits

- Anatomical stays immobilize the wrist effectively, helping reduce pain and promote recovery

FLA Airflow 8" Wrist Brace

Ref. No.	Size	Length
7589110	S / M Right Hand	5½" x 7½"
7589112	L / XL Right Hand	7½" x 9½"
7589111	S / M Left Hand	5½" x 7½"
7589113	L / XL Left Hand	7½" x 9½"

Measure around the center of the wrist. Specify left or right.

Suggested HCPCS Code L3908



FLA ProLite® 6" Low Profile Wrist Splint

Immobilize

LATEX
FREE
FORMULA

Provides stabilization and compression to weak or injured wrists. Ideal for sprains, strains, Carpal Tunnel Syndrome and after cast removal. Removable palmar stay and two medial/lateral stays provide maximum support and stabilization, holding the wrist in a neutral position.

Material provides comfortable, continuous compression. Low contour at the palmar crease allows for full finger dexterity and improved grip strength. Breathable spandex insert ensures a proper fit and easy application. Low profile and shorter 6" length for less bulk. Color: Black.

FLA ProLite® 6" Low Profile Wrist Splint

6" Splint Left Ref. No.	6" Splint Right Ref. No.	Size	Fits Wrists
22-471SMBLK	22-470SMBLK	Small	5½" - 6½"
22-471MDBLK	22-470MDBLK	Medium	6½" - 7½"
22-471LGBLK	22-470LGBLK	Large	7½" - 8½"
22-4711LBLK	22-4701LBLK	X-Large	8½" & up

Measure around the center of the wrist. Specify left or right.

Suggested HCPCS Code L3908



FLA Soft Fit Suede Finish

Immobilize

LATEX
FREE
FORMULA

Cock-Up Wrist Brace

Made of comfortable, perforated suede finish material with a soft, padded liner that absorbs moisture. Metal palmar stay holds the wrist in the neutral, "cock-up" position and prevents flexion. Two metal dorsal stays on the back of the brace help prevent extension.

Recommended to support weak or injured wrists, treat wrist strains (slight to moderate wrist sprains), Carpal Tunnel Syndrome or after cast removal.

Easy, one-hand lace pull closure system. Colors: Beige or Black.

Features & Benefits

- Comfortable, firm support for weak or injured elbows
- Unique knit design for precise compression

Soft Fit Suede Finish Cock-Up Wrist Brace

Beige Left Ref. No.	Beige Right Ref. No.	Black Left Ref. No.	Black Right Ref. No.	Size	Fits Wrists
22-1511SBEG	22-1501SBEG	22-1511SBLK	22-1501SBLK	X-Small	under 4½"
22-151SMBEG	22-150SMBEG	22-151SMBLK	22-150SMBLK	Small	4½" - 5½"
22-151MDBEG	22-150MDBEG	22-151MDBLK	22-150MDBLK	Medium	5½" - 6½"
22-151LGBEG	22-150LGBEG	22-151LGBLK	22-150LGBLK	Large	6½" - 7½"
22-1511LBEG	22-1501LBEG	22-1511LBLK	22-1501LBLK	X-Large	7½" & up

58 Measure around the center of the wrist. Specify left or right.

Suggested HCPCS Code L3908



FLA ProLite® 8" Wrist Splint

Immobilize

LATEX
FREE
FORMULA

Best Fitting Splint Available! Provides immobilization for weak or injured wrists. Ideal for sprains, strains or after cast removal. Made of a cool and breathable open cell foam material with interlock poly cover. Provides comfortable, continuous compression. Low contour at palmar crease allows for full finger dexterity and improved grip strength. Removable palmar stay and two medial/lateral stays provide maximum support and immobilization. Loop lock closures and elastic insert assure proper fit and easy one hand application. Specify right or left. Color: Black



FLA ProLite® 8" Wrist Splint

8" Splint Left Ref. No.	8" Splint Right Ref. No.	Size	Fits Wrists
22-4511SBLK	22-4501SBLK	X-Small	4½" - 5½"
22-451SMBLK	22-450SMBLK	Small	5½" - 6½"
22-451MDBLK	22-450MDBLK	Medium	6½" - 7½"
22-451LGBLK	22-450LGBLK	Large	7½" - 8½"
22-4511LBLK	22-4501LBLK	X-Large	8½" & up

Measure around the center of the wrist. Specify left or right.
Suggested HCPCS Code L3908

FLA Uni-Fit® Universal Wrist Splint

Immobilize

LATEX
FREE
FORMULA

Made of soft foam with a wide palmar and movable dorsal stays. Loop lock closures ensure proper fit and easy application. Extremely low profile, ultra thin, breathable foam with smooth lycra lining. Unique design fits a wide range of sizes and left or right arm. Dorsal stays can be removed to give less immobilization as healing progresses. Eight inch length. Color: Black.
Universal Size - Fits Right or Left.



FLA Uni-Fit® Universal Wrist Splint

Ref. No.	Fits Wrist
22-602UNBLK	5"-11"

Measure around the center of the wrist.
Suggested HCPCS Code L3908

FLA HealWell™ Grip Splint WHFO

Wrist / Hand / Finger Orthosis

Immobilize

LATEX
FREE
FORMULA

Maintains a neutral position of the hand, reducing wrist flexion and increasing extension of the fingers. Holds the hand open, preventing finger flexion and damage to the palmar skin.

Color: Blue.

Indications:

- Mild/moderate non-fixed contractures of the hand, wrist and fingers
- Therapeutic positioning of paralyzed or injured hand or wrist
- Particularly useful after injury, stroke or disease to prevent contracture and protect the hand and wrist

FLA HealWell™ Grip Splint WHFO

Ref. No.	Size	Fits
25-800000	Universal	Left or Right

The HealWell® Grip Splint (WHFO) is supplied with two palmar rolls in 1.5" and 1.75" diameters to accommodate various levels of finger contracture or hand sizes and/or offer progressive extension of the fingers.

Suggested HCPCS Code L3809



FLA CarpalMate® Wrist Support

CarpalMate® is a lightweight wrist support designed to maintain the wrist in a neutral position while allowing full finger dexterity. Prevents the wrist from dropping and prevents excess thumb and little finger opposition. Controlling these motions will prevent excess flexion of the wrist and finger flexor tendons thus avoiding overuse. The support is held in place by a wide elastic strap that provides comfortable compressive support at the wrist. Ideal for Carpal Tunnel Syndrome. Colors: Black or Beige.

Stabilize

LATEX
FREE
FORMULA

Carpalmate® is ideal for activities that require repetitive, stressful motions such as:

- Typing
- Data Entry
- Small Parts Assembly

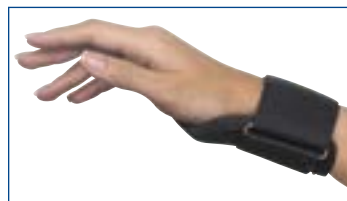

FLA CarpalMate® Wrist Support

Black Ref. No.	Beige Ref. No.	Size
22-140UNBLK	22-140UNBEG	Universal

60 Fits right or left
Suggested HCPCS Code L3908

FLA Soft Form® Elegant Wrist

Stabilize

LATEX
FREE
FORMULA

Provides light support to weak or injured wrists. It is ideal for treatment of Carpal Tunnel Syndrome, arthritis, mild wrist strains or sprains and weak or aching wrists. Has one metal palmar stay to help maintain the wrist in a neutral position. The base is made of a unique, soft fleece-lined Spandex material. The sleek, low-profile design also has a low palmar crease for full finger dexterity. Color: Beige. Specify right or left.

FLA Soft Form® Elegant Wrist Support

Left Ref. No.	Right Ref. No.	Size	Fits Wrists
22-5611SBLK	22-5601SBLK	X-Small	4½" - 5½"
22-561SMBLK	22-560SMBLK	Small	5½" - 6¼"
22-561MDBLK	22-560MDBLK	Medium	6¼" - 7"
22-561LGBLK	22-560LGBLK	Large	7" - 7¾"
22-5611LBLK	22-5601LBLK	X-Large	7¾" & up

Measure around the center of the wrist. Specify left or right.
Suggested HCPCS Code L3908



FLA Elastic 6" Wrist Brace

Stabilize

LATEX
FREE
FORMULA

Features & Benefits

- Lightweight elastic support with stretch compression
- Wide, malleable and removable palmar stay
- Stay positions wrist in cock-up or cock-down position
- Low profile design - maximum grip strength and finger dexterity
- One-hand hook and loop closures
- Color: Beige

FLA Elastic Wrist Brace

Left Ref. No.	Right Ref. No.	Size	Fits Wrists
22-2011SSTD	22-2001SSTD	X-Small	Under 4½"
22-201SMSTD	22-200SMSTD	Small	4½" - 5½"
22-201MDSTD	22-200MDSTD	Medium	5½" - 6½"
22-201LGSTD	22-200LGSTD	Large	6½" - 7½"
22-2011LSTD	22-2001LSTD	X-Large	7½" & up

Measure around the center of the wrist. Specify left or right.
Suggested HCPCS Code L3908



FLA Neoprene Wrist Wrap

Support

LATEX
FREE
FORMULA

Neoprene wrist wrap with adjustable closure fits a wide range of sizes and fits right or left wrist. Provides lightweight support and soothing warmth to aching, fatigued or weak wrists. Made of lightweight neoprene with a soft nylon loop lining. Universal size. Color: Navy.



FLA Neoprene Wrist Wrap

Ref. No.	Size	Color
22-109UNNVY	4" - 11"	Navy
22-109UNBLK	4" - 11"	Black

Measure around the center of the wrist
Suggested HCPCS Code A4466

FLA Elastic Pullover Wristlet

Support

LATEX
FREE
FORMULA

Durable lightweight knitted elastic provides support with flexibility. Seamless construction will not irritate skin. Easy slip on style. Color: Beige.



FLA Elastic Pullover Wristlet

Ref. No.	Size	Fits
22-103SMBEG	Small	5" - 6"
22-103MDBEG	Medium	6" - 7"
22-103LGBEG	Large	7" - 8½"
22-1031LBEG	X-Large	8½" & up

Measure around center of wrist
Suggested HCPCS Code A4466

FLA 8" Airflow Wrist Brace

with Abducted Thumb

This specially designed wrist & thumb brace provides strong support for acute wrist & thumb injuries (e.g. skiers thumb) and chronic instabilities. Made from top quality, latex-free materials, this product is highly breathable and comfortable to wear.

Features & Benefits

- Secure thumb closure for greater immobilization
- Anatomical stays immobilize the wrist & thumb effectively, helping reduce pain

FLA 8" Wrist Brace with Abducted Thumb

Ref. No.	Size	Length
7571850	S / M Right Hand	5 1/2" x 7 1/2"
7571851	L / XL Right Hand	7 1/2" x 9 1/2"
7571852	S / M Left Hand	5 1/2" x 7 1/2"
7571853	L / XL Left Hand	7 1/2" x 9 1/2"

Measure around the center of the wrist. Specify left or right.

Suggested HCPCS Code L3809



Immobilize

LATEX
FREE
FORMULA

FLA C3™ Deluxe Thumb Splint

Supports and limits the motion of the thumb joints. Also comfortably supports the wrist and prevents rotation. Ideal for DeQuervain's Syndrome, tendinitis, arthritis and sports injuries. Made of unique C3™ Tri-Laminate material making it cool and comfortable to wear. Allows for changes in the amount of swelling. The anatomically conforming stay and closures help restrict movement and provide maximum support. Universal size. Fits either left or right. Color: Black.

FLA C3™ Deluxe Thumb Splint

Ref. No.	Size	Fits
25-170002	5" - 11"	Universal

Measure around center of wrist

Suggested HCPCS Code L3924



Immobilize

LATEX
FREE
FORMULA

FLA Soft Fit Thumb Spica

Immobilize

LATEX
FREE
FORMULA

Anatomically designed to ensure a comfortable fit. Perspiration is absorbed by a self wicking lining and increased ventilation is provided by perforated blue foam. Ideal for arthritis, DeQuervain's Syndrome, tendinitis and post thumb injuries. Closure straps are stretchable for ease of application and removal. Universal size fits either left or right. Color: Navy/Black.



FLA Soft Fit Thumb Spica

Ref. No.	Size
25-120UNNVY	Universal

Suggested HCPCS Code L3999

FLA ProLite® Wrist Splint

Immobilize

LATEX
FREE
FORMULA

with Abducted Thumb

Recommended when immobilization of the wrist and/or thumb is needed. Semi-rigid Thumb Spica portion is contoured to provide intimate support, immobilization and thumb abduction. The unique design of the foam spica protects the thumb from impact or shock without any uncomfortable binding or stitch seams. The splint has a metal palmar and a dorsal stay to prevent flexion and extension. Recommended for post-surgical treatment of wrist and thumb injuries. Especially for treatment of Basal Joint Arthritis, DeQuervain's Tenosynovitis, tendinitis, accumulative trauma disorders of the thumb and wrist, severe wrist sprains, strains / sprains of the thumb joint (MCP), advanced Carpal Tunnel Syndrome, or after cast removal. Color: Black. Specify right or left.



FLA ProLite® Wrist Splint with Adducted Thumb

8" Splint Left Ref. No.	8" Splint Right Ref. No.	Size	Fits Wrists
22-4611SBLK	22-4601SBLK	X-Small	4 1/2" - 5 1/2"
22-461SMBLK	22-460SMBLK	Small	5 1/2" - 6 1/2"
22-461MDBLK	22-460MDBLK	Medium	6 1/2" - 7 1/2"
22-461LGBLK	22-460LGBLK	Large	7 1/2" - 8 1/2"
22-4611LBLK	22-4601LBLK	X-Large	8 1/2" & up

Measure around the center of the wrist. Specify left or right.

Suggested HCPCS Code L3908

FLA Tether® Thumb Stabilizer

Stabilize

LATEX
FREE
FORMULA

Helps support and limit the motion of the MCP joint of the thumb. Ideal for use on soft tissue injuries, ligament strains, Gamekeeper's thumb, osteoarthritis, and degenerative joint disease. Allows for full finger dexterity. Thermal lining provides warmth to the thumb area and joint. Wrist wrap is made of a soft, cool and breathable material. Made of conforming genuine leather. Color: Black.



FLA Tether® Thumb Stabilizer

Left Ref. No.	Right Ref. No.	Size	Fits Hands
22-161SMBLK	22-160SMBLK	Small	2 1/4" - 2 3/4"
22-161MDBLK	22-160MDBLK	Medium	2 3/4" - 3 1/4"
22-161LGBLK	22-160LGBLK	Large	3 1/4" - 3 3/4"

Measure width of hand. Specify left or right.
Suggested HCPCS Code L3999

FLA ProLite® Neoprene Pull-On Thumb Support

Support

LATEX
FREE
FORMULA

Provides warmth and uniform compression to aching or injured thumbs and wrists. Compression helps reduce pain, inflammation, and swelling while providing support to soft tissues. Indicated for arthritis, bursitis, tendinitis, repetitive motion or soft tissue injuries, and general muscle soreness. Colors: Black or Beige.



Features & Benefits

- **Full thumb coverage** - Neoprene applies soothing warmth to all the joints of the thumb.
- **Contoured shape** - Allows for full use of hand.
- **Soft nylon terry lining** - Works with soft stitching to give a seamless feel.

FLA ProLite® Neoprene Pull-On Thumb Support

Black Ref. No.	Beige Ref. No.	Size	Fits
25-130SMBLK	25-130SMBEG	Small	5 1/2" - 6"
25-130MDBLK	25-130MDBEG	Medium	6" - 6 1/2"
25-130LGBLK	25-130LGBEG	Large	6 1/2" - 7"
25-1301LBLK	25-1301LBEG	X-Large	7" - 8"

Measure around center of wrist.
Suggested HCPCS Code A4466

FLA GelBand® Arm Band

Support

LATEX
FREE
FORMULA

This arm band provides the ideal in therapeutic support - conforming compression without restricting circulation. Use this support to treat common injuries like tennis or golfer's elbow. Provides relief from arthritis, Carpal Tunnel Syndrome, strains and sprains. Unique GelCell® can be cooled or heated for therapy on acute or chronic injuries.
Colors: Black or Beige.



FLA GelBand® Arm Band

Beige Ref. No.	Black Ref. No.	Size	Fits Forearm
19-5001SBEG	19-5001SBLK	X-Small	7" - 11"
19-500UNBEG	19-500UNBLK	Universal	11" - 16"

Measure around forearm
Suggested HCPCS Code A4466

FLA Epi-Sport® Epicondylitis Clasp

Support

LATEX
FREE
FORMULA

This specially designed clasp provides targeted compression to the long tendons of the forearm extensor and flexor muscles. Dual action compression works simultaneously to treat Lateral and/or Medial Epicondylitis (forehand and backhand tennis elbow) without restricting circulation. This low profile product is extremely lightweight and comfortable to wear without any pinch points. The shock absorbing liner also helps wick moisture away from skin. Color: Black.



FLA Epi-Sport® Epicondylitis Clasp

Ref. No.	Size	Fits
19-6001SBLK	X-Small	8" - 9"
19-600SMBLK	Small	9" - 10"
19-600MDBLK	Medium	10" - 11"
19-600LGBLK	Large	11" - 12"
19-6001LBLK	X-Large	12" - 13½"

Measure around forearm 1.5" - 2" below elbow
Suggested HCPCS Code A4466

FLA Canvas Tennis Elbow Strap

Support



Features & Benefits

- Canvas outer with cool cotton lining
- Tapered design
- Loop lock closure/plastic guide

FLA Canvas Tennis Elbow Strap

Ref. No.	Size	Length
19-201UNSTD	Universal	11" - 16"
19-2011SSTD	X-Small	7" - 11"

Measure around upper forearm
Suggested HCPCS Code A4466



FLA ProLite® Elbow Support

Support



Knitted Pullover

Provides support and compression to strained tendons/muscles or injured elbows. Made of a stretch knitted elastic that is a lightweight and breathable alternative to neoprene. Gives compressive support while maintaining flexibility. Color: Beige.

Features & Benefits

- Comfortable, firm support for weak or injured elbows
- Unique knit design for precise compression

FLA ProLite® Elbow Knitted Pullover

Ref. No.	Size	Fits
19-400SMBEG	Small	8" - 9"
19-400MDBEG	Medium	9" - 10"
19-400LGBEG	Large	10" - 11½"
19-4001LBEG	X-Large	11½" - 13"

Measure around the arm just above elbow
Suggested HCPCS Code A4466



FLA Compressive Elbow Support

with Viscoelastic Insert

Support

LATEX
FREE
FORMULA

For swollen or tender elbows resulting from sprains, strains, overuse or sports injuries like tennis and golfer's elbow. Contains one viscoelastic insert positioned on the tendon below the elbow joint. Made of lightweight, breathable knit material. Will not retain excessive body heat. Color: White/blue.



FLA Compressive Elbow Support with Viscoelastic Insert

Ref. No.	Size	Fits
19-4501SSTD	X-Small	9" - 10"
19-450SMSTD	Small	10" - 11"
19-450MDSTD	Medium	11" - 12"
19-450LGSTD	Large	12" - 13"
19-4501LSTD	X-Large	13" - 14"

Measure around arm 3" above elbow joint
Suggested HCPCS Code A4466

FLA Elastic Pullover Elbow Support

Support

LATEX
FREE
FORMULA

Features & Benefits

- Durable lightweight knitted elastic
- Support with flexibility
- Seamless construction won't irritate skin

Color: White.

Elastic Pullover Elbow Support

Ref. No.	Size	Fits
19-501SMSTD	Small	8½" - 10"
19-501MDSTD	Medium	10" - 11½"
19-501LGSTD	Large	11½" - 13"
19-5011LSTD	X-Large	13½" - 15"

Measure around upper forearm.
Suggested HCPCS Code A4466



FLA Neoprene Elbow Sleeve

with Loop Lock

Support

LATEX
FREE
FORMULA

Features & Benefits

- Neoprene for therapeutic warmth
- Soft nylon loop lining
- Added strap gives greater support
- Loop lock closure/plastic guide
- Color: Navy and Black



Neoprene Elbow Sleeve with Loop Lock

Navy Ref. No.	Black Ref. No.	Size	Fits
19-601SMNVY	19-601SMBLK	Small	7" - 9"
19-601MDNVY	19-601MDBLK	Medium	9" - 10½"
19-601LGNVY	19-601LGBLK	Large	10½" - 13½"
19-6011LNVY	19-6011LBLK	X-Large	13½" - 15"

Measure 3" below center of elbow.

Suggested HCPCS Code A4466

FLA Two-Panel Surgical Rib Belts

Support

LATEX
FREE
FORMULA

For Women and Men

Two-panel surgical rib belts help stabilize rib and sternum fractures by limiting expansion through compression. They provide comfort and encourage more controlled breathing to help reduce pain. Rib belts also provide support and compression to the muscles and soft tissues of the rib cage weakened by strain, trauma, overuse, inactivity, or surgery. Female rib belt is designed with a contoured fit around the bust line. Universally sized. Color: White.



FLA Two-Panel Surgical Rib Belts

Male Ref. No.	Female Ref. No.	Size	Fits Chest
34-4100	34-4200	Universal	24" - 48"

Measure around chest at base of the sternum
Suggested HCPCS Code A4466

FLA Three & Four-Panel Abdominal Binders

Support

LATEX
FREE
FORMULA

For Women and Men

Abdominal Binders provide support and compression to abdominal muscles weakened by strain without restricting breathing or muscle redevelopment. 4 Panel (12" Height) for taller patients or long line surgeries. Color: White



FLA Three & Four Panel Surgical Abdominal Binders

9" 3-Panel Ref. No.	12" 3-Panel Ref. No.	Size	Fits Chest
34-6304	34-6404	Small	30" - 45"
34-6305	34-6405	Medium	46" - 62"
34-6306	34-6406	Large	60" - 75"

Measure around fullest part of the abdomen
Suggested HCPCS Code L0625

FLA LO•Plus™ Lumbar Support

with Stabilizing Posterior Panel

This support provides stability to the lumbar region to relieve lower back pain and discomfort. Ideal for occasional or chronic back pain, lumbar sprains / strains, lumbar instability, muscle weakness and postural support.

- Rigid posterior panel provides strength and stability to the lumbar region
- Ultra-thin, low profile for comfortable, inconspicuous wear
- Tapered panels contour the body for excellent compression and support
- Easy application with simple hook and loop closures

FLA LO•Plus™ Lumbar Support with Stabilizing Posterior Panel

Ref. No.	Size	
7456300	Small 24" - 28"	
7456301	Medium 29" - 33"	
7456302	Large 34" - 39"	
7456303	X-Large 40" - 44"	
7456304	XX-Large 45" - 49"	
7456305	XXX-Large 50" - 55"	

Measure around waist at navel
Suggested HCPCS Code L0641



Stabilize

LATEX
FREE
FORMULA

FLA Deluxe Lumbar Support

11" Height

Alleviates pain caused from muscle strain by relieving stress on the lower spine. This popular support is exceptionally strong and durable. Back panel is made of perforated vinyl with a soft cotton lining. Strength is achieved with four contoured rigid stays that can be shaped for a customized fit. Double front closures are made of high quality elastic and soft foam. Color: White.

Deluxe Lumbar Support 11" Height

Ref. No.	Size	Fits
31-101SMSTD	Small	25" - 34"
31-101MDSTD	Medium	32" - 42"
31-101LGSTD	Large	38" - 54"
31-1011LSTD	X-Large	44" - 48"

Measure around hips just below waistline
Suggested HCPCS Code L0625



Stabilize

LATEX
FREE
FORMULA

FLA 9" Neoprene Lumbar Sacral Support

Support

LATEX
FREE
FORMULA

This support provides compression to the lumbar sacral and abdominal regions, stabilizing and supporting these areas to provide relief from lower back pain and discomfort. Color: Black.

Indications:

- Occasional or Chronic Back Pain
- Muscle Strain
- Lumbar Sprain/Strain
- Sacral Contusion

Features & Benefits

- 9" high neoprene back panel provides therapeutic warmth
- Tapered panels contour the body for excellent compression and support
- Ventilated side panels for comfortable support
- Flexible stays provide strength and stability to the lumbar region and prevent the belt from rolling
- Low profile for inconspicuous wear underneath clothing
- Easy application with simple hook and loop closures



9" Neoprene Lumbar Sacral Support

Ref. No.	Size	Fits
31-722SMBLK	Small	28" - 32"
31-722MDBLK	Medium	33" - 36"
31-722LGBLK	Large	37" - 40"
31-7221LBLK	X-Large	41" - 44"
31-7222LBLK	XX-Large	45" - 48"

Measure around hips just below waistline

Suggested HCPCS Code L0625

FLA 7" Cool-Lightweight Lumbar Sacral Support

Support

LATEX
FREE
FORMULA

Ideal for lightweight lumbar support. Lower height is great for shorter and smaller patients. Made of high quality seven inch high, latex free elastic. Four flexible plastic stays in the back provide support to the lumbar region. Four-inch wide tapered breathable elastic bands overlap and give a contouring shape to most body types. Soft plush finish. Easy hook and loop closure. Color: White



7" Cool-Lightweight Lumbar Sacral Support

Ref. No.	Size	Fits
31-701SMSTD	Small	28" - 32"
31-701MDSTD	Medium	33" - 36"
31-701LGSTD	Large	37" - 40"
31-7011LSTD	X-Large	41" - 44"

Measure around hips just below waistline

Suggested HCPCS Code L0625

FLA Lumbar Sacral Support

Support

LATEX
FREE
FORMULA

with Abdominal Belt, 10" Height

High quality ten inch high elastic with soft foam and hook and loop closures that adjust for the most comfortable and easy fit. Uniquely designed with an overlapping belt to provide additional lift in the abdominal area. Four flexible stays in the back and sides provide extra support and prevent the belt from rolling. One model is available with a foam pad for added compression in the center of the lumbar area. Available in our popular universal design or fitted sizes. Color: White.



Lumbar Sacral Support with Abdominal Belt, 10" Height

Overlap Abdominal Belt Ref. No.	Size	Fits
31-208UNSTD	Universal	33" - 48"
31-208SMSTD	Small	28" - 32"
31-208MDSTD	Medium	33" - 36"
31-208LGSTD	Large	37" - 40"
31-2081LSTD	X-Large	41" - 44"
31-2082LSTD	XX-Large	45" - 48"
31-2083LSTD	XXX-Large	49" - 52"
31-2084LSTD	XXXX-Large	53" - 56"

Measure around the center of the wrist. Specify left or right.

Suggested HCPCS Code L0625

FLA Sacral Iliac Support

Support

LATEX
FREE
FORMULA

with Compression Pad 6" Height

Six inch high support provides compression to the sacral iliac region. Has a removable stockinette covered foam compression pad with a rigid back. Contoured in front to fit around the hips. Adjustable hook and loop closure. Available in a universal design or fitted sizes. Color: White.



Sacral Iliac Support with Compression Pad 6" Height

Ref. No.	Size	Fits
31-801008	Universal	33" - 43"
31-801406	Small	28" - 32"
31-801503	Medium	33" - 36"
31-801600	Large	37" - 40"
31-801707	X-Large	41" - 44"
31-801804	XX-Large	45" - 48"

Measure around hips just below waistline

Suggested HCPCS Code L0621

FLA Thermal Lumbar Support

Support

LATEX
FREE
FORMULA

Reusable hot/cold gel pack for treatment of minor back aches and pains resulting from sprains, muscle soreness and strains, cramping, or contusion (bruising). Stabilizes and supports the lumbar sacral region to help provide relief from lower back pain and discomfort. Color: Black.



Indications:

- Reusable thermal gel provides penetrating hot or cold therapy.
- Mesh pocket holds reusable hot/cold thermal gel insert over lower lumbar region.
- Support gives an ultimate tapered fit without binding or rolling.
- Plush, ventilated elastic panels – lightweight elastic with a unique ventilated filament stitch provides cool and comfortable compression.

Panels overlap and give a contouring shape to most body types.

- Easy hook and loop closure.

Thermal Lumbar Support

Ref. No.	Size	Fits
31-7504	Small	28" - 32"
31-7505	Medium	33" - 36"
31-7506	Large	37" - 40"
31-7507	X-Large	41" - 44"

Measure around the fullest part of the abdomen.

Suggested HCPCS Code L0625

FLA Breathable Universal Tri-Panel Knee Immobilizer

Immobilize

LATEX
FREE
FORMULA

Popular universal knee immobilizer has adjustable side panels to fit a range of sizes. Made of a blue perforated mesh material laminated to a soft, light gray medical grade foam. Lateral and medial stays increase stability. Immobilization created with contoured posterior stays. Easy loop lock closures. Universal size.



Breathable Universal Tri-Panel Foam Knee Immobilizer

14" Length Ref. No.	16" Length Ref. No.	18" Length Ref. No.	20" Length Ref. No.	22" Length Ref. No.	24" Length Ref. No.
37-614008	37-616006	37-618004	37-620009	37-622007	37-624005

Universal size fits 13"-26". Measure around leg 4" above center of kneecap.
Suggested HCPCS Code L1830

FLA Breathable Universal Cutaway Knee Immobilizer

Immobilize

LATEX
FREE
FORMULA

Practical universal knee immobilizer can be cut to fit a range of sizes. Movable medial and lateral stays can be placed in desired position. Made of a blue perforated mesh material laminated to a soft, light gray medical grade foam. Immobilization created by posterior stays. Easy loop lock closures. Includes a removable elastic patella closure. Universal size - trimmable.



Breathable Universal Cutaway Knee Immobilizer

14" Length Ref. No.	16" Length Ref. No.	18" Length Ref. No.	20" Length Ref. No.	22" Length Ref. No.
37-714007	37-716005	37-718003	37-720008	37-724004

Universal size fits up to 23". Measure around leg 4" above center of kneecap.
Suggested HCPCS Code L1830

FLA Specter® ROM Standard

Immobilize

Stabilize

LATEX
FREE
FORMULA

Standard Specter® ROM provides post-operative immobilization and range of motion needed after ACL, PCL, MCL and LCL surgeries.

SPECTER® HINGE
All Specter® ROM Braces have a spring loaded snap-lock hinge to make ROM adjustments quick and easy. For patient lock-out, use the optional hex screw. Range of motion increments are in 7.5 degrees.



Use with or without optional Patient Lock-Out

Spring loaded snap-lock for easy setting

Features & Benefits

- Strong durable hinge with snap-lock design and optional patient lock-out
- 7.5 degree incremental flexion/extension settings
- Integrated strap/strut design
- Conformable aluminum struts for varus/valgus position
- Breakdown conversion to shorter 4-strap design

FLA Specter® ROM Standard Knee Brace

Ref. No.	Size
37-0170	Universal

Suggested HCPCS Code L1833



FLA Specter® ROM Cool / Lightweight

Cool and lightweight variation of the Standard Specter® ROM. Ideal for warmer climates and long term wear.

FLA Specter® ROM Cool / Lightweight

Ref. No.	Size
37-0174	Universal

Suggested HCPCS Code L1833



FLA Specter® ROM Short

Short version of Standard Specter® ROM. Ideal for post-operative patients during rehabilitation. Shorter length is more comfortable for ambulatory patients.

FLA Specter® ROM Short

Ref. No.	Size
37-0176	Universal

76 Suggested HCPCS Code L1833



FLA Adjustable ROM Knee Brace

Indications

- Mild to moderate ligament strains and sprains (ACL/PCL/MCL/LCL)
- Meniscal strains and tears
- Medial/lateral knee instability
- Chronic knee instability
- Post-op range of motion control

Features & Benefits

- Polycentric Range of Motion Hinges allow for progressive rehabilitation. Flexion and extension settings can be adjusted in 20 degree increments to control movement of the joint, preventing further injury and speeding healing. Dual axis, polycentric hinges track more closely with the knee motion and provide medial and lateral stabilization.
- Tri-Permalon™ Material is latex free, neoprene free and is ideal for those with sensitive skin or who are susceptible to heat build-up. Durable outer material is hook compatible and allows wrap closures to be placed anywhere on the support and gives excellent strength and support. Inner breathable foam material does not retain body heat. Allows for cool and comfortable wear. Smooth lycra lining is comfortable against the skin and provides power stretch for compressive support.
- Universal Two-Way Adjustable Straps fit a wide range of sizes, create a custom-like fit, and gives an improved fit that stays in place.
- Open Popliteal eliminates bunching and irritation behind the knee.
- Wrap-Around Design for easy application over swollen, tender joints.



FLA Adjustable ROM Knee Brace

Ref. No.	Size	Fits
37-450UNBLK	Universal Regular	12" - 20"
37-4501LBLK	Universal Plus	18" - 26"

Measure around center of kneecap. Brace fits right or left knee.
Suggested HCPCS Code L1833

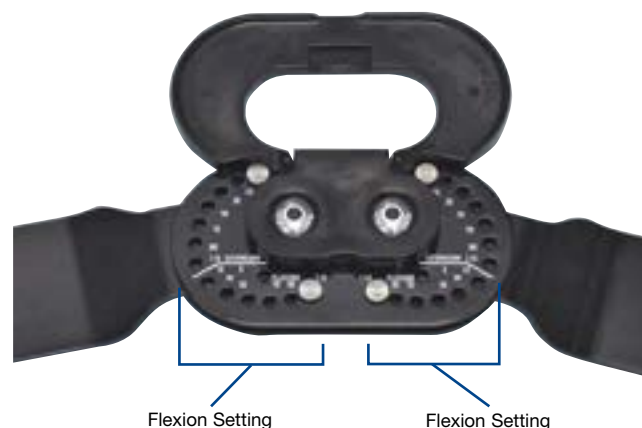

**IMPORTANT: Verify that both hinges are set at the same amount of flexion and extension.

FLA Airflow Wrap-Around Hinged Knee Brace

Stabilize

LATEX
FREE
FORMULA

This specially designed Wrap-Around Knee Brace provides good stabilization and gives a feel of comfort and security. The Neoprene-Free fabric is breathable, gives good compression and is very comfortable to wear.

Features & Benefits

- Advanced Wrap-Around Design for quick and easy adjustment, ideal for swollen and injured knees and helps prevent slipping.
- Polycentric hinges guide the knee movements, allowing full flexion of the knee, while reducing the risk for hyperextension.

FLA Airflow Wrap-Around Hinged Knee Brace

Ref. No.	Size	Fits
7568925	X-Small	12" - 13½"
7568926	Small	14" - 15½"
7568927	Medium	16" - 17½"
7568928	Large	18" - 19½"
7568929	X-Large	20" - 21½"
7568930	XX-Large	22" - 23½"
7568931	XXX-Large	24" - 25½"

Measure around leg 4" above center of kneecap
Suggested HCPCS Code L1812



FLA Safe-T-Sport® Wrap-Around Hinged Knee Brace

Stabilize

LATEX
FREE
FORMULA

Sports neoprene provides consistent compression and four-way stretch for proper fit and comfort. Neoprene retains the body's natural heat to provide therapeutic and soothing warmth to joints and muscles. Indicated for slight to moderate ligament sprains and tears, medial/lateral meniscal tears, arthritis and knee joint instability. Durable hinges give medial and lateral stabilization to the knee and allow for full knee flexion with hyperextension stops. Color: Black.

Features & Benefits

- Sports neoprene with four-way stretch compression
- Front wrap closures for quick, easy application - especially easy to apply over tender or swollen knees
- Medial/lateral metal hinges allow for full flexion and prevent hyperextension
- Open behind the knee to help prevent bunching and improve comfort
- Two adjustable support straps



FLA Safe-T-Sport® Wrap-Around Hinged Knee Brace

Ref. No.	Size	Fits
37-3501SBLK	X-Small	12" - 13"
37-350SMBLK	Small	14" - 15"
37-350MDBLK	Medium	16" - 17"
37-350LGBLK	Large	18" - 19"
37-3501LBLK	X-Large	20" - 21"
37-3502LBLK	XX-Large	22" - 23"
37-3503LBLK	XXX-Large	24" - 25"

Measure around leg 4" above center of kneecap
Suggested HCPCS Code L1812

FLA Neoprene Patella Stabilizer

with Removable Horseshoe

Stabilize

LATEX
FREE
FORMULA

This stabilizer comes with a removable horseshoe that can be adjusted superiorly, inferiorly, medially or laterally depending on the stability needs of the knee. The horseshoe provides increased pressure around the patella for patellar tracking problems. Medial/lateral stability is provided by the spiral stays.

Indications:

- Chondromalacia Patella
- Patellar Instability
- Infra and Subpatellar Bursitis
- Patellar/Pain Syndrome
- Lateral Tracking Patella
- Patellar Subluxation
- Osgood-Schlatter Disease
- Patellar Tendonitis

Features & Benefits

- Four way stretch for proper fit and comfort
- Sports neoprene for therapeutic warmth
- Adjustable support straps
- Horseshoe support, spiral stays
- Easy slip-on style

FLA Neoprene Patella Stabilizer with Removeable Horseshoe

Navy Ref. No.	Black Ref. No.	Size	Fits
37-1031SNVY	37-1031SBLK	X-Small	12" - 13"
37-103SMNVY	37-103SMBLK	Small	14" - 15"
37-103MDNVY	37-103MDBLK	Medium	16" - 17"
37-103LGNVY	37-103LGBLK	Large	18" - 19"
37-1031LNVY	37-1031LBLK	X-Large	20" - 21"
37-1032LNVY	37-1032LBLK	XX-Large	22" - 23"
37-1033LNVY	37-1033LBLK	XXX-Large	24" - 25"

Measure around leg 4" above center of kneecap.

Suggested HCPCS Code A4466



FLA Lateral Knee Stabilizer

Stabilize

LATEX
FREE
FORMULA

with "J" Shaped Buttress

The Safe-T-Sport® Lateral Knee Stabilizer with "J" Shaped Buttress provides excellent side-to-side support of the knee and stabilization of the kneecap. Indicated for conditions such as: Chondromalacia, pain from lateral pressure syndrome, patella instabilities, lateral patellofemoral malalignment, and lateral dislocation. Color: Black.

Sports Neoprene

Neoprene has soft, long loop nylon lining for comfortable wear. Durable enough for wear during sports. Sports neoprene provides consistent compression and therapeutic warmth to joints and muscles.

Tubular "J" Buttress

Maintains proper alignment of the patella (kneecap). Provides lateral side support and stabilization.

Adjustable Support Straps

Straps adjust medially for an adjustable amount of compression and increased stability. The unique angle of the straps creates extra support compression across the lateral "J" buttress for increased stabilization.

Flexible Stays

Spiral stays provide medial and lateral stability while maintaining full range of motion.



FLA Lateral Knee Stabilizer with "J" Shaped Buttress

Left Ref. No.	Right Ref. No.	Size	Fits
37-2511SBLK	37-2501SBLK	X-Small	12" - 13"
37-251SMBLK	37-250SMBLK	Small	14" - 15"
37-251MDBLK	37-250MDBLK	Medium	16" - 17"
37-251LGBLK	37-250LGBLK	Large	18" - 19"
37-2511LBLK	37-2501LBLK	X-Large	20" - 21"
37-2512LBLK	37-2502LBLK	XX-Large	22" - 23"
37-2513LBLK	37-2503LBLK	XXX-Large	24" - 25"

Measure around leg 4" above center of kneecap.

Suggested HCPCS Code A4466

FLA Soft Form Wrap-Around Stabilizing Knee Support

Stabilize

LATEX
FREE
FORMULA

INDICATIONS:

- Slight to moderate ligament sprains and strains
- Tendinitis of the knee
- Arthritis
- Knee joint instability

Features & Benefits

- Unique Breathable Foam Material is latex free and neoprene free. Provides compression with a soft plush fabric against the skin. Non-irritating for those with sensitive skin.
- Wrap-Around Design is ideal for swollen or injured knees – quick and easy to apply.
- Flexible Spiral Stays provide medial and lateral (side-to-side) stability of the knee joint.
- Open Popliteal eliminates bunching and irritation behind the knee.
- Condyle Pads offer additional padding and stabilization to the patella.
- Adjustable Support Straps for an improved fit that stays in place.
- Latex free and Neoprene free.

Color: Beige



FLA Soft Form® Wrap-Around Stabilizing Knee Support

Ref. No.	Size	Fits
37-3031SBEG	X-Small	12" - 13"
37-303SMBEG	Small	14" - 15"
37-303MDBEG	Medium	16" - 17"
37-303LGBEG	Large	18" - 19"
37-3031LBEG	X-Large	20" - 21"
37-3032LBEG	XX-Large	22" - 23"
37-3033LBEG	XXX-Large	24" - 25"

Measure around leg 4" above center of kneecap.

Suggested HCPCS Code A4466

FLA OA / Arthritis Knee Brace

Stabilize

LATEX
FREE
FORMULA

This lightweight, low profile brace is ideal for daily activities. The sports neoprene provides therapeutic warmth to the joint and surrounding tissues to help soothe aches and pains. Color: Beige.

INDICATIONS:

- Mild Unicompartmental Osteoarthritis (OA)
- Knee Pain or Inflammation Due to Cartilage or Meniscus Deterioration
- Mild Ligament Instabilities
- Medial or Lateral Instability
- Post-Op (Meniscal or Articular Cartilage Repair)

Features & Benefits

- Provides Excellent Support and Targeted Pain Relief
- May Relieve the Pain Associated with Mild Osteoarthritis (OA) of the Knee
- Unilateral Hinge and Strapping Configuration Apply Corrective Force to Offload the Affected Side of the Joint
- Wrap-Around, Patient-Friendly Design - Easy to Apply to Swollen Tender Knees
- Neoprene Provides Therapeutic Warmth to Soothe the Aching Joint
- Support Straps Allow for Adjustable Compression
- Available in Medial and Lateral Designs for Left and Right Knee Applications
- Interchangeable Condyle Pads for Day-to-Day Adjustment



FLA OA / Arthritis Knee Brace

Medial Left Lateral Right Ref. No.	Medial Right Lateral Left Ref. No.	Size	Fits
37-1501SBEG	37-1511SBEG	X-Small	12" - 13"
37-150SMBEG	37-151SMBEG	Small	14" - 15"
37-150MDBEG	37-151MDBEG	Medium	16" - 17"
37-150LGBEG	37-151LGBEG	Large	18" - 19"
37-1501LBEG	37-1511LBEG	X-Large	20" - 21"
37-1502LBEG	37-1512LBEG	XX-Large	22" - 23"
37-1503LBEG	37-1513LBEG	XXX-Large	24" - 25"

Measure around leg 4" above center of kneecap. Specify Medial Left/ Lateral Right or Medial Right/Lateral Left.

Suggested HCPCS Code L2999

FLA Safe-T-Sport® Neoprene Hinged Knee Stabilizing Brace

Stabilize

LATEX
FREE
FORMULA

Neoprene knee sleeve with durable steel hinged reinforcements allow for flexion and limit medial/lateral movement with a 180° hyperextension stop. Hinges in neoprene covered pockets for added comfort. Brace includes a superior horseshoe for added patella stability. Two adjustable straps prevent brace migration. Sports neoprene with nylon terry liner has a soft, seamless feel against the skin. Open patella and easy slip on style. Colors: Navy or Black.



FLA Safe-T-Sport® Neoprene Hinged Knee Stabilizing Brace

Navy Ref. No.	Black Ref. No.	Size	Fits
37-1041SNVY	37-1041SBLK	X-Small	12" - 13"
37-104SMNVY	37-104SMBLK	Small	14" - 15"
37-104MDNVY	37-104MDBLK	Medium	16" - 17"
37-104LGNVY	37-104LGBLK	Large	18" - 19"
37-1041LNVY	37-1041LBLK	X-Large	20" - 21"
37-1042LNVY	37-1042LBLK	XX-Large	22" - 23"
37-1043LNVY	37-1043LBLK	XXX-Large	24" - 25"

Measure 4" above center of the kneecap
Suggested HCPCS Code L1812

FLA Safe-T-Sport[®] Neoprene Knee Stabilizing Brace

Stabilize

LATEX
FREE
FORMULA

with Composite Hinges

Neoprene knee sleeve with lightweight composite hinges. Lightweight, thin neoprene with nylon terry liner for a soft, seamless feel against the skin. Ideal for use on swollen or tender knees resulting from sprains, strains, injuries, arthritis or post-operative rehabilitation. Color: Beige.

Features & Benefits

- Lightweight neoprene for consistent compression and therapeutic warmth
- Interior horseshoe support around knee joint for patellar tracking problems
- Lightweight composite hinges allow for flexion while limiting medial/lateral movement and preventing hyperextension
- Pull-on style with two loop lock adjustable straps

FLA Safe-T-Sport[®] Neoprene Knee Stabilizing Brace with Composite Hinges

Ref. No.	Size	Fits
37-1071SBEG	X-Small	12" - 13"
37-107SMBEG	Small	14" - 15"
37-107MDBEG	Medium	16" - 17"
37-107LGBEG	Large	18" - 19"
37-1071LBEG	X-Large	20" - 21"
37-1072LBEG	XX-Large	22" - 23"

Measure 4" above center of the kneecap

Suggested HCPCS Code L1812



FLA FlexLite® Hinged Knee Support

Stabilize

LATEX
FREE
FORMULA

This practical hinged knee support is extremely lightweight and recommended for mild ligament injury, knee instability or degenerative joint disease. Ideal for walking or light activities. Provides medial and lateral stabilization. Hinges are made of an ultra light space age composite material that is strong and durable. Hinges include stops to help prevent the knee from hyperextending. Unlike neoprene, the base foam material is breathable and cool with less bulk. Wrap style front closures and tension control straps. Color: Black.



FLA FlexLite® Hinged Knee Support

Ref. No.	Size	Thigh	Calf
37-108SMBLK	X-Small	12" - 13"	11½" - 13"
37-108MDBLK	Small	14" - 15"	13" - 14½"
37-108LGBLK	Medium	16" - 17"	14½" - 16"
37-1081LBLK	Large	18" - 19"	16" - 18"
37-1082LBLK	X-Large	20" - 21"	18" - 20"

Measure around thigh 4" above the center of the kneecap.

Measure around calf 4" below the center of the knee cap.

Suggested HCPCS Code L1812

FLA PowerCentric® Composite Polycentric Knee Brace

Stabilize

LATEX
FREE
FORMULA

Offers intermediary support for mild to moderate ligament strains, sprains (ACL/PCL), meniscal injuries, medial/lateral co-ligament instabilities and tears, and hyperextension or chronic knee instability problems. The polycentric hinges allow for full range of motion and include a built-in "stop" to prevent hyperextension of the knee. Contoured condyle shells provide additional protection against lateral impacts during activity. Color: Black.

Features & Benefits

- Polycentric hinges allow for full range of motion
- Lightweight and durable composite hinge material
- Hinge stop prevents knee hyperextension
- Adjustable straps
- Excellent patella stabilization
- Open popliteal design prevents bunching and irritation at the back of the knee
- Sports neoprene for consistent support and therapeutic warmth
- Easy slip-on style

PowerCentric® Composite, Polycentric Hinged Knee Brace

Ref. No.	Size	Thigh	Calf
37-109SMBLK	Small	15" - 18"	11" - 13"
37-109MDBLK	Medium	18" - 21"	13" - 16"
37-109LGBLK	Large	21" - 25"	16" - 19"
37-1091LBLK	X-Large	25" - 29"	19" - 22"
37-1092LBLK	XX-Large	29" - 33"	22" - 24"

Measure your thigh 4" above the center of your kneecap.

Measure around your calf 4" below the center of your kneecap.

Suggested HCPCS Code L1820



FLA 3D Knee Support

Support

LATEX
FREE
FORMULA

This specially designed 3D knee support provides excellent compression and stabilization for weak or injured knees. With its unique knitting structure made of polyamide and elastane it is a lightweight and breathable alternative to neoprene. Colors: White, Charcoal or Caramel.



Features & Benefits

- Stabilizing knee insert gently massages the knee area for reduction of swelling and targeted pain relief.

FLA 3D Knee Support

Ref. No.	Ref. No.	Ref. No.	Size - Thigh	Size - Calf
7588800	7588824	7588814	XX-Small 13 ³ / ₄ "-15"	XX-Small 9 ⁷ / ₈ "-11"
7588801	7588825	7588815	X-Small 15"-16 ¹ / ₈ "	X-Small 11"-12 ¹ / ₄ "
7588802	7588826	7588816	Small 16 ¹ / ₈ "-17 ³ / ₈ "	Small 12 ¹ / ₄ "-13 ³ / ₈ "
7588803	7588827	7588817	Medium 17 ³ / ₈ "-18 ¹ / ₂ "	Medium 13 ³ / ₈ "-14 ⁵ / ₈ "
7588804	7588828	7588818	Large 18 ¹ / ₂ "-19 ³ / ₄ "	Large 14 ⁵ / ₈ "-15 ³ / ₄ "
7588805	7588829	7588819	X-Large 19 ³ / ₄ "-20 ⁷ / ₈ "	X-Large 15 ³ / ₄ "-17"
7588806	7588830	7588820	XX-Large 20 ⁷ / ₈ "-22"	XX-Large 17"-18 ¹ / ₈ "

Measure around leg 5¹/₂" above center of kneecap and 4³/₄" below center of kneecap.

FLA 3D Knee Support - Extra-Wide*

Ref. No.	Size - Thigh	Size - Calf
7588810	Medium + 18 ¹ / ₂ "-19 ³ / ₄ "	Medium + 13 ³ / ₈ "-14 ⁵ / ₈ "
7588811	Large + 19 ³ / ₄ "-20 ⁷ / ₈ "	Large + 14 ⁵ / ₈ "-15 ³ / ₄ "
7588812	X-Large + 20 ⁷ / ₈ "-22"	X-Large + 15 ³ / ₄ "-17"
7588813	XX-Large + 22"-23 ¹ / ₄ "	XX-Large + 17"-18 ¹ / ₈ "

*Extra-Wide sizes accommodate a larger thigh circumference.

FLA 3D Knee Support - Plus Sizes

Ref. No.	Size - Thigh	Size - Calf
7588831	3 X-Large 22"-23 ¹ / ₄ "	3 X-Large 18 ¹ / ₈ "-19 ¹ / ₄ "
7588832	4 X-Large 23 ¹ / ₄ "-24 ³ / ₈ "	4 X-Large 19 ¹ / ₄ "-20 ¹ / ₂ "

FLA 3D Knee Support - Extra-Wide Plus Sizes

Ref. No.	Size - Thigh	Size - Calf
7588837	3 X-Large + 23 ¹ / ₄ "-24 ³ / ₈ "	3 X-Large + 18 ¹ / ₈ "-19 ¹ / ₄ "
7588838	4 X-Large + 24 ³ / ₈ "-25 ⁵ / ₈ "	4 X-Large + 19 ¹ / ₄ "-20 ¹ / ₂ "

FLA Safe-T-Sport® Neoprene Knee Sleeve

Support

LATEX
FREE
FORMULA

Indications

- Slight knee strains
- Arthritis
- Knee contusions
- Slight meniscus tears
- Knee joint effusion
- Weakened quadriceps

Features & Benefits

- Provides consistent compression
- Provides four way stretch for proper fit and comfort
- Retains the body's natural heat to provide therapeutic and soothing warmth to joints and muscles
- Easy slip-on style
- Soft nylon loop lining
- Sports neoprene for therapeutic warmth

Available open or closed patella. Color Navy or Black.

FLA Safe-T-Sport® Neoprene Knee Brace

Open Patella Ref. No.	Closed Patella Ref. No.	Color	Size	Fits
37-3731SNVY	37-3741SNVY	Navy	X-Small	12" - 13"
37-373SMNVY	37-374SMNVY	Navy	Small	14" - 15"
37-373MDNVY	37-374MDNVY	Navy	Medium	16" - 17"
37-373LGNVY	37-374LGNVY	Navy	Large	18" - 19"
37-3731LNVY	37-3741LNVY	Navy	X-Large	20" - 21"
37-3732LNVY	37-3742LNVY	Navy	XX-Large	22" - 23"
37-3733LNVY	37-3743LNVY	Navy	XXX-Large	24" - 25"
37-3731SBLK	37-3741SBLK	Black	X-Small	12" - 13"
37-373SMBLK	37-374SMBLK	Black	Small	14" - 15"
37-373MDBLK	37-374MDBLK	Black	Medium	16" - 17"
37-373LGBLK	37-374LGBLK	Black	Large	18" - 19"
37-3731LBLK	37-3741LBLK	Black	X-Large	20" - 21"
37-3732LBLK	37-3742LBLK	Black	XX-Large	22" - 23"
37-3733LBLK	37-3743LBLK	Black	XXX-Large	24" - 25"

Measure 4" above center of kneecap

Suggested HCPCS Code A4466



FLA GelBand® Patella Strap

Support

LATEX
FREE
FORMULA

This patella strap provides the ideal in therapeutic support - conforming compression without restricting circulation. Use this support to treat symptomatic pain from Chondromalacia Patella Syndrome, Patellar Tendinitis, and Osgood-Schlatter's disease. Strap applies uniform compression which helps guide the patella and improve tracking. Includes a uniquely designed viscoelastic insert that provides consistent and focused compression. Angulated buckles allow strap to reside properly for minimal migration in either inferior or superior applications. Colors: Black or Beige.



U-Point™ Gel Insert focuses pressure on the tendon below the kneecap

FLA GelBand® Patella Strap

Black Ref. No.	Beige Ref. No.	Size	Fits
37-500UNBLK	37-500UNBEG	Universal	11" - 18"

Measure around kneecap.

Suggested HCPCS Code A4466

FLA Safe-T-Sport® Neoprene Patella Support

Support

LATEX
FREE
FORMULA

Neoprene retains the body's natural heat to provide therapeutic and soothing warmth to joints and muscles. The inferior patella pad focuses compression on the patellar tendon to relieve discomfort, increase stabilization and improve patella tracking. Indicated for Chondromalacia Patella, fat pad impingement, Osgood-Schlatter Disease, patella instability, patella tendonitis, patellar subluxation, degeneration, and arthritis. Color: Black.



Features & Benefits

- Sports Neoprene provides therapeutic warmth and support around the joint to speed healing.
- Inferior Patella Pad applies uniform compression to reduce the load on the patellar tendon to increase stability, improve patella tracking, and help alleviate pain and pressure.
- Adjustable hook and loop straps for an improved fit and enhanced compression control.
- Simple wrap-around design for quick, easy application.

FLA Safe-T-Sport® Sports Neoprene Patella Support

Ref. No.	Size	Fits
37-300SMBLK	Small	13" - 14"
37-300MDBLK	Medium	14½" - 15½"
37-300LGBLK	Large	16" - 17"
37-3001LBLK	X-Large	17½" - 18½"

Measure circumference around the center of the patella (kneecap).

Suggested HCPCS Code A4466

FLA Compressive Knee Support

Support

LATEX
FREE
FORMULA

with Viscoelastic Insert

For swollen or tender knees resulting from sprains, strains, sports injuries, arthritis or post-operative rehabilitation. Contains a donut-shaped viscoelastic insert that surrounds the patella and provides a gentle massaging effect as the knee is flexed and extended.

For added side-to-side stability, the support includes flexible stays. Made of lightweight, breathable knit material. Will not retain excessive body heat. Color: White/Blue.



FLA Compressive Knee Support with Viscoelastic Insert

Overlap Abdominal Belt Ref. No.	Size	Fits
37-850SMSTD	Small	14" - 16"
37-850MDSTD	Medium	16" - 18"
37-850LGSTD	Large	18" - 20"
37-8501LSTD	X-Large	20" - 22"

Measure 4" above center of the kneecap.

Suggested HCPCS Code A4466

FLA EZ-ON® Neoprene Knee Wrap

Support

LATEX
FREE
FORMULA

Features & Benefits

- Wrap design fits a range of sizes and is easy to apply to swollen or injured knees
- Sports neoprene for therapeutic warmth
- Soft, terry material against skin
- Rubber patella support donut can be removed or cut to horseshoe
- Open behind knee

Color: Navy

FLA EZ-ON® Neoprene Knee Wrap

Ref. No.	Size	Fits
37-307UNNVY	Universal	12" - 21"
37-3077UNNVY	Plus Size	20" - 30"

Measure 4" above center of the kneecap.

Suggested HCPCS Code A4466



FLA 3D Thigh Support

Provides support to help reduce pain and edema due to injured thigh muscles. Unique Y-shaped straps for additional compression. Breathable and easy to use support with gradient compression. Color: Charcoal and Blue.

FLA ProLite® 3D Thigh Support

Ref. No.	Size	Dimensions
7624300	SM	16 ¹ / ₈ " - 17 ³ / ₄ "
7624301	MD	17 ³ / ₄ " - 19 ³ / ₄ "
7624302	LG	19 ³ / ₄ " - 22 ¹ / ₈ "
7624303	XL	22 ¹ / ₈ " - 24 ⁷ / ₈ "
7624304	XXL	24 ⁷ / ₈ " - 27 ¹ / ₂ "

Measure around leg at mid thigh.
Suggested HCPCS Code A4466



Support

LATEX
FREE
FORMULA

FLA 3D Calf Support

Provides support to help reduce pain and edema due to injured calf muscles. Unique Y-shaped straps for additional compression. Breathable and easy to use support with gradient compression. Color: Charcoal and Blue.

FLA ProLite® 3D Calf Support

Ref. No.	Size	Dimensions
7624200	SM	11 ¹ / ₂ " - 13 ³ / ₈ "
7624201	MD	13 ³ / ₈ " - 15 ³ / ₄ "
7624202	LG	15 ³ / ₄ " - 18 ¹ / ₂ "

Measure around leg 4³/₄" below center of kneecap.
Suggested HCPCS Code A4466



Support

LATEX
FREE
FORMULA

FLA EZ-ON® Thigh Wrap Support

Neoprene thigh wrap design allows for a tapered-even fit, quick application and adjustable compression. Gives a universal fit since closures can be applied anywhere on the support. Double compression is needed. Soft terry lining, seamless design. Color: Navy.

FLA EZ-ON® Thigh Wrap Support

Ref. No.	Size	Dimensions
37-105UNNVY	UNIV	Up to 27"

Measure around thigh.
Suggested HCPCS Code A4466



Support

LATEX
FREE
FORMULA

FLA Ankle Walker

Immobilize

LATEX
FREE
FORMULA

Indications

- Acute or severe ankle sprains
- Severe ankle or foot strains
- Lower extremity soft tissue injuries
- Stress fractures of the foot or ankle
- Stable fractures of the foot or ankle
- Post achilles tendon repairs
- After cast removal

Features & Benefits

- Lightweight and low profile
- Rocker bottom with no skid sole
- Crossed ankle straps for improved foot stabilization
- Adjustable top straps
- Ventilated foam liner with soft wicking inner material to keep skin cool and dry
- Extra comfort padding
- High and low height walkers available

Color: Black / Gray



FLA Ankle Walker

Low Height Ref. No.	High Height Ref. No.	Size	US Men's Shoe Size	US Women's Shoe Size
7570814	7570905	X-Small	1 - 2½	2 - 3½
7570811	7570906	Small	3 - 5	4 - 6
7570812	7570907	Medium	5½ - 9½	6½ - 10½
7570813	7570908	Large	10 - 13	11 - 14½
7570815	7570909	X-Large	14 - 15	14 - 15

Suggested HCPCS Code L4387

FLA Adjustable Air Ankle Walker

Immobilize

LATEX
FREE
FORMULA

Indications

- Acute or severe ankle sprains
- Severe ankle or foot strains
- Lower extremity soft tissue injuries
- Stress fractures of the foot or ankle
- Stable fractures of the foot or ankle
- Post achilles tendon repairs
- After cast removal

Features & Benefits

- Lightweight and low profile
- Rocker bottom with no skid sole
- Crossed ankle straps for improved foot stabilization
- Adjustable top straps
- Breathable foam liner with soft wicking inner material to keep skin cool and dry
- Extra comfort padding
- High and low height walkers available
- Adjustable air bladder for a customized fit

Color: Black / Gray



FLA Adjustable Air Ankle Walker

Low Height Ref. No.	High Height Ref. No.	Size	US Men's Shoe Size	US Women's Shoe Size
7571006	7571106	X-Small	2½	2 - 3½
7571007	7571107	Small	3 - 5	4 - 6
7571008	7571108	Medium	5½ - 9½	6½ - 10½
7571009	7571109	Large	10 - 13	11 - 14½
7571010	7571110	X-Large	14 - 15	14 - 15

Suggested HCPCS Code L4361

FLA Easy-Air™ Pneumatic Stirrup Ankle Brace

Stabilize

LATEX
FREE
FORMULA

The FLA Easy-Air™ Pneumatic Stirrup Ankle Brace stabilizes the ankle joint comfortably and securely while allowing maximum mobility.

Color: Black / Blue

Indications

- Acute capsular ligament injuries (ankle sprains)
- Ankle strains
- Chronic ankle instability
- Preventive bracing and post cast support

Features & Benefits

- Inflatable cushioning air cells for effective therapy and enhanced comfort
- Reliable stabilization of the injured ankle joint provides a sense of security
- Functional slim design allows for free movement after injury for a quick recovery



FLA Easy-Air™ Pneumatic Stirrup Ankle Brace

Ref. No.	Size	Body Height
7588500	Standard Right	> 5'4", > 162
7588501	Standard Left	> 5'4", > 162
7588502	Trainer Right	< 5'4", < 162
7588503	Trainer Left	< 5'4", < 162

Suggested HCPCS Code L4350

FLA Easy-Air™ Pneumatic Stirrup Ankle Brace with Gel

Stabilize

LATEX
FREE
FORMULA

The FLA Easy-Air™ Pneumatic Stirrup Ankle Brace with Gel stabilizes the ankle joint comfortably and securely, supporting rehabilitation while still allowing daily activities. Color: Black / Blue

Indications

- Acute capsular ligament injuries (ankle sprains)
- Ankle strains
- Chronic ankle instability
- Swelling and edema at the ankle
- Preventive bracing and post cast support

Features & Benefits

- Two integrated gel pads allow the application of cryotherapy for efficient pain reduction
- Inflatable cushioning air cells for effective therapy and enhanced comfort
- Increased stabilization of the injured ankle joint provides a feeling of safety



FLA Easy-Air™ Pneumatic Stirrup Ankle Brace with Gel

Ref. No.	Size	Body Height
7588510	Standard Right	> 5'4", > 162
7588511	Standard Left	> 5'4", > 162
7588512	Trainer Right	< 5'4", < 162
7588513	Trainer Left	< 5'4", < 162

Suggested HCPCS Code L4350

FLA Ankle Stirrup Brace with Air Liners

Stabilize

LATEX
FREE
FORMULA

This brace provides medial and lateral support to stabilize the ankle joint for faster recovery and healing of tender soft tissues. Ideal brace for mild or moderate sprains, strains, or after cast removal. Provides stabilization to chronically weak ankle joints as well. Color: White/Blue.

Features & Benefits

- Unique, durable tri-layer foam air bladder construction liner
- Pre-Inflated full length pneumatic air bladders and massage ankle during walking to help reduce ankle swelling and pain
- Weak ankle joints following ankle sprains, strains or after cast removal
- Adjustable heel piece conforms to fit a range of sizes
- Two adjustable swivel straps ensure proper strap placement each time brace is applied
- Standard height fits in most athletic shoes
- Fits most ankles - right or left



FLA Ankle Stirrup Brace with Air Liners

Ref. No.	Size
40-908UNSTD	Universal

Suggested HCPCS Code L4350

FLA FlexLite® Sport Articulating Hinged Ankle Brace

Stabilize

LATEX
FREE
FORMULA

Provides ankle stability to weak or injured ankles. Ideal for treatment of slight to moderate ankle sprains, strains, and ankle instability or weakness. Makes a great preventative brace during activity to help reduce the chance of sprains or strains. Color: Black.

Features & Benefits

- Bi-lateral articulating hinges glide smoothly allowing for full, unrestricted foot flexion.
- Foot plate transfers weight-bearing forces from the ankle joint and increases foot and ankle stability.
- Solid u-shape provides superior inversion/ eversion protection.
- Lightweight support shells molded from a lightweight plastic material in a design tailored to the ankle for maximum stabilization of the joint.
- Padded, formed foam liners. Ultra-lightweight liners cushion and hug the ankle with less bulk for a sleek, low profile fit.
- Integrated elastic straps. Two closure straps are integrated for a secure fit with no movement.
- Fits Right or Left



FULL,
UNRESTRICTED
FOOT FLEXION



FlexLite® Sport Articulating Hinged Ankle Brace

Ref. No.	Size	US Men's Shoe Size	US Women's Shoe Size
40-800SMBLK	Small	5 - 8½	6½ - 9½
40-800MDBLK	Medium	9 - 12	10 - 13
40-800LGBLK	Large	12½ - 16	13½ +

Suggested HCPCS Code L1906

Swede-O® InnerLOK 8™ Ankle Brace

Stabilize

LATEX
FREE
FORMULA

Ideal for sports and to support weak or injured ankles. Made of lightweight, low-profile nylon material for long-lasting wear. Extra ankle stabilization with internal figure eight straps that are preconfigured to ensure correct placement every time. Application is quick and easy. Comfortably fits in athletic shoes. Elastic back. Fits left or right. Color: Black.

Swede-O® InnerLOK 8™ Ankle Brace

Ref. No.	Size	US Men's Shoe Size	US Women's Shoe Size
40-511SMBLK	Small	6 - 7	7 - 9
40-511MDBLK	Medium	8 - 10	10 - 11
40-511LGBLK	Large	11 - 12	12 - 13
40-5111LBLK	X-Large	13 - 14	14 & up

Suggested HCPCS Code L1902

Swede-O® is a Registered Trademark of Swede-O Inc.



McDavid® Ankle Guard

Stabilize

with Optional Plastic Inserts

Soft, flexible vinyl ankle brace provides medial/lateral support to weak or injured ankles. Lace-up front allows for an intimate fit. Light enough to wear during athletic activity to help reduce the chance of sprains and strains. Medial/lateral support can be increased with optional plastic inserts. Plastic inserts are included. Fits left or right. Color: White.

McDavid® Ankle Guard with Optional Plastic Inserts

Ref. No.	Size	US Men's Shoe Size	US Women's Shoe Size
40-4112SSTD	XX-Small	Under 6	Under 7
40-4111SSTD	X-Small	6 - 7	7 - 8
40-411SMSTD	Small	8 - 9	9 - 10
40-411MDSTD	Medium	9 - 11	10 - 12
40-411LGSTD	Large	11 - 13	12 - 14
40-4111LSTD	X-Large	14 & up	-

Size according to shoe size.

Suggested HCPCS Code L1902

McDavid® is a Registered Trademark of McDavid Inc.



With Optional Plastic Support Inserts

FLA Canvas Lace-Up Ankle Brace

Stabilize

LATEX
FREE
FORMULA

Indicated when support of ankle joint is needed. Ideal for after cast removal or for mild/moderate sprains. Made of a breathable canvas material with soft flannel lining. Has metal spring stays for immobilization and added stability. Lace-up closure allows for an intimate medial/lateral fit. Fits left or right. Color: White.



FLA Canvas Lace-Up Ankle Brace

Ref. No.	Size	Men's Shoe Size	Women's Shoe Size
40-3111SSTD	X-Small	6 - 7	Under 7 - 8
40-3111SMSTD	Small	8 - 9	9 - 10
40-3111MDSTD	Medium	9 - 11	10 - 12
40-3111LGSTD	Large	11 - 13	12 - 14
40-3111LSTD	X-Large	13 - 14	14 - 15

Suggested HCPCS Code L1902

FLA 3D Ankle Support

Support

LATEX
FREE
FORMULA

This specially designed 3D ankle support provides excellent compression and stabilization for weak or injured ankles. With its unique knitting structure made of polyamide and elastane it is a lightweight and breathable alternative to neoprene. Color: White or Charcoal.



Features & Benefits

- Innovative knit structure provides gradient compression to promote the healing process
- Anatomic inserts gently massage the ankle area for the reduction of swelling and targeted pain relief

FLA 3D Ankle Support

Left Ref. No.	Right Ref. No.	Left Ref. No.	Right Ref. No.	Size
7588901	7588900	7588913	7588912	X-Small 6 ³ / ₄ " - 7 ¹ / ₂ "
7588903	7588902	7588915	7588914	Small 7 ¹ / ₂ " - 8 ¹ / ₈ "
7588905	7588904	7588917	7588916	Medium 8 ¹ / ₈ " - 9"
7588907	7588906	7588919	7588918	Large 9" - 9 ³ / ₄ "
7588909	7588908	7588921	7588920	X-Large 9 ³ / ₄ " - 10 ¹ / ₂ "
7588911	7588910	7588923	7588922	XX-Large 10 ¹ / ₂ " - 11 ¹ / ₄ "

Measure around ankle just above ankle bone

96 Suggested HCPCS Code A4466

FLA EZ-ON® Wrap-Around Ankle Support

Support

LATEX
FREE
FORMULA

Double elastic strap offers adjustable compression to both the medial and lateral sides of the ankle and arch of the foot. The wide strap simulates taping and wraps in a figure-eight design with a simple hook closure. Indicated for swollen, tender, or weak ankles, sprains, strains, sports injuries, and arthritis. Color: Black.

Features & Benefits

- Supports and Stabilizes - the ankle while allowing for full flexibility.
- Made with Sports Neoprene and Tri-Permaalon™ - The foot and ankle portion is made of neoprene which provides therapeutic warmth and compression to the joint and soft tissues. The top portion is made of a breathable Tri-Permalon™ foam to let the heat dissipate and air circulate.
- Wide, Double Elastic Strap wraps around the joint for increased stability. Figure-eight strap design simulates taping of the ankle and provides arch support.
- Simple Hook Closure - allows for quick and easy application.
- Open Heel - comfortable wrap support.
- May be worn under or over socks



FLA EZ-ON® Wrap-Around Ankle Support

Ref. No.	Size	Fits
40-550SMBLK	Small	8" - 10½"
40-550MDBLK	Medium	10½" - 12½"
40-550LGBLK	Large	12½" - 14½"
40-5501LBLK	X-Large	14½" - 16½"
40-5502LBLK	XX-Large	16½" - 18½"
40-5503LBLK	XXX-Large	18½" - 20½"

Measure circumference of calf, 5" above ankle joint

Suggested HCPCS Code A4466

FLA Safe-T-Sport® Neoprene Ankle Support

Support

LATEX
FREE
FORMULA

Features & Benefits

- Neoprene provides therapeutic warmth and compression to ankle joint
- Open heel, slip-on style

Color: Navy or Black.

FLA Safe-T-Sport® Neoprene Ankle Support

Ref. No.	Color	Size	Fits
40-701SMNVY	Navy	Small	8" - 9½"
40-701MDNVY	Navy	Medium	9½" - 11"
40-701LGNVY	Navy	Large	11" - 12½"
40-7011LNVY	Navy	X-Large	12½" - 14½"
40-701SMBLK	Black	Small	8" - 9½"
40-701MDBLK	Black	Medium	9½" - 11"
40-701LGBLK	Black	Large	11" - 12½"
40-7011LBLK	Black	X-Large	12½" - 14½"

Measure around ankle

Suggested HCPCS Code A4466



FLA Pullover Elastic Anklet

Support

LATEX
FREE
FORMULA

Features & Benefits

- Lightweight
- Knit elastic
- Seamless, slip-on style

Color: White.

FLA Pullover Elastic Anklet

Ref. No.	Size	Fits
40-101SMSTD	Small	8" - 9½"
40-101MDSTD	Medium	9½" - 11"
40-101LGSTD	Large	11" - 12½"
40-1011LSTD	X-Large	12½" - 14½"

Measure around ankle.

Suggested HCPCS Code A4466



FLA ProLite® Ankle Support Knitted Pullover

Support

LATEX
FREE
FORMULA

Provides excellent compression and stabilization for weak or injured ankles. Made of a stretch knitted elastic that is a lightweight and breathable alternative to neoprene. Elastic provides compressive support while maintaining flexibility. Colors: Blue or Beige.

Features & Benefits

- Comfortable, firm support for weak or injured ankles
- Made of a lightweight material for a breathable alternative to neoprene
- Unique knit design for precise compression
- Available in blue or beige



FLA ProLite® Ankle Support Knitted Pullover

Blue Ref. No.	Beige Ref. No.	Size	Fits Ankles
40-400SMSTD	40-400SMBEG	Small	7" - 8½"
40-400MDSTD	40-400MDBEG	Medium	8½" - 9½"
40-400LGSTD	40-400LGBEG	Large	9½" - 11"
40-4001LSTD	40-4001LBEG	X-Large	11" - 12"

Measure around ankle just above the ankle bone.

Suggested HCPCS Code A4466

3D Achilles Tendon Support

Support

LATEX
FREE
FORMULA

Indications

- Acute and chronic inflammation of the Achilles tendon
- Achillobursitis
- Degenerative changes in the Achilles tendon
- Postoperative / traumatic irritations

Features & Benefits

- Improves stability and helps relieve pain
- Helps in the Achilles tendon area

3D Achilles Tendon Support



Ref. No.	Size
76234-31	Small 7½" - 8¼"
76234-32	Medium 8¼" - 9"
76234-33	Large 9" - 9¾"
76234-34	X-Large 9¾" - 10½"
76234-35	XX-Large 10½" - 11¼"

Measure around ankle just above ankle bone

Breathable and easy-to-use support with gradient compression

Motion Comfort Zone for comfortable wear

Two viscoelastic pressure pads create a massage effect on the soft tissues on both sides of the Achilles tendon area, helping to reduce edema and swelling



Optional heel wedges for additional relief to the Achilles tendon



FLA HealWell® Cub™ Plantar Fasciitis Night Splint

Immobilize

LATEX
FREE
FORMULA

The HealWell® Cub™ Resting Comfort Slipper™ is designed to comfortably position the foot in the controlled amount of dorsiflexion to provide a gentle stretch across the plantar fascia, Achilles tendon and calf muscles. This gentle stretch helps reduce the muscle and ligamentous contracture, inflammation and associated pain - clinically proven to reduce symptoms of plantar fasciitis. This action also helps relieve many other conditions of the lower extremities including foot drop, Achilles tendinitis, and painful night calf muscle cramping. Color: Black. Specify right or left.

Features & Benefits

- Low profile, lightweight with less bulk for superior comfort.
- Open toe “slipper” is comfortable against the foot and easy to sleep in. Cool and comfortable to wear.
- Lateral side support with opening ensures no pressure on the sensitive heel, Achilles tendon, or bony ankle malleolus.
- Adjustable hinge can be positioned from 0 to 10 degrees depending on the amount of stretch required or desired.
- Built in toe wedge for more effective stretch across the plantar fascia.
- Ankle strap is perfectly positioned to hold the foot and heel in place for a more effective stretch.
- Easy and quick to apply.



US Patents D497,207; D495,058;
D481,798 & 7,182,743

FLA HealWell® Cub™ Plantar Fasciitis Night Splint

Left Ref. No.	Right Ref. No.	Size	US Men's Shoe Size	US Women's Shoe Size
58-5014	58-5004	Small	6.5 and under	7.5 and under
58-5015	58-5005	Medium	7 - 10½	8 - 11½
58-5016	58-5006	Large	11 - 13	12 and up

Suggested HCPCS Code L4397

Inner Shell - Lateral Side



ADJUSTABLE DORSIFLEXION

Adjustable hinge can be positioned from 0 to 10 degrees, depending on the amount of stretch required or desired.

Preset at most common 5 degree setting.

FLA HealWell® Plantar Fasciitis Night Splint

Immobilize

LATEX
FREE
FORMULA

Our Standard Plantar Fasciitis Night Splint Comfortably positions the foot in a controlled amount of dorsiflexion. Adjustable bilateral dorsiflexion straps enable the application of prolonged stretch to the soft tissues of the Plantar Fascia and the Achilles tendon. Both the heel orientation and tibial straps are easy to adjust and use with push lock buckles. Padded straps for increased comfort. Made of high density plastic with ventilated calf area for patient comfort and breathability. Removable, soft liner. Removable foam wedge to provide additional toe extension.

Universal design fits both left and right.

Indications:

- Plantar Fasciitis
- Achilles Tendinitis
- Heel Spurs
- Muscle Tightening
- Runner's Cramp

FLA HealWell® Plantar Fasciitis Night Splint

Ref. No.	Size	US Men's Shoe Size	US Women's Shoe Size
58-409400	Small	Under 6	5 - 7
58-409500	Medium	6 - 8	7½ - 9½
58-409600	Large	8½ - 10½	7½ - 9½
58-409700	X-Large	11 - 13	Over 12
58-409800	XX-Large	Over 13	-

Suggested HCPCS Code L4397



FLA HealWell® Multi-AFO / Contracture Splint

Immobilize

LATEX
FREE
FORMULA

The HealWell® Multi AFO is designed to help prevent and/or treat many conditions of the lower extremities. The shell is made of lightweight plastic and has a spring-like action. It has a soft and comfortable liner that allows air to circulate, absorbs perspiration and also keeps the foot warm. Padded adjustable toe post and hip rotation bar. Liner is removable for laundering. Available with or without transfer pad. Color: White.

Indications

- Non-Fixed Ankle Contractures
- Foot Drop
- Pressure Ulcers
- Hip Abduction
- Ankle Deformity
- Hip or Leg Rotation
- Post Surgery Knee or Hip

Available with or without transfer pad.
Pad assists the patient in transfers and in therapy treatment plans.



Completely
Suspends the Heel

FLA HealWell® Multi AFO / Contracture Splint

Ref. No.	Ref. No. with Transfer Pad	Size	US Men's Shoe Size	US Women's Shoe Size
58-100409	58-120400	Small	4 - 5	3 - 6
58-100506	58-120507	Medium	6 - 9	7 - 10
58-100603	58-120604	Large	10	11
58-100700	58-120701	X-Large	Over 10	Over 11

Suggested HCPCS Code L4398 / L4397 (Transfer Pad)

FLA HealWell® Soft Ease™ Multi-AFO / Heel Suspender

Immobilize

LATEX
FREE
FORMULA

The HealWell® Soft Ease™ Multi-AFO / Heel Suspender is designed to position the foot with the heel completely suspended, eliminating pressure and preventing ulcers. The unique shape allows the heel to float in an air cavity with absolutely no contact. This product is an economical, effective solution for heel ulcer prevention for any at-risk patient. By suspending the heel, the Soft Ease promotes air circulation around the foot, aiding in treatment and healing of existing pressure ulcers. The resilient plastic shell base correctly positions the foot for treatment of foot drop and non-fixed ankle/foot contractures. It also maintains alignment of the foot with the lower leg, minimizing inversion and eversion of the foot. Color: Blue.

Indications

- Heel Ulcer Treatment and Prevention
- Diabetic Foot Care Management
- Foot Drop
- Post Surgery
- Non-Fixed Ankle Contractures

Features & Benefits

- Super soft material wicks moisture away to keep skin dry and reduces friction and shear
- Integrated padded toe post protects the toes from contact with bed linens to prevent skin breakdown
- Fully adjustable straps accommodate changes in edema
- Extra padding at sensitive Achilles area

FLA HealWell® Soft Ease™ Multi-AFO / Heel Suspender

Ref. No.	Size	US Men's Shoe Size	US Women's Shoe Size
58-240400	Small / Medium	4 - 9	5 - 10
58-240600	Large / X-Large	10 - 13	11+

Fits Right or Left.

Suggested HCPCS Code L4398



FLA Ankle Foot Orthosis/ Foot Drop Splint

Immobilize

LATEX
FREE
FORMULA

Indicated to correct foot drop during ambulation in patients with neurological deficit. Made of durable and resilient polypropylene. Fits into standard shoe. Can be easily trimmed or molded with heat. Forms at 310°-325°F. Adjustable calf band with padding and adjustable closure. Specify right or left. Color: White.



FLA Ankle Foot Orthosis / Foot Drop Splint

Left Ref. No.	Right Ref. No.	Size	US Men's Shoe Size	US Women's Shoe Size
58-320421	58-320412	Small	3 - 6	5 - 8
58-320528	58-320519	Medium	6 - 9	8 - 11
58-320625	58-320616	Large	9 - 11+	-

Suggested HCPCS Code L1930

FLA HealWell® AFO Night Wrap

Stabilize

LATEX
FREE
FORMULA

Helps prevent nighttime contracture with countervailing tension to hold the foot neutral. This helps relieve pain and discomfort and speed healing in new or mild conditions such as Achilles tendinitis, plantar fasciitis or arthritis. Designed to wear during rest or sleep. Color: Black.

INDICATIONS:

- Arthritis
- Achilles Tendinitis
- Plantar Fasciitis
- Calf Muscle Cramps
- Equinus (Muscle Tightening)
- Heel & Arch Pain
- Achilles Paratenonitis
- Post Surgical Treatment of the Foot
- Fits right or left

Features & Benefits

- Soft Laminated Foam - Breathable, lightweight material is comfortable for night-time wear with a smooth lining.
- Slim, Low Profile - No bulk, compact wrap design is easy to sleep in.
- Non-Slip Pad - For safe, occasional walking.
- Compression Formed Back - Holds the wrap in place and conforms around the ankle and heel for improved foot positioning.
- Dual Tension Straps - Countervailing tension straps help hold the foot in position and prevent plantar flexion. Straps criss-cross for less bulk.
- Plantar Surface Support - Tension straps work with a low profile, rigid stay on the plantar surface, functioning as a lever to maintain foot position.



FLA HealWell® AFO Night Wrap

Ref. No.	Size	US Men's Shoe Size	US Women's Shoe Size
58-6004	Small / Medium	up to 8	up to 8
58-6006	Large / X-Large	8½ to 11½	9½ and up

For shoe size greater than 11½ it is recommended to use the HealWell® Cub™ or Standard Night Splint.

Suggested HCPCS Code L4397

FLA Products for Pediatric / Youth

Anatomically Designed...

A full range of orthopedic supports and braces specifically designed for pediatric and youth sizes. These pediatric products have been anatomically designed using anthropometric data compiled from two studies to accommodate 95% of children, providing a more precise fit and better overall support.

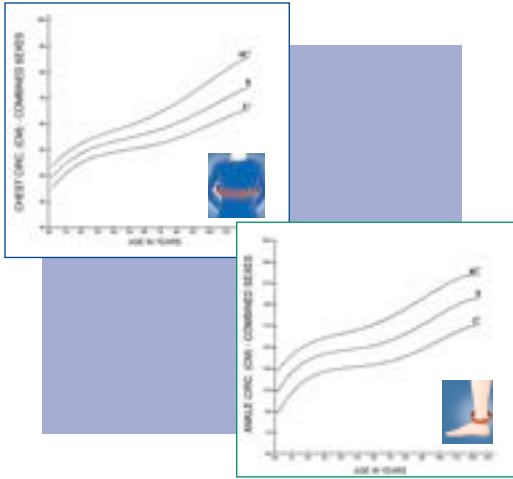

Examples of Sizing Data

...Specifically for Kids

Anatomically designed using anthropometric data compiled from studies performed by the Consumer Product Safety Commission and the Information Technology Laboratory at the National Institute of Standards and Technology. These studies collected and recorded average body measurements of each age range to aid in the design of products specifically for children. Using data from the resulting report, Physical Characteristics of Children*, our designed its pediatric products have been designed to accommodate 95% of children.

Quality Materials

The high quality, soft materials used in our pediatric line provide optimal comfort, support, and durability that both kids and parents can count on. All infant and pediatric sized products are child friendly – latex free and free of metal buckles and harsh closures, reducing the chance of irritation.

Approximate Age Ranges

- Infant - Fits 0-24 months
- Pediatric - Fits 2-7 years
- Youth - Fits 8-12 years
- Small Adult - Fits 13+ years

* Age ranges for each size are approximate and should be used as a general guide. Measurements should be taken to ensure proper fit and function.

Informative Color Packaging & Instruction Sheet

The infant and pediatric sized products in this offering are supplied in consumer friendly packaging with complete care and use instructions on the carton or on the enclosed insert sheet. Each box is labeled with measuring information and a provider peel-off label for easy transfer, billing and reordering. Many of the x-small and small sizes in our regular line fit youth and teens as well.

Items indicated with this icon are only available in our Pediatric packaging.
Orthopedic Supports for Pediatric / Youth

*Highway Safety Research Institute. (1975). Physical Characteristics of Children. (Report No. UM-HSRI-BI-75-5). Ann Arbor, MI: Snyder, R. G., Spencer, M. L., Owings, C. L., and Schneider, L. W.



Product insert

FLA Elastic Shoulder Immobilizer

Immobilize

LATEX
FREE
FORMULA

Features & Benefits

- Lightweight, low profile
- Immobilizes shoulder, reduces abduction and arm rotation
- Loop lock closures for easy application
- Fits right or left

Color: White.

Elastic Shoulder Immobilizer - Pediatric Line

Ref. No.	Size	Approximate Age	Fits Chests
16-701104	Infants	0 - 24 mos	16" - 22"
16-701301	Ped / XS	2 - 7 yrs	20" - 26"



FLA Wrist Splint

Immobilize

LATEX
FREE
FORMULA

Indications

- Sprains
- Strains
- After Cast Removal

Features & Benefits

- Soft, breathable foam for comfort
- Antimicrobial Protection for a fresher, more hygienic product
- Palmar/dorsal stays immobilize and support the wrist, prevent extension and flexion
- Low contour at palmar crease allows for full finger dexterity
- Simple hook and loop closures

Color: Blue.

Wrist Splint - Pediatric Line

Left Ref. No.	Right Ref. No.	Size	Approximate Age	Wrist Circumference
22-300120	22-300110	Infant	0 - 24 mos	4 1/2" and under
22-300220	22-300210	Ped	2 - 7 yrs	4 1/2" - 5 1/2"
22-300320	22-300310	Youth	8 - 12 yrs	5 1/2" - 6 1/2"

Measure circumference at wrist. Specify right or left.

Suggested HCPCS Code L3908

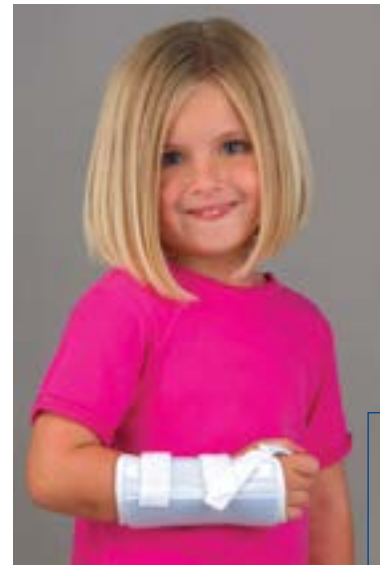

FLA Knee Immobilizer

Immobilize

LATEX
FREE
FORMULA

Indications

- Post Surgery
- After Cast Removal
- Knee Stability After Injury

Features & Benefits

- Popular tri-panel design with adjustable side panels
- Made of a soft foam treated with Antimicrobial Protection for a fresher, more hygienic product
- Lateral and medial stays increase stability
- Contoured posterior stays immobilize the knee
- Easy loop lock closures

Color: Blue.



Knee Immobilizer - Pediatric Line

Ref. No.	Size	Approximate Length*	Fits**
38-140002	Youth / XS	12"	12" - 13"

* Measure inseam to determine appropriate length

** Measure circumference 4" above center of knee

Suggested HCPCS Code L1830

FLA Cervical Collar

Stabilize

LATEX
FREE
FORMULA

Features & Benefits

- Low contour maintains head in neutral position
- Simple application with hook and loop closures

Color: Beige.



Cervical Collar - Pediatric Line

Ref. No.	Size	Approximate Age	Neck Circumference	Width x Length
11-111101	Infant	0 - 24 mos	9" - 10½"	2" x 13"
11-121202	Ped	2 - 7 yrs	10" - 12"	2½" x 15"
11-131306	Youth	8 - 12 yrs	12" - 14"	2½" x 17"

FLA Clavicle Support

Stabilize

LATEX
FREE
FORMULA

Features & Benefits

- Holds shoulders back and limits clavicle movement during treatment of clavicular fractures
- Felt back panel for greater support
- Adjustable top straps for an excellent fit
- Padded straps for comfort
- Treatment of Clavicular Fractures

Color: White.

Clavicle Support - Pediatric Line

Ref. No.	Size	Approximate Age	Fits Chests
16-101106	Infants	0 - 24 mos	15" - 20"
16-101307	Ped / XS	2 - 7 yrs	20" - 24"

Suggested HCPCS Code L3660



FLA Universal Arm Sling

Stabilize

LATEX
FREE
FORMULA

Features & Benefits

- Traditional cradle arm sling
- Fast, simple application
- Hook and loop closures for increased adjustability

Color: Pediatric Print (available for Infant and Pediatric) or Navy (available for Youth only).

Universal Arm Sling - Pediatric Line

Ref. No.	Color	Size	Approximate Age	Sling Length	Forearm Length
28-502102	Ped Print	Infant	0 - 24 mos	5"	3½" - 5½"
28-502204	Ped Print	Ped	2 - 7 yrs	7"	5" - 8"
28-502307	Navy	Youth	8 - 12 yrs	9"	7" - 10"

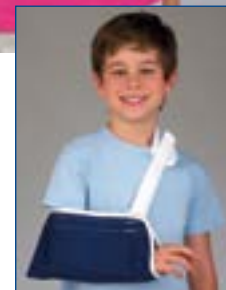

FLA Neoprene Patella Stabilizer

Stabilize

LATEX
FREE
FORMULA

Indications

- Chondromalacia Patella
- Lateral Tracking Patella
- Osgood-Schlatter Disease
- Knee Sprains
- Patella Instability
- Patella Subluxation

Features & Benefits

- Sports neoprene provides therapeutic warmth and compression
- Protects and supports the knee
- Removable horseshoe can be placed superior, inferior, lateral or medial, depending on where support is needed
- Two straps provide adjustable compression and prevent migration
- Open patella, easy slip-on style

Color: Navy.



Neoprene Patella Stabilizer - Pediatric Line

Ref. No.	Size	Approximate Age	Circumference at Kneecap
37-103207	Ped / Lg	6 - 7 yrs	10" - 12"

Suggested HCPCS Code A4466

FLA Neoprene Elbow Sleeve

Support

LATEX
FREE
FORMULA

Indications

- Tendonitis
- Tennis Elbow
- Juvenile Arthritis
- Muscle Strains

Features & Benefits

- Sports neoprene provides therapeutic warmth and compression around entire joint
- Soft nylon loop lining
- Adjustable strap for increased support

Color: Navy.



Neoprene Elbow Sleeve - Pediatric Line

Ref. No.	Size	Approximate Age	Forearm Circumference
19-601304	Ped / Lg	5 - 7 yrs	6 1/2" - 7 1/2"

Suggested HCPCS Code A4466

FLA Neoprene Knee Sleeve

Support

LATEX
FREE
FORMULA

Indications

- Joint Effusion (swelling)
- Knee Contusion (bruising)
- Knee Strains/Sprains
- Patella Instability
- Muscle Strains
- Juvenile Arthritis

Features & Benefits

- Sports neoprene provides therapeutic warmth and compression
- Open patella, easy slip-on style
- Supports the knee
- Limits swelling and decreases pain

Color: Navy.



Neoprene Knee Sleeve - Pediatric Line

Ref. No.	Size	Approximate Age	Circumference at Kneecap
37-373225	Ped / Sm	2 - 3 yrs	6" - 8"
37-373250	Ped / Md	4 - 5 yrs	8" - 10"
37-373275	Ped / Lg	6 - 7 yrs	10" - 12"

Suggested HCPCS Code A4466

FLA Neoprene Ankle Support

Support

LATEX
FREE
FORMULA

Indications

- Mild Sprains
- Ankle Strains
- Juvenile Arthritis
- Weak Ankles
- Tendinitis

Features & Benefits

- Sports neoprene for compression and therapeutic warmth
- Supports the ankle
- Limits swelling and decreases pain
- Allows for a full range of motion
- Easy slip-on style, open heel
- Can be worn over or under a sock

Color: Navy.



FLA Neoprene Ankle Support - Pediatric Line

Ref. No.	Size	Approximate Age	Circumference at Ankle
40-701204	Ped / Lg	6 - 7 yrs	6 1/2" - 7 1/4"
40-701307	Youth	8 - 12 yrs	7 1/4" - 8 1/2"

Suggested HCPCS Code A4466

FLA Canvas Rocker Bottom Cast Shoe



Features & Benefits

- Provides protection for walking casts
- Durable canvas material with adjustable closures
- Open toe and heel
- Non-skid sole
- Fits right or left

Color: Pediatric Print (Infant only) or Navy (Pediatric only).



FLA Canvas Rocker Bottom Cast Shoe - Pediatric Line

Ref. No.	Color	Size	Sole Dimension A	Sole Dimension B
43-101107	Ped Print	Infant	5 $\frac{1}{2}$ "	3"
43-101204	Navy	Ped	7 $\frac{1}{4}$ "	3 $\frac{5}{8}$ "

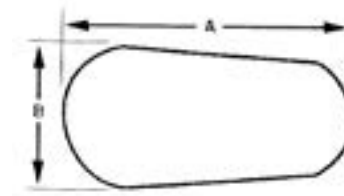

FLA Canvas Rocker Bottom Cast Shoe

Provides protection for walking casts. made of durable canvas material with two adjustable closures. Has open toe and open heel with non-skid sole. Color: Navy.

Canvas Rocker Bottom Cast Shoe

Ref. No.	Size	Measurement Widest Point	Measurement Longest Point	Color
43-101408	Small	4 ¹ / ₄ "	9 ³ / ₈ "	Blue
43-101505	Medium	4 ⁷ / ₈ "	11"	Blue
43-101602	Large	5 ³ / ₈ "	12 ⁵ / ₈ "	Blue
43-101709	X-Large	5 ⁵ / ₈ "	13 ¹ / ₂ "	Blue

Measure according to U.S. shoe size. Fits Right or Left.

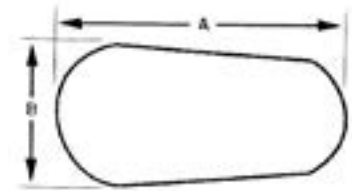

Sole Dimensions

Walking Heels

The deep tread of our Walking Heels provides good patient comfort and stability by allowing regular heel-toe walking. The specialized synthetic rubber is resilient and durable while the center slot permits easy and secure application.

Walking Heels

Ref. No.	Description	Unit of Measure
4183-133	Pedestal Walking Heel	12 / box
4183-135	Cushion Tread Walking Heel	12 / box
4183-130	Adult Walking Heel	12 / box
4183-132	Child Walking Heel	12 / box

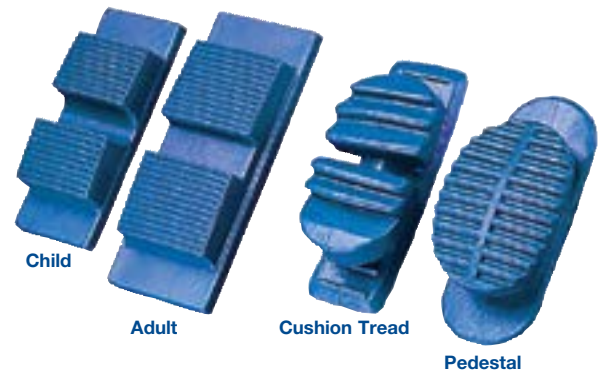

Specialist®

Post-Op Shoe

The Specialist® Post-Op Shoe consists of a large wrap with hook and loop closures and an open toe to accommodate post-surgical dressings. A semi-rigid flared sole in the heel provides enhanced medial lateral stability. The padded collar and reinforced heel provide extra patient comfort. Color: Black.



Specialist® Post-Op Shoe (Male)

Ref. No.	Color	Dimensions	Unit of Measure
9320	Black	Male Small	6 / case
9321	Black	Male Medium	6 / case
9322	Black	Male Large	6 / case
9323	Black	Male X Large	6 / case

Specialist® Post-Op Shoe (Female)

Ref. No.	Color	Dimensions	Unit of Measure
9310	Black	Female Small	6 / case
9311	Black	Female Medium	6 / case
9312	Black	Female Large	6 / case

C3™ Post Op Shoe

Designed for wear after soft tissue procedures or post-operative care. Especially useful for geriatric and diabetic patients with insensitive feet. C3™ Tri-Laminate upper makes this product cool and comfortable to wear. Adjustable straps accommodate the bulkiest dressings. Removable trim-fit tongue provides a better fit. Semi-rigid molded non-skid sole absorbs shock during ambulation. Fits right or left. Sold as each. Color: Black.



C3™ Post OP Shoe

Men's Ref. No.	Women's Ref. No.	Size	Men's Shoe Size	Women's Shoe Size
43-821400	43-820400	Small	6 - 8	4 - 6
43-821500	43-820500	Medium	8½ - 10	6½ - 8
43-821600	43-820600	Large	10½ - 12	8½ - 10
43-821700	–	X-Large	12½ - 14	–

Canvas Molded

Sole Rocker

The durable canvas duck design of the Canvas Molded Sole Rocker allows sizing versatility with its open toe and heel design. Hook and loop closures secure the cast shoe against slippage. Color: Navy.



Canvas Molded Sole Rocker

Ref. No.	Length	Width	Size
CMR-XS	7.25 in	3.5 in	X Small
CMR-S	9.5 in	4.25 in	Small
CMR-M	11.25 in	5 in	Medium
CMR-L	12.5 in	5.5 in	Large
CMR-XL	13.5 in	5.5 in	X Large
PPCR-XXS	6 in	3 in	Pediatric

Open-Toe

Cast Shoe

The Open-Toe Cast Shoe is constructed with a heavy canvas upper for increased strength and a tri-level EVA rocker bottom that provides shock absorption and smooth, roll-through gait for greater walking stability. Affordably priced, this premium cast shoe can be worn on either the left or right foot. Color: Blue.



Open-Toe Cast Shoe

Ref. No.	Color	Dimensions	Unit of Measure
58-35007	Blue	6.5 in - Pediatric	1 / each
58-35008	Blue	7.5 in - X Small	1 / each
58-35010	Blue	8.5 in - Small Adult	1 / each
58-35011	Blue	10 in - Medium Adult	1 / each
58-35012	Blue	11.5 in - Large Adult	1 / each
58-35013	Blue	12.5 in - X Large Adult	1 / each

Bandaging & Taping

Co-Plus® LF

ORTHO-GLASS®
Wraps

BSN Elastic
Bandage®

Isoband®

Tensogrip®

Tensoshape®

Leukotape® P

Leukotape® K

Lightplast® Pro

Optiplast®

Tensoplast®

Tensoplast® LF



Co-Plus® LF

**LATEX
FREE
FORMULA**

Cohesive Bandage

Co-Plus® LF is a latex-free, cohesive bandage suitable for light support or compression. Co-Plus® LF is flexible, lightweight and hand-tearable. Because of its unique construction, Co-Plus® LF adheres to itself and not to skin, aiding in patient comfort. No clips or fasteners required. Available in assorted colors and sizes. (Composition: nylon and elastomeric yarns)



Features & Benefits

- Latex-free formula
- Adheres only to itself
- Non-slip support
- Hand tearable

Co-Plus® LF Latex Free Cohesive Bandage

Ref. No.	Color	Size	Unit of Measure
7210014	■ Beige	1 in x 5 yds	60 / pack
7210016	■ Beige	2 in x 5 yds	36 / pack
7210017	■ Beige	3 in x 5 yds	24 / pack
7210018	■ Beige	4 in x 5 yds	18 / pack
7210019	■ Beige	6 in x 5 yds	12 / pack
7210033	■ Color Pack*	2 in x 5 yds	36 / pack
7210020	■ Color Pack*	3 in x 5 yds	24 / pack
7210021	■ Color Pack*	4 in x 5 yds	18 / pack

* Color Pack: Neon Pink, Light Purple, Neon Green and Red



ORTHO-GLASS® Wraps

**LATEX
FREE
FORMULA**

Elastic Bandage

Ortho-Glass® Wraps are excellent for mild compression support. Its controlled stretch retains strength and elasticity and is secured with hook and loop closures. These latex-free bandages are ideal for patients who are sensitive to natural rubber latex. Available in assorted colors and sizes.

ORTHO-GLASS® Wraps

Ref. No.	Size	Unit of Measure
CEB-2	2 in x 5 yds	18 rolls / pack
CEB-3	3 in x 5 yds	18 rolls / pack
CEB-4	4 in x 5 yds	18 rolls / pack



BSN Elastic Bandage®

**LATEX
FREE**
FORMULA

The BSN Elastic Bandage is latex-free, adjustable and constructed of breathable elastic. Ideal for minor sprains and strains. Each bandage is individually wrapped and may be secured by hook and loop closure. Available in a convenient dispenser box.

BSN Medical Elastic Bandages

Ref. No.	Color	Size	Unit of Measure
1037023	■ Beige	2 in x 5 yds	10 / box*; 5 bx / case
1037033	■ Beige	3 in x 5 yds	10 / box*; 5 bx / case
1037043	■ Beige	4 in x 5 yds	10 / box*; 5 bx / case
1037053	■ Beige	6 in x 5 yds	10 / box*; 5 bx / case

* Sold by case of 5 boxes



Isoband®

Elastic Light Support Bandage

An elastic, multi-purpose bandage that is ideal for light support, compression, fixation of splints and dressing retention. This bandage is washable and reusable and highly absorbent to secretions and perspiration.

Isoband® Elastic Light Support Bandage

Ref. No.	Color	Size	Unit of Measure
01958	□ Beige	6 in x 5.5 yds	50 rolls / case
01959	□ Beige	8 in x 5.5 yds	35 rolls / case

* Sold by case of 5 boxes



Tensogrip®

Tubular Support Bandage

Tensogrip® is an elasticated, tubular support bandage, ideal for the effective management of strains, sprains and soft tissue injuries. Provides consistent pressure and support over varying body contours. Constructed from a cotton/rayon blend with rubber latex yarn. Washable and reusable. Available in white and natural colors.

Features & Benefits

- Easy to apply
- Exerts even pressure and compression
- Washable and reusable
- Wide range of sizes

Caution: This product contains latex rubber which may cause an allergic reaction



Tensogrip® Tubular Support Bandage

Ref. No.	Color	Size	Sizing	Unit of Measure
7579	White	1.75 in x 11 yds	A	1 roll
7580	White	2.5 in x 11 yds	B	1 roll
7581	White	2.75 in x 11 yds	C	1 roll
7582	White	3 in x 11 yds	D	1 roll
7583	White	3.5 in x 11 yds	E	1 roll
7584	White	4 in x 11 yds	F	1 roll
7585	White	4.5 in x 11 yds	G	1 roll
7586	White	7 in x 11 yds	J	1 roll
7587	White	8.5 in x 11 yds	K	1 roll
7588	White	12.75 in x 11 yds	L	1 roll
7580FL	Beige	2.5 in x 11 yds	B	1 roll
7581FL	Beige	2.75 in x 11 yds	C	1 roll
7582FL	Beige	3 in x 11 yds	D	1 roll
7583FL	Beige	3.5 in x 11 yds	E	1 roll
7584FL	Beige	4 in x 11 yds	F	1 roll
7585FL	Beige	4.5 in x 11 yds	G	1 roll

Tensoshape®

Elastic Tubular Bandage

Tensoshape® is an elastic, tubular bandage, suitable for light or medium support. Its anatomical design provides graduated compression, promoting improved blood flow and lymphatic return. Both full leg and below-the-knee bandages available in a variety of sizes.

Features & Benefits

- Easy to apply
- Anatomical design exerts even pressure and compression
- General light support for treatment of minor soft tissue and injuries

Caution: This product contains latex rubber which may cause an allergic reaction



Tensoshape® Tubular Support Bandage - Below the Knee

Ref. No.	Limb Measurement	Size	Unit of Measure
7589	12.5 in x 14 in	Small (B/C)	10 / case
7590	13.7 in x 15.2 in	Medium (C/D)	10 / case
7591	14.8 in x 16.4 in	Large (D/E)	10 / case

Tensoshape® Tubular Support Bandage - Full Leg

Ref. No.	Limb Measurement	Size	Unit of Measure
7592	12.5 in x 14 in	Small (B/C)	10 / case
7593	13.7 in x 15.2 in	Medium (C/D)	10 / case
7594	14.8 in x 16.4 in	Large (D/E)	10 / case
7595	16 in x 17.6 in	X Large (D/E)	10 / case



Leukotape® P

Rigid Strapping Tape

Leukotape® P is a high strength, rigid strapping tape, with a very strong, zinc oxide adhesive. It is porous and hand-tearable, yet offers extra strong support for sprains and strains. Ideal for patellofemoral taping. Use in conjunction with Cover Roll Stretch.

Features & Benefits

- Porous
- Hand-tearable
- High strength adhesive
- Ideal for patellofemoral taping

Caution: This product contains latex rubber which may cause an allergic reaction



Leukotape P® Rigid Strapping Tape

Ref. No.	Size	Case Contents	Case Contents
76168	1.5 in x 15 yds	1 roll	30 rolls / case

Leukotape® K

Leukotape® K supports sensory functions. Wave pattern adhesive allows air to circulate and full mobility is preserved. It is stretchable, works ideally with the skin's natural elasticity. It has a protective liner for better handling. Leukotape® K has a Polyacrylate adhesive for reliable adhesion, while the backing material of cotton is hard wearing and skin friendly.

Indications

- Headache
- Back Pain
- Lymphedema
- Muscular Pain

Features & Benefits

- High user comfort
- Durable for up to one week's use
- Sports and showering present no problem
- Easy to remove



Leukotape® K

Ref. No.	Color	Size	Unit of Measure p. inner / p. outer
7297810	■ Beige	1 in x 5.5 yds	10 rolls inner sleeve; 50 rolls / case
7297811	■ Beige	2 in x 5.5 yds	10 rolls inner sleeve; 50 rolls / case
7297812	■ Beige	3 in x 5.5 yds	10 rolls inner sleeve; 50 rolls / case
7297815	■ Red	1 in x 5.5 yds	10 rolls inner sleeve; 50 rolls / case
7297816	■ Red	2 in x 5.5 yds	10 rolls inner sleeve; 50 rolls / case
7297817	■ Red	3 in x 5.5 yds	10 rolls inner sleeve; 50 rolls / case
7297820	■ Blue	1 in x 5.5 yds	10 rolls inner sleeve; 50 rolls / case
7297821	■ Blue	2 in x 5.5 yds	10 rolls inner sleeve; 50 rolls / case
7297822	■ Blue	3 in x 5.5 yds	10 rolls inner sleeve; 50 rolls / case
7297823	■ Black	2 in x 5.5 yds	10 rolls inner sleeve; 50 rolls / case
7297824	■ Lt Blue	2 in x 5.5 yds	10 rolls inner sleeve; 50 rolls / case
7297825	■ Pink	2 in x 5.5 yds	10 rolls inner sleeve; 50 rolls / case

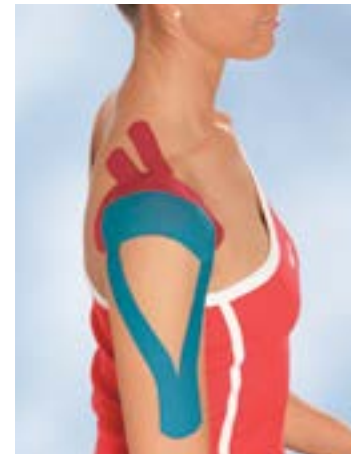

Lightplast® Pro

Elastic Adhesive Bandage

Lightplast® Pro is a tearable, elastic adhesive bandage, suitable for light support or compression. The unique fabric backing helps to conform to body movement. Ideal for all-purpose taping.

Features & Benefits

- Hand-tearable
- Excellent adhesion
- Air permeable
- Light and close fitting



Lightplast Pro® Tubular Support Bandage

Ref. No.	Color	Size	Unit of Measure
76952	□ White	1 in x 5 yds	48 rolls / case
76953	□ White	1.5 in x 5 yds	32 rolls / case
76954	□ White	2 in x 5 yds	24 rolls / case
76955	□ White	3 in x 5 yds	16 rolls / case
76956	□ White	2 in x 7.5 yds	24 rolls / case
76957	□ White	3 in x 7.5 yds	16 rolls / case
72880	■ Black	2 in x 5 yds	24 rolls / case
72881	■ Black	3 in x 5 yds	16 rolls / case
72883	■ Black	3 in x 7.5 yds	16 rolls / case



Optiplaste®

Elastic Adhesive Bandage

An elastic adhesive bandage, suitable for medium support or compression. Ideal for securing leg/limb support and wound dressings with no slippage. Patented weft-inserted construction provides strength and stability with improved softness and comfort - unique fabric backing helps to conform to body movement.

Features & Benefits

- Patented weft-inserted construction
- High quality extensible cloth
- Porous adhesive
- Fluffy non-fray edges

Caution: This product contains latex rubber which may cause an allergic reaction



Optiplaste® Elastic Adhesive Bandage

Ref. No.	Color	Size	Unit of Measure
7205661	■ Beige	2 in x 5 yds	6 rolls / box
7205662	■ Beige	3 in x 5 yds	4 rolls / box

Tensoplast®

Elastic Adhesive Bandage

Tensoplast®, formerly Elastoplast®, is an elastic adhesive bandage which is suitable for medium support or compression. Superior stretch and regain provides firm, controlled compression and support. The porous adhesive helps prevent skin maceration. Fluffy non-fray edges prevent the bandage from rucking or marking.



Features & Benefits

- High adhesive properties
- Provides strong compression and long term support
- Water repellent
- Air permeable

Caution: This product contains latex rubber which may cause an allergic reaction

Tensoplast® Elastic Adhesive Bandage - Individually Boxed

Ref. No.	Color	Size	Unit of Measure
02598002	■ Beige	1 in x 5 yds	36 rolls / case
02599002	■ Beige	2 in x 5 yds	36 rolls / case
02600002	■ Beige	3 in x 5 yds	36 rolls / case
02601002	■ Beige	4 in x 5 yds	36 rolls / case
02602002	■ Beige	6 in x 5 yds	12 rolls / case
02593002	□ White	1 in x 5 yds	36 rolls / case
02594002	□ White	2 in x 5 yds	36 rolls / case
02595002	□ White	3 in x 5 yds	36 rolls / case
02596002	□ White	4 in x 5 yds	36 rolls / case
02597002	□ White	6 in x 5 yds	12 rolls / case

Tensoplast® Elastic Adhesive Bandage - Boxed Packs

Ref. No.	Color	Size	Unit of Measure
04415001	■ Beige	2 in x 5 yds	72 rolls / case
04416001	■ Beige	3 in x 5 yds	48 rolls / case

Tensoplast® Elastic Adhesive Bandage - Bulk Packs

Ref. No.	Color	Size	Unit of Measure
04410001	■ Beige	1 in x 5 yds	32 rolls / case
04412001	■ Beige	2 in x 5 yds	24 rolls / case
04413001	■ Beige	3 in x 5 yds	16 rolls / case
04414001	■ Beige	4 in x 5 yds	16 rolls / case

Tensoplast® LF

LATEX
FREE
FORMULA

The Latex-Free Elastic Adhesive Bandage

The elastic Tensoplast® LF bandage, now available latex-free in the quality you trust. It provides flexible, strong support and compression thanks to its porous high-quality substrate. Its superior stretch and adhesive molds and holds to any part of the body, keeping the bandages firmly in place even throughout lengthy treatment. Trusted patient comfort and compliance for those sensitive to latex make Tensoplast® LF the optimal choice for a wide range of indications.

Indications

- Treatment of all conditions which require limitation of movement, e.g. sprains, sport injuries.
- Prophylactic use in active sport
- Retention of dressings and devices, e.g. postortho-pedic and general surgery or over a muscular wound
- Strong support and consistent control for injured ligaments or joints

Features & Benefits

- Latex-Free Fabric
- Permeable Material
- High-Quality Elastic Substrate
- Adhesive Coating
- Yellow Center Line

Tensoplast® LF Latex-Free Elastic Adhesive Bandage

Ref. No.	Color	Size	Unit of Measure
76232-00	☐ White	2 in x 4.9 yds	12 rolls / box
76232-01	☐ White	3 in x 4.9 yds	12 rolls / box
76232-02	☐ White	4 in x 4.9 yds	12 rolls / box



Fracture Bracing

These bracing products are fabricated from durable, lightweight thermoplastics. Simple trimming of these products assures a custom fit while designed to provide rigid, cast-like support with a comfortable anatomical shape.



A. Specialist® Wrist-Hand Orthosis

Ref. No. - Left	Ref. No. - Right	Size
61532	–	Small
61542	61541	Medium
61552	61551	Large

B. Specialist® Wrist - Hand - Thumb Orthosis

Ref. No. - Left	Ref. No. - Right	Size
61832	61831	Small
61842	61841	Medium
61852	61851	Large

C. Specialist® Thumb Orthosis

Ref. No. - Left	Ref. No. - Right	Size
61932	61931	Small
61942	61941	Medium
61952	61951	Large

D. Specialist® Humeral Fracture Orthosis

Ref. No.	Size	Bicep Circ.	Length
62533	Small	6 in – 7 in	4.75 in
62543	Medium	6.75 in – 7.75 in	5.25 in
62553	Large	7.5 in – 8.5 in	5.75 in
62563	X Large	14 in – 17 in	6.25 in

E. Specialist® Humeral Fracture Orthosis with Deltoid Ex

Ref. No.	Size	Bicep Circ.	Length
62333	Small	7.5 in – 11 in	7.5 in
62343	Medium	10 in – 13 in	8 ¹ / ₁₀ in
62353	Large	12 in – 15 in	8 ⁴ / ₅ in
62363	X Large	14 in – 17 in	9 ² / ₅ in

Finger Splint

STAX® Finger Splints are designed to support the distal joint of the finger extension while permitting unrestricted movement of the proximal inter-phalangeal joint.

Features & Benefits

- Automatically elevates the distal joint to its proper extended position
- The kit is ideal for any location where a multitude of splints in a variety of sizes needs to be kept



STAX® Finger Splints Kit - As Shown Above

Ref. No.	Color	Unit of Measure
PS5	■ Beige	kit
PS5C	□ Clear	kit

The PS5 and the PS5C splint kits contain the following splints:

STAX® Finger Splints - Components

Size	Quantity
1	4 each
2	4 each
3	4 each
4	5 each
5	4 each
5.5	4 each
6	4 each
7	1 each

STAX® Finger Splints - Beige

Ref. No.	Color	Size	Unit of Measure
PS6-1	■ Beige	1	each
PS6-2	■ Beige	2	each
PS6-3	■ Beige	3	each
PS6-4	■ Beige	4	each
PS6-5	■ Beige	5	each
PS6-5.5	■ Beige	5.5	each
PS6-6	■ Beige	6	each
PS6-7	■ Beige	7	each

STAX® Finger Splints - Clear

Ref. No.	Color	Size	Unit of Measure
PS6C-1	□ Clear	1	each
PS6C-2	□ Clear	2	each
PS6C-3	□ Clear	3	each
PS6C-4	□ Clear	4	each
PS6C-5	□ Clear	5	each
PS6C-5.5	□ Clear	5.5	each
PS6C-6	□ Clear	6	each
PS6C-7	□ Clear	7	each

STAX® Finger Splints Packs

Ref. No.	Description	Unit of Measure
PS10F10	Splint, Finger, STAX, Beige, Size #1	10 / pack
PS10F20	Splint, Finger, STAX, Beige, Size #2	10 / pack
PS10F30	Splint, Finger, STAX, Beige, Size #3	10 / pack
PS10F40	Splint, Finger, STAX, Beige, Size #4	10 / pack
PS10F50	Splint, Finger, STAX, Beige, Size #5	10 / pack
PS10F55	Splint, Finger, STAX, Beige, Size #5.5	10 / pack
PS10F60	Splint, Finger, STAX, Beige, Size #6	10 / pack
PS10F70	Splint, Finger, STAX, Beige, Size #7	10 / pack

Finger Splints

A variety of standard splint styles are available. Each splint is constructed with malleable aluminum and foam padding for patient comfort unless otherwise indicated. Most finger splints are available in two packaging configurations - either individually bagged in 6-pack box or bulk packed in bag of 12.

Baseball Finger Splint

Stabilizes fractures of the distal phalanx.

Baseball Finger Splints

Individually Bagged 6-Pack Ref. No.	Bulk Pack Bag of 12 Ref. No.	Size	Length
25-2014PK	25-201A405	Small	3 1/2"
25-2015PK	25-201A507	Medium	4"
25-2016PK	25-201A609	Large	5"



Curved / Gutter Finger Splint

For treatment of transverse fractures of the phalanges.

Curved / Gutter Finger Splint

Individually Bagged 6-Pack Ref. No.	Bulk Pack Bag of 12 Ref. No.	Size	Length
25-4014PK	25-401A404	Small	2 1/2"
25-4015PK	25-401A507	Medium	4"
25-4016PK	25-401A609	Large	6"



Four Prong / Gutter Finger Splint

For total finger immobilization and protection with easy application.

Four Prong / Gutter Finger Splint

Individually Bagged 6-Pack Ref. No.	Bulk Pack Bag of 12 Ref. No.	Size	Length
25-7014PK	25-701A403	Small	1 1/2"
25-7015PK	25-701A505	Medium	2"
25-7016PK	25-701A607	Large	3"



Toad Finger Splint

Maintains phalangeal joints in position without use of tape.

Toad Finger Splint

Individually Bagged 6-Pack Ref. No.	Bulk Pack Bag of 12 Ref. No.	Size	Length
25-3014PK	25-301A403	Small	2 ¹ / ₈ "
25-3015PK	25-301A505	Medium	2 ³ / ₄ "
25-3016PK	25-301A607	Large	2 ⁷ / ₈ "



Fold-Over / Cot Finger Splints

For total finger immobilization and protection with easy application. Good finger tip protection.

Fold-Over / Cot Finger Splints

Individually Bagged 6-Pack Ref. No.	Bulk Pack Bag of 12 Ref. No.	Size	Length
25-5014PK	25-501A403	Small	2"
25-5015PK	25-501A507	Medium	3"
25-5016PK	25-501A609	Large	3 ¹ / ₂ "



Cutimed® Off-Loader & Cutimed® Off-Loader Select

Total contact cast system

- 1st choice for wounds not showing significant healing at 4 weeks
- Cost effective
- Reduces inventory
- Complete treatment kit for diabetic foot ulcers
- Reduces shear and friction

Cutimed® Off-Loader Plaster and Synthetic Combination

REF No.	Description	Qty
7800900	Cutimed® Cavity	1 each
	2 x 2 in. Cotton Gauze	4 each
	4 in. Ortho-Flex® Elastic Plaster***	2 rolls
	4 in. Extra Fast Gypsona® S	3 rolls
	3 in. Delta-Lite® Conformable	1 rolls
	4 in. Delta-Lite® Conformable	2 rolls
	3 in. Delta Terry-Net™ Stockinette	1 each
	4 in. Specialist® 100 Cotton Cast Padding	2 rolls
	Delta Terry-Net™ Adhesive Felt	1 each
	Open Cell Foam	1 each

Cutimed® Off-Loader Select Synthetic

REF No.	Description	Qty
7800901	Cutimed® Cavity	1 each
	2 x 2 in. Cotton Gauze	4 each
	3 in. Delta-Lite® Conformable	2 rolls
	4 in. Delta-Lite® Conformable	3 rolls
	3 in. Delta Terry-Net™ Stockinette	1 each
	4 in. Specialist® 100 Cotton Cast Padding	2 each
	Delta Terry-Net™ Adhesive Felt	1 each
	Open Cell Foam	1 each

Canvas Rocker Bottom Cast Shoe (not included)

REF No.	Description	Qty
43-101408	Canvas Rocker Bottom Cast Shoe – Small	1 each
43-101505	Canvas Rocker Bottom Cast Shoe – Medium	1 each
43-101602	Canvas Rocker Bottom Cast Shoe – Large	1 each
43-101709	Canvas Rocker Bottom Cast Shoe – X-Large	1 each



Kit components



Cutimed® Cavity is a sterile dressing, made from hydrophilic absorbent polyurethane foam.



Delta Terry-Net™ C cotton stockinette has excellent absorption and conformability. It reduces the risk of bunching in the dorsum of the foot.



Delta Terry-Net™ adhesive felt padding for added protection of the bony prominences of the tibia and malleoli.



Specialist® 100 cotton cast padding is soft and made of 100% cotton. It has excellent absorption properties and low loft needed for a total contact cast.



Orthoflex® Elastic Plaster of Paris Bandage that is ideal for difficult casting applications as it conforms well to the body contours. Manufactured with Specialist plaster and an elastic gauze**.



Gypsona® S Plaster of Paris Bandages are made with a creamy plaster that results in a smoother cast, plastic core improves handling.



Delta-Lite® Conformable is a patented fiberglass cast tape that provides unsurpassed conformability, greatly reducing the need to tuck and fold during application.



Perforated open cell foam to protect the toes and allow more breathability than nonperforated foams.



Cotton gauze used between the toes to reduce the risk of skin maceration.

Coverlet®

Elastic Adhesive Dressings

Coverlet® Fabric Adhesive Bandages are made to absorb liquid fast - faster than any of the competitors tested. Featuring an extra-large wound pad capable of absorbing 10 times its own weight in water. The 360° adhesive surrounding the island pad helps seal the afflicted area, keeping the wounds clean and providing an environment conducive to healing.

Features & Benefits

- Available in 13 different shapes and sizes
- Perfect for use on knees, elbows, chins, noses and knuckles
- Elastic fabric moves with the curves and contours of skin and body
- 100% latex-free



Coverlet® Latex-Free Digits

Ref. No.	Dimensions		Qty	Case Qty
01306	2.125 in x 1.5 in		100 / box	12 boxes
01307	2 in x 2.5 in		50 / box	12 boxes

Coverlet® Latex-Free Four Wing

Ref. No.	Dimensions		Qty	Case Qty
00385	3 in x 3 in		50 / box	12 boxes

Coverlet® Latex-Free Cabinet

Ref. No.	Description
70550168	Coverlet® Filled - 18 drawers
70550167	Coverlet® Empty - 18 drawers

Coverlet® Latex-Free Strips

Ref. No.	Dimensions		Qty	Case Qty
00230	0.75 in x 3 in		100 / box	12 boxes
00231	1 in x 3 in		100 / box	12 boxes
76448000	1 in x 3 in		300 / box	6 boxes

Coverlet® Latex-Free Spots

Ref. No.	Dimensions		Qty	Case Qty
00301	0.875 in round		100 / box	12 boxes
00303	1.25 in oval		100 / box	12 boxes

Coverlet® Latex-Free Patches

Ref. No.	Dimensions		Qty	Case Qty
00330	1.5 in x 3 in		100 / box	12 boxes
00340000	2 in x 3 in		50 / box	12 boxes

Coverlet® Latex-Free Knuckle

Ref. No.	Dimensions		Qty	Case Qty
01390	1.5 in x 3 in		100 / box	12 boxes

Coverlet® Toe Shield (Contains Latex)

Ref. No.	Dimensions		Qty	Case Qty
00801	2.5 in x 1.375 in		100 / box	12 boxes

Coverlet® XLG Patch (Contains Latex)

Ref. No.	Dimensions		Qty	Case Qty
7801000	4 in x 2.75 in		50 / box	12 boxes

Coverlet®

Eye Oclusors

The Coverlet® is a comfortable solution for the treatment of lazy eye. This bandage is composed of an inlay wound pad that forms a complete cover over the eye.

Features & Benefits

- Non-irritating adhesive for easy removal
- Complete coverage of the eye
- Elastic & comfortable



Coverlet® Eye Oclusors

Ref. No.	Color	Dimensions
46429	Beige	1.8" x 2.5" Jr
46430	Beige	2" x 3" Reg

Qty	Case Qty
20 / box	12 boxes
20 / box	12 boxes

Caution: This product contains latex rubber which may cause an allergic reaction

SplashCap®

Wound Irrigation Shield

SplashCap® is a twist-on wound irrigation shield that allows a clinician to deliver hundreds of milliliters of irrigation fluid directly to a wound in seconds.

Features & Benefits

- **Faster Wound Irrigation:** Improved productivity and faster turnaround times.
- **Built-in Nozzle:** Avoids the risk of needle sticks from poking holes in bottles.
- **Built-in Shield:** Reduces splattering when using bottle caps without shields.
- **Proven Pressure (PSI):** 4-15 PSI.
- **Universal Fitting:** Fits all major standard saline bottles.
- **Better Wound Care:** Standardize wound irrigation procedures in your department.
- **High Volume:** Deliver over 250 ml of irrigation fluid in seconds.
- **Kid Friendly:** No scary syringes.



SplashCap® Wound Irrigation Shield

Ref. No.	Qty
7446800	25 / case
7446801	100 / case

AbscessCap™

Abscess & Deep Wound Irrigation Shield

AbscessCap™ is a twist on abscess irrigation shield that allows a clinician to easily irrigate wounds below the surface of the skin.

Features & Benefits

- **Protruding Nozzle** - allows penetration below the surface
 - one-handed probing
 - break up loculations
 - irrigate tunneling wounds
- Fits any standard saline bottle - delivers high volumes in a shorter amount of time
- Fits any standard syringe - versatility between preferred irrigation methods
- **Built In Splash Shield** - permits safe visualization of wound target while reducing splatter
- **Large Nozzle Opening** - creates a low pressure stream of fluid to safely flush the wound of pus and debris

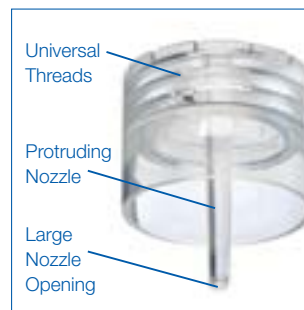

AbscessCap® Abscess & Deep Wound Irrigation Shield

Ref. No.	Qty
7446806	50 / case

EyeCap™

Eye Irrigation Shield

EyeCap™ is a twist-on eye irrigation shield that allows fast and easy eye irrigation. Use EyeCap™ for immediate eye irrigation at triage, by EMS or for occupational splash injuries. EyeCap™ can serve as a bridge to other irrigation methods that take longer to set up and are difficult for most patients to tolerate.

Features & Benefits

- **Faster Wound Irrigation:** Improved productivity and faster turnaround times.
- **Built-in Nozzle:** Avoids the risk of needle sticks from poking holes in bottles.
- **Built-in Shield:** Reduces splattering when using bottle caps without shields.
- **Proven Pressure (PSI):** 4-15 PSI.
- **Universal Fitting:** Fits all major standard saline bottles.
- **Better Wound Care:** Standardize wound irrigation procedures in your department.
- **High Volume:** Deliver over 250 ml of irrigation fluid in seconds.
- **Kid Friendly:** No scary syringes.

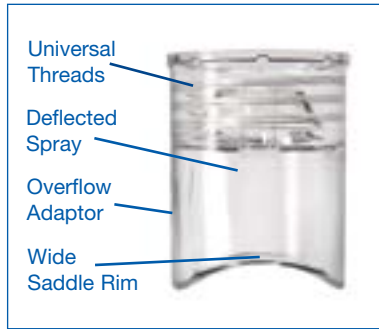

EyeCap® Eye Irrigation Shield

Ref. No.	Qty
7446802	25 / case

EarCap™

Ear Irrigation Shield

The product has a built-in reservoir for high volume irrigation, and built-in catch basin to keep the mess under control and to “see what you get” to measure success.

Features & Benefits

- Easy to use
- Extremely cost effective
- No splatter, irrigation fluid contained in built-in catch basin
- Fits a standard saline bottle for hi-volume irrigation

EarCap™ Ear Irrigation Shield

Ref. No.	Qty
7446810	30 / case



Training & Education

In addition to the highest quality products and service, BSN medical has an ongoing commitment to ensure a comprehensive range of training and education options based on customer needs. Our programs are designed to optimize educational support so that resources supporting our products are equipped with the latest clinical techniques and cost-effective use. Training is offered in a variety of forms including hands-on workshops, skill labs, manuals, and videos.

Please contact Customer Service or your local BSN medical Sales Rep for more information.

BSN medical, Inc.

Toll-Free: (800) 552 1157

Fax: (704) 358 4558

Email: BSN.Orders@BSNmedical.com

Earn & Learns

BSN medical offers hands-on Splinting and Casting learning centers across the US.

- **Basic Splinting & Casting Applications**
- **Advanced Basic Splinting & Casting Applications**
- **Functional Cast Therapy (FCT) Applications**
- **Water Resistant Applications**
- **Total Contact Casting Applications**
- **Diabetic Foot Ulcers – Hands-On**
— Cutimed® Off-Loader (Total Contact Casting)

For more Fracture Management training visit us at our YouTube channel*:

www.youtube.com/user/BSNmedicalWorldwide/videos



Fracture
Management



Applications for:

- **Plaster of Paris**
- **Delta-Cast Soft®**
- **Cast Removal**
- **Splint Applications**
- **Delta-Xpress™**
- **Delta-Dry®**
- **Cast Applications**

*Most videos available in English, Spanish, French and German.

For more Orthopedic Soft Goods training visit us at our website:

www.flaorthopedics.com



Orthopedic
Soft
Goods

CONTACT INFORMATION

To Find a Sales Representative in Your Area, Please Contact Customer Service:

Contact Information

Phone: 800-552-1157

Fax: 704-358-4558

e-mail: bsnorders@bsnmedical.com

Customer Service Hours

Monday–Friday

8:00am–6:00pm ET

Available On-Line 24 hours per day, 365 Days per Year

Standard Products: www.bsncshop.com/us

Custom Products: www.jobstcustom.com/us

Our goal is to provide you with fast and efficient service. To help us, please have your customer account number ready when placing your order(s). If you are unable to locate your account number, one of our Customer Service Representatives will assist you.

Please refer to the product label and/or package insert for full instructions on the safe use of these products.

BSN medical Inc. 5825 Carnegie Blvd. Charlotte, NC 28209-4633
Tel. (+1) 704 554 9933 Fax (+1) 704 358 4558 www.bsnmedical.com
To order toll-free: BSN medical (+1) 800 552 1157

61861 RN © 2015 BSN medical Inc. REV 07/15

