

RTL10261 & RTL10261BC (5W-2M-15J SERIAL #)

5W & 15J Serial #

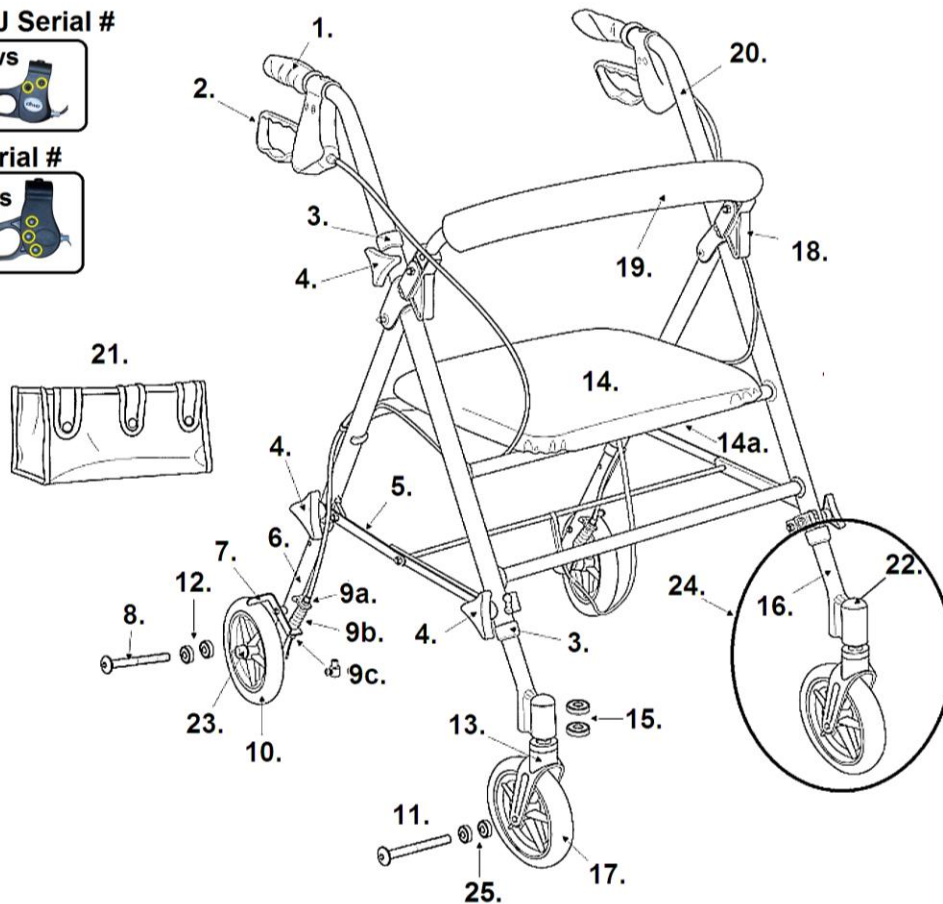

2M Serial #



- | | |
|--|--|
| 1. Left Handgrip- 950340089901 Right Handgrip- 950340079901 | Push Pin (4 each)- 9505W1026123 End Plug (4 each)- 9505W1026122 |
| 2. Hand Brake & Cable 5W-15J S/N- 9505W1026101 Hand Brake & Cable 2M Serial #- 10216-01 [4] | 17. Caster 5W Serial #- 9505W1026112 Caster 15J Serial #- 9515J1026112 Caster 2M Serial #- [3] |
| 3. Anti-Rattler (pr)- 950300169901 | 18. Backrest Brkt. 5W-15J Serial #- 9505W1026121 Backrest Pivot Brkt. 2M Serial #- 9501S72603 |
| 4. Height Adj. Knob (pr)- 9505W1026102 | 19. Backrest- 9505W1026117 |
| 5. Folding Hinge Assy.- 9505W1026105 | 20. Left Handlebar- 9505W1026118 Right Handlebar- 9505W1026119 |
| 6. Rear Leg & Axle Sleeve Left - 9505W1026107 Rear Leg & Axle Sleeve Right - 9505W1026106 | 21. Tote- 9505W1026120 |
| 7. Wheel Lock Left- 9505W1026109 Wheel Lock Right- 9505W1026108 | 22. Dust Cap- STDS1051 |
| 8. Rear Axle- 9505W1026111 | 23. Axle Cap- STDS001000 |
| 9b. Spring- [3] | 24. Front Leg Assembly Left- 9505W1026124 Front Leg Assembly Right- 9505W1026125 |
| 9c. Cable Fastener- 9500004101 | 25. Caster Bearing 5W-2M Serial #- STDS1011 Caster Bearing 15J Serial #- 1992M-19 |
| 10. Rear Wheel 5W-15J Serial #- 9505W1026110 Rear Wheel 2M Serial # [3] | |
| 11. Caster Axle- 9505W1026113 | |
| 12. Rear Wheel Bearing- STDS1011 | |
| 14. Seat with Brackets 5W-2M S/N- 9505W1026103 Seat with Brackets 15J S/N- 9515J1026103 [2] | |
| 14a. Seat Hinge Brackets (pr)- 9505W1026104 | |
| 15. Fork Stem Bearing- STDS1060 | |
| 16. Left Front Leg Tube Only [1] - 9505W1026115 Right Front Leg Tube only [1] - [3] | |

[1] Does not include push pin or end plug.

[2] 15J Serial # Does not have seat pouch.

[3] The part is no longer available.

[4] When stock is gone the part is no longer Available.